

**APPROXIMATE
SITE LOCATION**

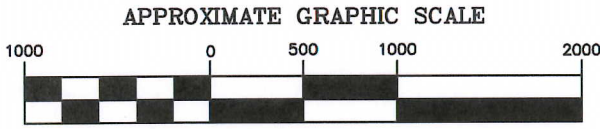

(IN FEET)
1 inch = 1000 ft.



SITE LOCATION MAP		
FORMER STUDEBAKER FOUNDRY 1100 PRAIRIE AVENUE SOUTH BEND, IN		
Weaver Boos Consultants 4085 MEGHAN BEELER COURT SOUTH BEND, IN 46628 (574) 271-3447		
DRAWN BY: RMD	DATE: 1/11/2010	FILE: 0058-373-01
REVIEWED BY: ES	CAD: SITELOC.DWG	FIGURE 1

APPROXIMATE GRAPHIC SCALE

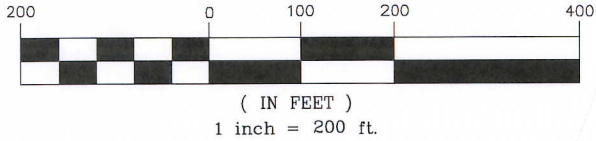

NOTE
 THIS SITE MAP WAS CREATED FROM DRAWINGS PROVIDED BY C. RIGHTLEY, C.A. McCARRISON (DRAWING #56652, 6/48), THE SIDWELL COMPANY, AND HULL & ASSOC., INC. ALL INFORMATION REPRESENTED ON THIS DRAWING IS APPROXIMATE AND SHOULD BE USED FOR GENERAL PURPOSES ONLY.

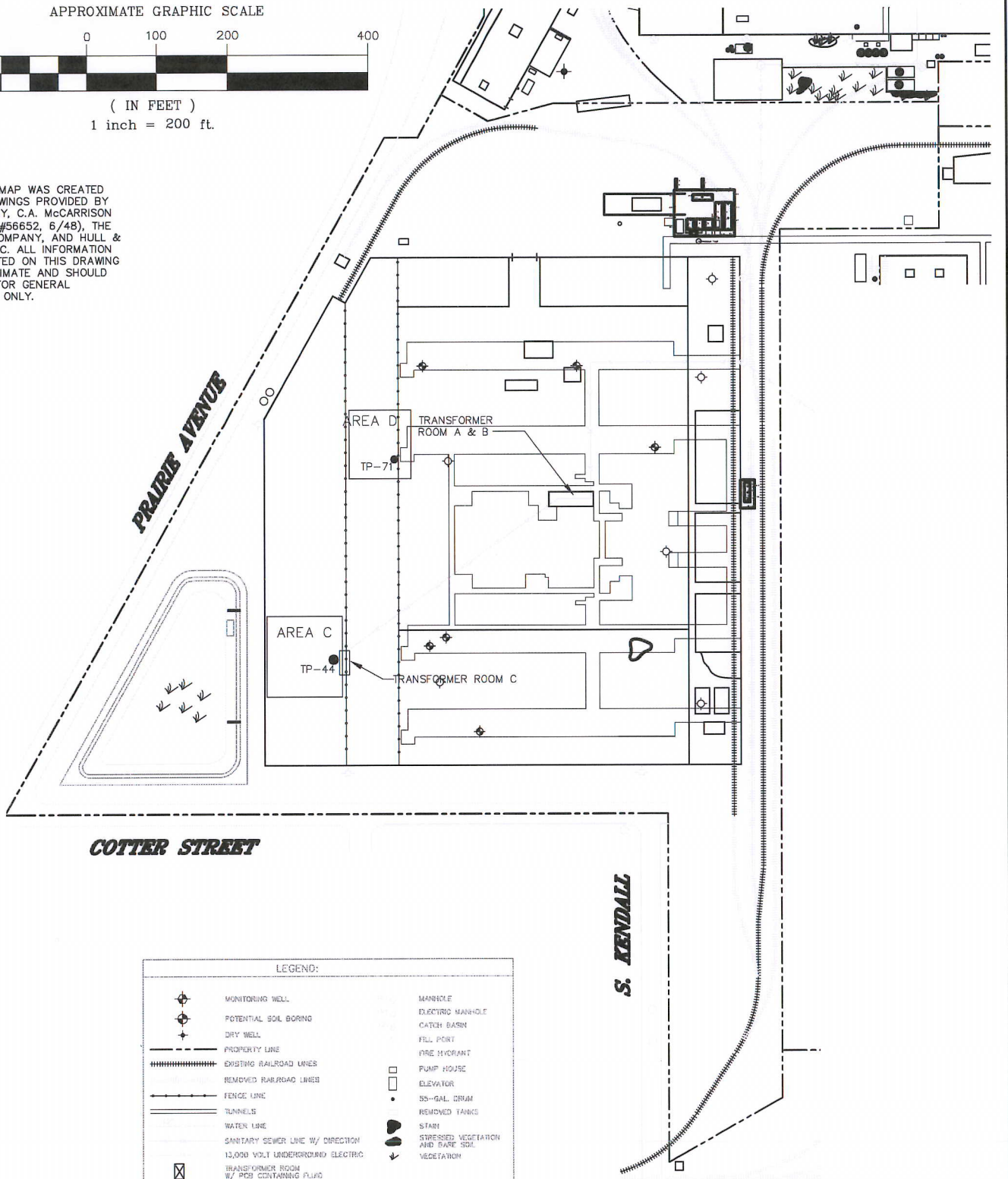

LEGEND:	
	MONITORING WELL
	POTENTIAL SOIL BORING
	DRY WELL
	PROPERTY LINE
	EXISTING RAILROAD LINES
	REMOVED RAILROAD LINES
	FENCE LINE
	TUNNELS
	WATER LINE
	SANITARY SEWER LINE W/ DIRECTION
	13,000 VOLT UNDERGROUND ELECTRIC
	TRANSFORMER ROOM W/ PCB CONTAINING FLUID
	MANHOLE
	ELECTRIC MANHOLE
	CATCH BASIN
	FILL POINT
	FIRE HYDRANT
	PUMP HOUSE
	ELEVATOR
	SS-GAL DRUM
	REMOVED TANKS
	STARN
	STRESSED VEGETATION AND BARE SOIL
	VEGETATION

SITE LAYOUT

FORMER STUDEBAKER FOUNDRY
 1100 PRAIRIE AVENUE
 SOUTH BEND, IN

Weaver Boos Consultants

4085 MEGHAN BEELER COURT
 SOUTH BEND, IN 46628
 (574) 271-3447

DRAWN BY: RMD	DATE: 10/17/11	FILE: 0058-373-01
REVIEWED BY: ES	CAD: FIGS.DWG	FIGURE 2

SOURCE NOTE: FIGURE 2 FROM PHASE II ENVIRONMENTAL REPORT DATED 2002 BY HULL & ASSOC.

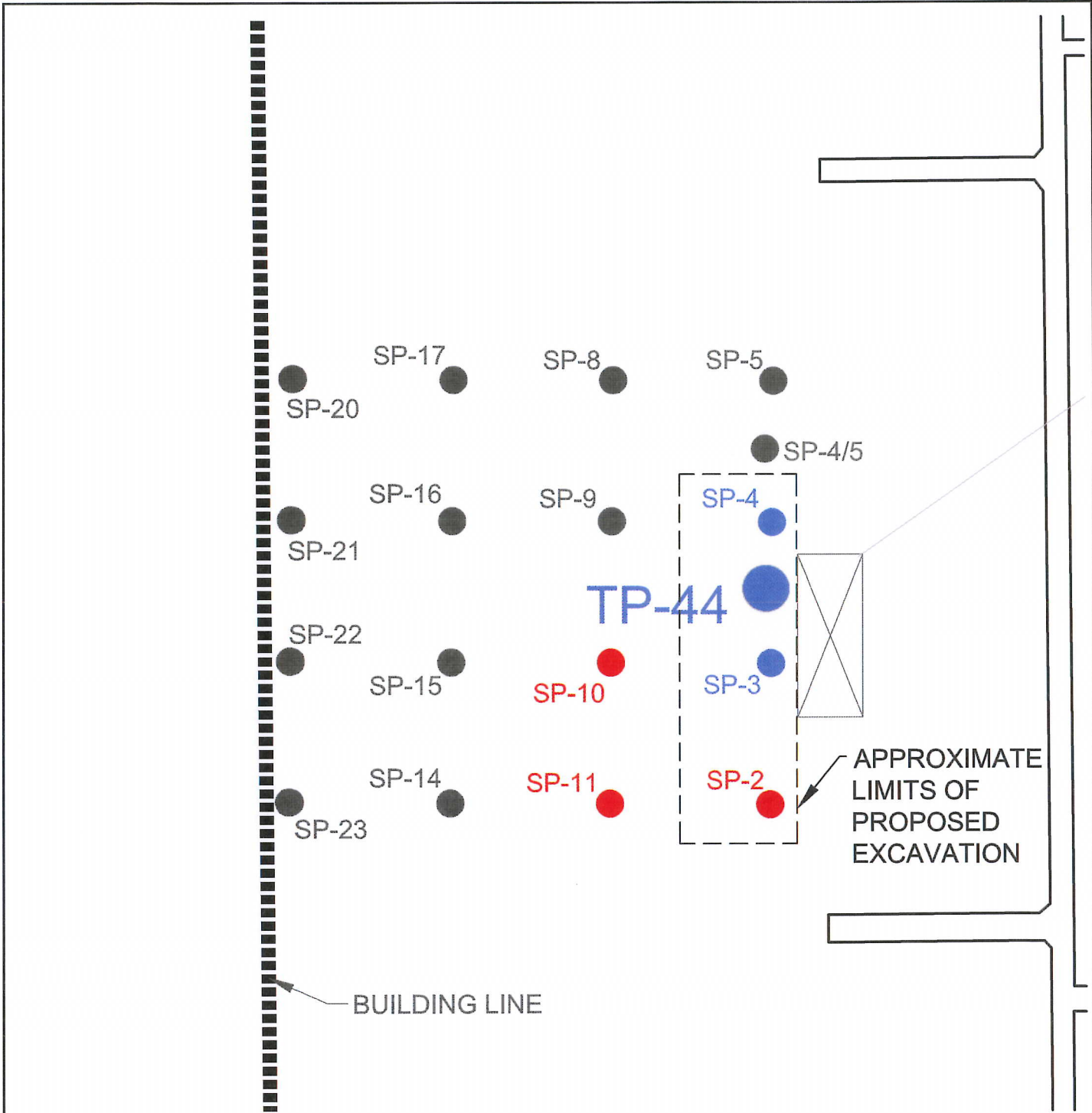

LEGEND:

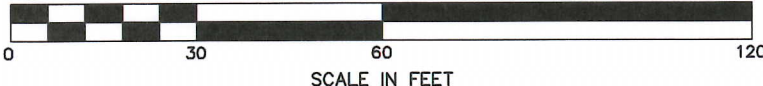

- TP-71
 - SP-4
 - DENOTES PCB CONCENTRATIONS > 50PPM
 - DENOTES PCB CONCENTRATIONS > 1PPM BUT ≤ 50PPM
- SAMPLE LOCATIONS

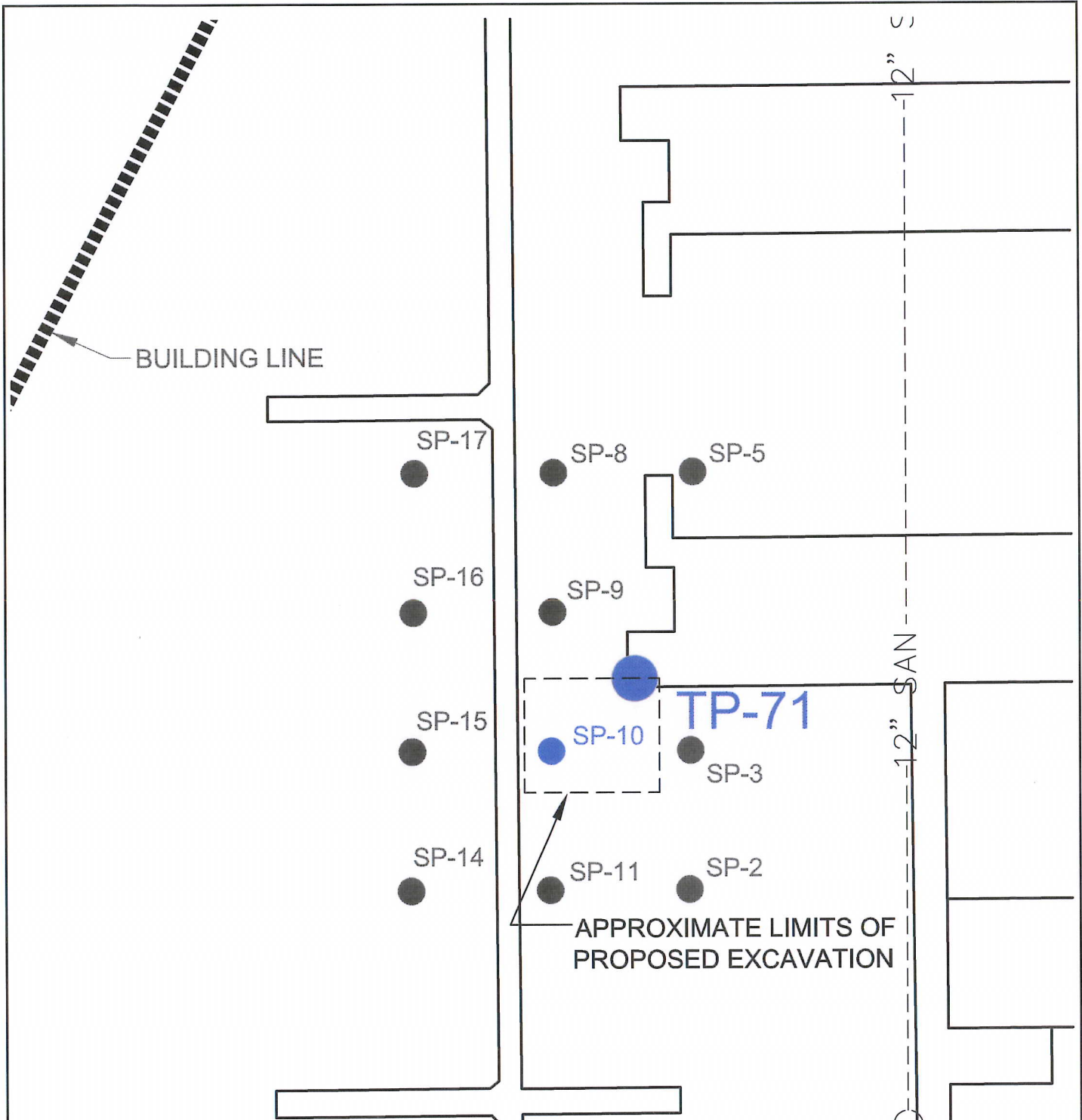

SAMPLE PIT LOCATION MAP AREA C FORMER STUDEBAKER FOUNDRY 1100 PRAIRIE AVENUE SOUTH BEND, IN		
Weaver Boos Consultants <small>4085 MEGHAN BEELER COURT SOUTH BEND, IN 46628 (574) 271-3447</small>		
DRAWN BY: RMD REVIEWED BY: ES	DATE: 10/17/2011 CAD: SITELOC.DWG	FILE: 0058-373-01 FIGURE 3



LEGEND:

-  TP-71
 -  SP-4
 -  DENOTES PCB CONCENTRATIONS > 50PPM
- SAMPLE LOCATIONS

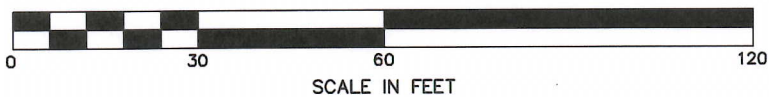

<p>SAMPLE PIT LOCATION MAP AREA D FORMER STUDEBAKER FOUNDRY 1100 PRAIRIE AVENUE SOUTH BEND, IN</p>		
<p>Weaver Boos Consultants 4085 MEGHAN BEELER COURT SOUTH BEND, IN 46628 (574) 271-3447</p>		
DRAWN BY: RMD	DATE: 10/17/2011	FILE: 0058-373-01
REVIEWED BY: ES	CAD: SITELOC.DWG	FIGURE 4

Table 1
PCB Soil Concentrations
Areas 1 and 2
Former Studebaker Foundry Demolition
South Bend, Indiana

Sample ID	Concentration (mg/kg)	1996 VRP TIER II NONRESIDENTIAL CLEAN UP GOALS		CURRENT RISC INDUSTRIAL DEFAULT CLEANUP GOALS Soil (mg/kg)	40 CFR PART 761.61 CLEANUP LEVELS (LOW OCCUPANCY AREAS)
		Surface Soil (mg/kg)	Subsurface Soils (mg/kg)		
AREA C					
TP-44 (0-2)	80	4.23	7.53	5.3	<25
TP-44 (4-5)	37	4.23	7.53	5.3	<25
SP-17 (0-2) and (4-5)	ND	4.23	7.53	5.3	<25
SP-16 (0-2), (4-5), and (7-8)	ND	4.23	7.53	5.3	<25
SP-9 (0-2)	0.065	4.23	7.53	5.3	<25
SP-9 (4-5)	0.067	4.23	7.53	5.3	<25
SP-9 (7-8)	ND	4.23	7.53	5.3	<25
SP-4 (0-2)	9000	4.23	7.53	5.3	<25
SP-4 (4-5)	53	4.23	7.53	5.3	<25
SP-4 (7-8)	14	4.23	7.53	5.3	<25
SP-2 (0-2)	17	4.23	7.53	5.3	<25
SP-11 (0-2)	3.6	4.23	7.53	5.3	<25
SP-14 (0-2)	0.047	4.23	7.53	5.3	<25
SP-23 (0-2)	ND	4.23	7.53	5.3	<25
SP-22 (0-2)	ND	4.23	7.53	5.3	<25
SP-21 (0-2)	0.16	4.23	7.53	5.3	<25
SP-20 (0-2)	0.11	4.23	7.53	5.3	<25
SP-5 (0-2)	1	4.23	7.53	5.3	<25
SP-5 (4-5)	ND	4.23	7.53	5.3	<25
SP-8 (0-2)	0.72	4.23	7.53	5.3	<25
SP-8 (4-5)	ND	4.23	7.53	5.3	<25
SP-4/5 (0-2)	0.4	4.23	7.53	5.3	<25
SP-3 (0-2)	330	4.23	7.53	5.3	<25
SP-3 (4-5)	ND	4.23	7.53	5.3	<25
SP-3 (7-8)	0.091	4.23	7.53	5.3	<25
SP-10 (0-2)	1.4	4.23	7.53	5.3	<25
SP-10 (4-5) AND (7-9)	ND	4.23	7.53	5.3	<25
SP-15 (0-2)	0.23	4.23	7.53	5.3	<25
SP-15(4-5) AND (7-8)	ND	4.23	7.53	5.3	<25
AREA D					
TP-71 (0-2)	1100	4.23	7.53	5.3	<25
TP-71 (4-5)	7.5	4.23	7.53	5.3	<25
SP-271 (0-2) SP-3 ON FIG	0.08	4.23	7.53	5.3	<25
SP-271 (4-5)	ND	4.23	7.53	5.3	<25
SP-1171 (0-2) (4-5) SP-11 ON FIG	ND	4.23	7.53	5.3	<25
SP-1471 (0-2) (4-5) SP-14 ON FIG	ND	4.23	7.53	5.3	<25
SP-1571 (0-2) (4-5) SP-15 ON FIG	ND	4.23	7.53	5.3	<25
SP-1671 (0-2)(4-5) SP-16 ON FIG	ND	4.23	7.53	5.3	<25
SP-1717 (0-2) SP-17 ON FIG	ND	4.23	7.53	5.3	<25
SP-1771 (4-5)	ND	4.23	7.53	5.3	<25
SP-371 (0-2) SP-3 ON FIG	0.48	4.23	7.53	5.3	<25
SP-371 (4-5) (7-8)	ND	4.23	7.53	5.3	<25
SP-871 (0-2) (4-5) SP-8 ON FIG	ND	4.23	7.53	5.3	<25
SI-971 (0-2) SP-9 ON FIG	0.094	4.23	7.53	5.3	<25
SI-971 (4-5) (7-8)	ND	4.23	7.53	5.3	<25
SP-1071 (0-2) SP-10 ON FIG	230	4.23	7.53	5.3	<25
SP-1071 (4-5)	0.73	4.23	7.53	5.3	<25
SP-1071 (7-9)	ND	4.23	7.53	5.3	<25

40 CFR Part 761.61 cleanup level in high occupancy areas is ≤ 1 ppm

The current RISC residential default cleanup goal is 1.8 ppm

PCB Soil Concentrations ≥ 50 ppm shall be disposed in a hazardous waste disposal facility or state-approved PCB disposal facility.

PCB Soil Concentration > 7.53 ppm (> 2ft depth) or ≥ 4.23 ppm (≤ 2 ft depth) and < 50 ppm shall be disposed in a non-hazardous waste disposal facility upon approval from facility.