

Hull & associates, inc.

4900 Parkway Drive, Suite 100 • Mason, Ohio 45040 • (513) 459-9677 • (513) 459-9869 fax

FACSIMILE COVER SHEET

TO: Terry B. FIRM: _____

FAX NO: Toledo HULL PROJECT CODE: _____

DATE 8-25-02 TIME: _____

RE: _____

Number of Pages (Including Cover Sheet) 11

THESE ARE TRANSMITTED:

- For Your Use
- As Requested
- For Approval
- For Review & Comment
- For Your Information

The original of this facsimile will will not be sent to the recipient.

Notes: _____

Copy To: _____ Sent By: Kristie Fox

_____ Sent For: Lance Turkey

If you have difficulty receiving this facsimile, please call (513) 459-9677 as soon as possible.



CAUTION

The information contained in this facsimile message is confidential and is intended solely for the use of the recipient named above. If the reader of this message is not the intended recipient, or the employee or agent responsible for delivering it to the intended recipient, you are hereby notified that any dissemination, distribution, or unauthorized use of this message is strictly prohibited. If you have received this message in error, please notify the sender by telephone and return the original facsimile to the sender at the above address via the United States Postal Service.

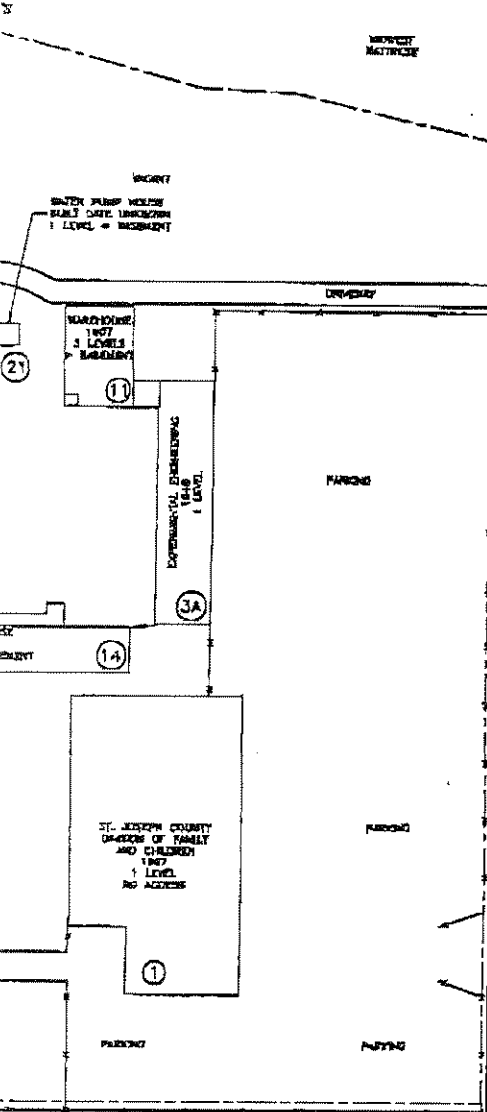
OLIVER CITY PARK



LEGEND

-  SUBJECT PROPERTY BOUNDARY
-  FENCE
-  BUILDING IDENTIFICATION NUMBER

THIS LOT IS NOT TO BE USED FOR ANY OTHER PURPOSE THAN AS SHOWN
 (UNLESS OTHERWISE NOTED)

THIS LOT IS NOT TO BE USED FOR ANY OTHER PURPOSE THAN AS SHOWN

THIS LOT IS NOT TO BE USED FOR ANY OTHER PURPOSE THAN AS SHOWN

ANY TRUCKING TERMINAL
 ALSO SHOWN AS
 CENTRAL TRANSPORT
 (NOT SHOWN)



ENVROCORP		HOUSTON, TX. SOUTH BEND, IN. BATON ROUGE, LA.
FIGURE-2 OLIVER PLOW WORKS (VACANT) 533 SOUTH CHAPIN STREET SOUTH BEND, INDIANA SITE DIAGRAM BASEMAP		
DATE: 10/13/97	CHECKED BY: <i>[Signature]</i>	JOB NO: 5024411
DRAWN BY: EPH	APPROVED BY: <i>[Signature]</i>	DWG. NO:

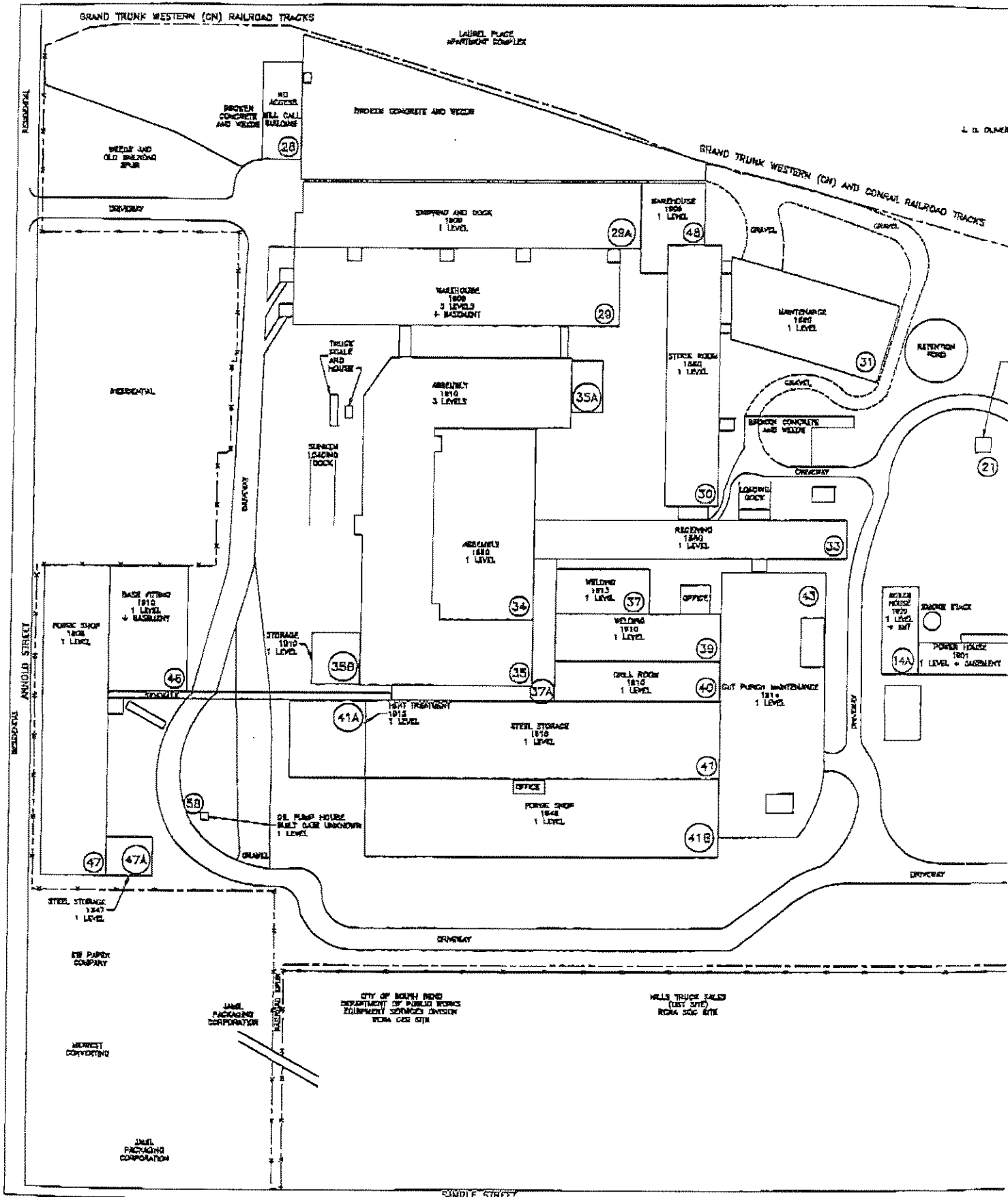

J. C. OLIVER CITY PARK

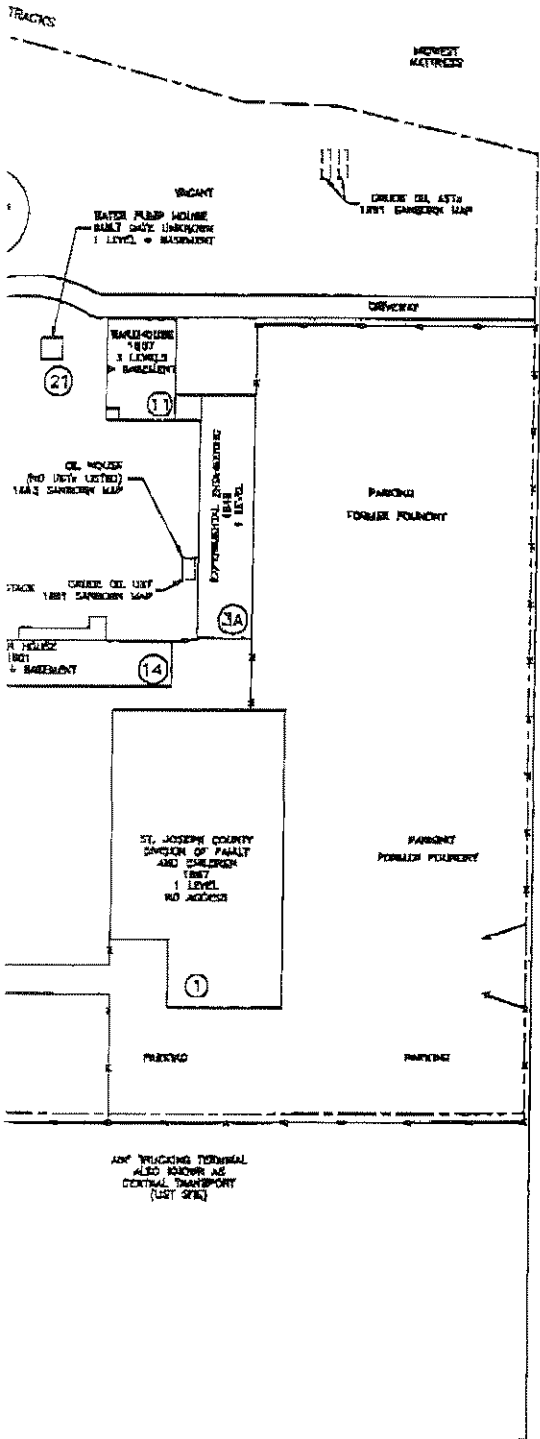

LEGEND

- SUBJECT PROPERTY BOUNDARY
- FENCE
- (21) BUILDING IDENTIFICATION NUMBER

(SEE LIST) BOUNDARY OF
 (SEE LIST) BOUNDARY OF
 (SEE LIST) BOUNDARY OF
 (SEE LIST) BOUNDARY OF



ENVIROCORP		HOUSTON, TX.
ENVIROCORP SERVICES & TECHNOLOGY, INC.		SOUTH BEND, IN.
		BATON ROUGE, LA.
FIGURE 3		
OLIVER PLOW WORKS (VACANT)		
533 SOUTH CHAPIN STREET		
SOUTH BEND, INDIANA		
SANBORN FIRE INSURANCE MAP INFORMATION		
DATE: 10/13/97	CHECKED BY: <i>EPH</i>	JOB NO: 8024411
DRAWN BY: EPH	APPROVED BY: <i>RJH</i>	DWG. NO:

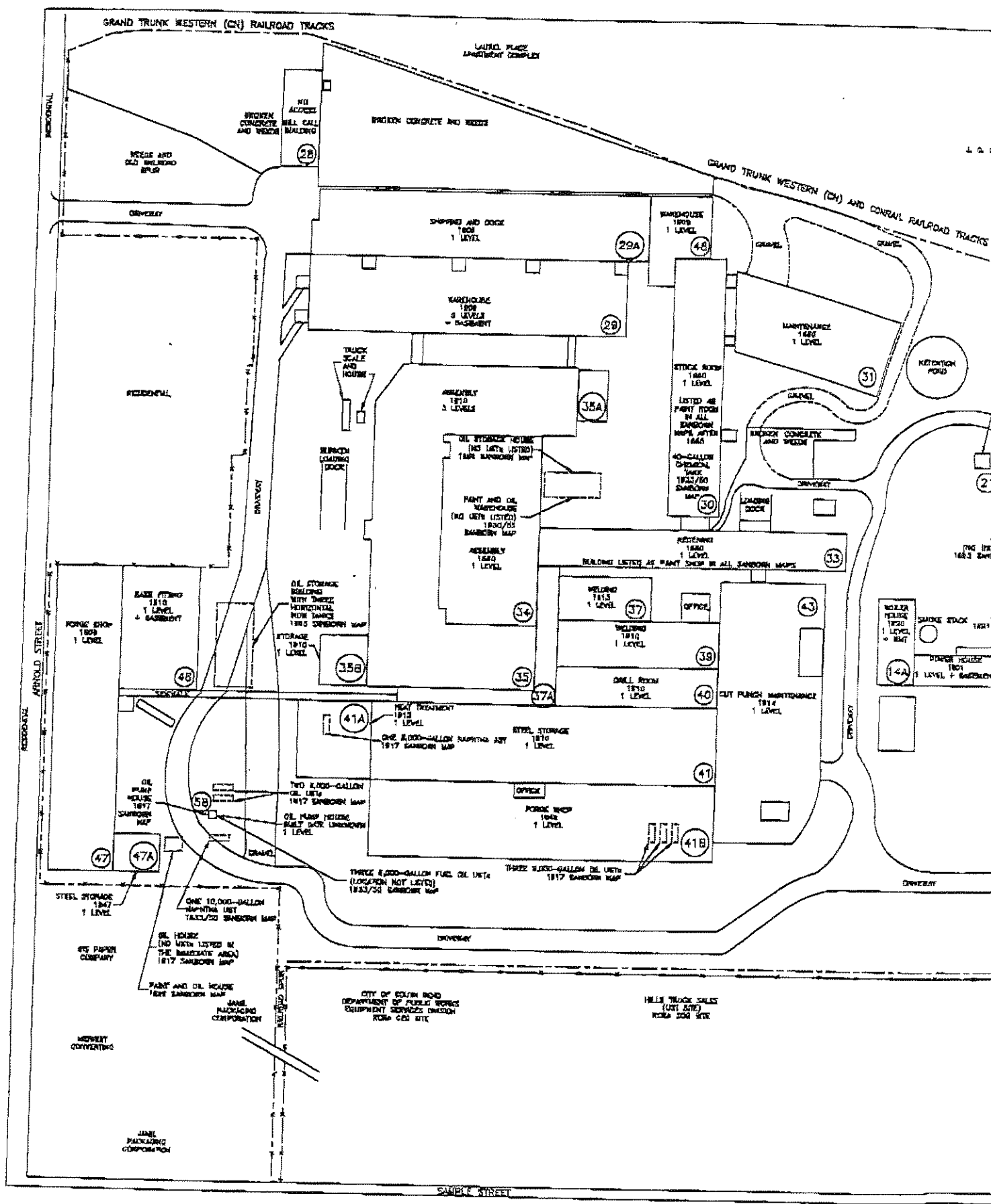

J. D. OLIVER CITY PARK

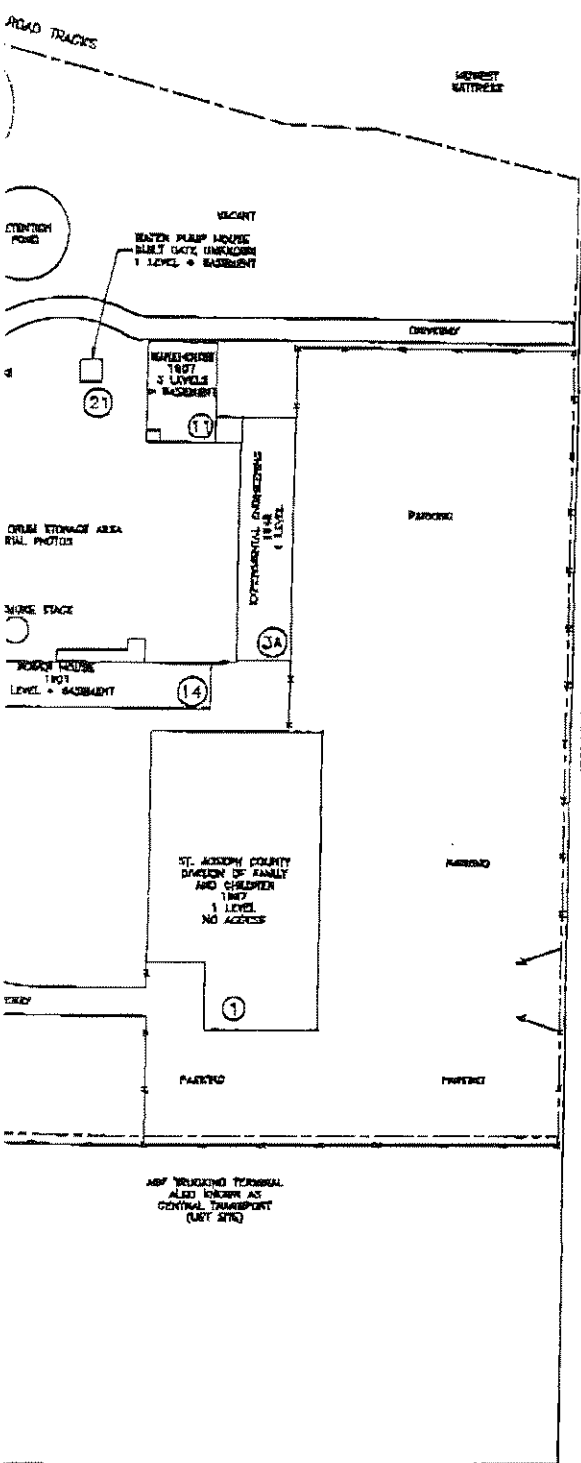

LEGEND

- SUBJECT PROPERTY BOUNDARY
- FENCE
- (21) BUILDING IDENTIFICATION NUMBER
- ▣ FORMER DRUM STORAGE AREA

CRIME DATA
SOUTH BEND POLICE
RECORDED 10/10

CRIME DATA
SOUTH BEND POLICE
RECORDED 10/10

CRIME DATA
SOUTH BEND POLICE
RECORDED 10/10



ENVIROCORP [®]		HOUSTON, TX.	
ENVIROCORP SERVICES & TECHNOLOGY, INC.		SOUTH BEND, IN.	
		BATON ROUGE, LA.	
FIGURE 4			
OLIVER PLOW WORKS (VACANT)			
533 SOUTH CHAPIN STREET			
SOUTH BEND, INDIANA			
AERIAL PHOTOGRAPH INFORMATION			
DATE: 10/13/97	CHECKED BY: <i>EPH</i>	JOB NO: 8024-111	
DRAWN BY: EPH	APPROVED BY: <i>EPH</i>	DWG. NO:	

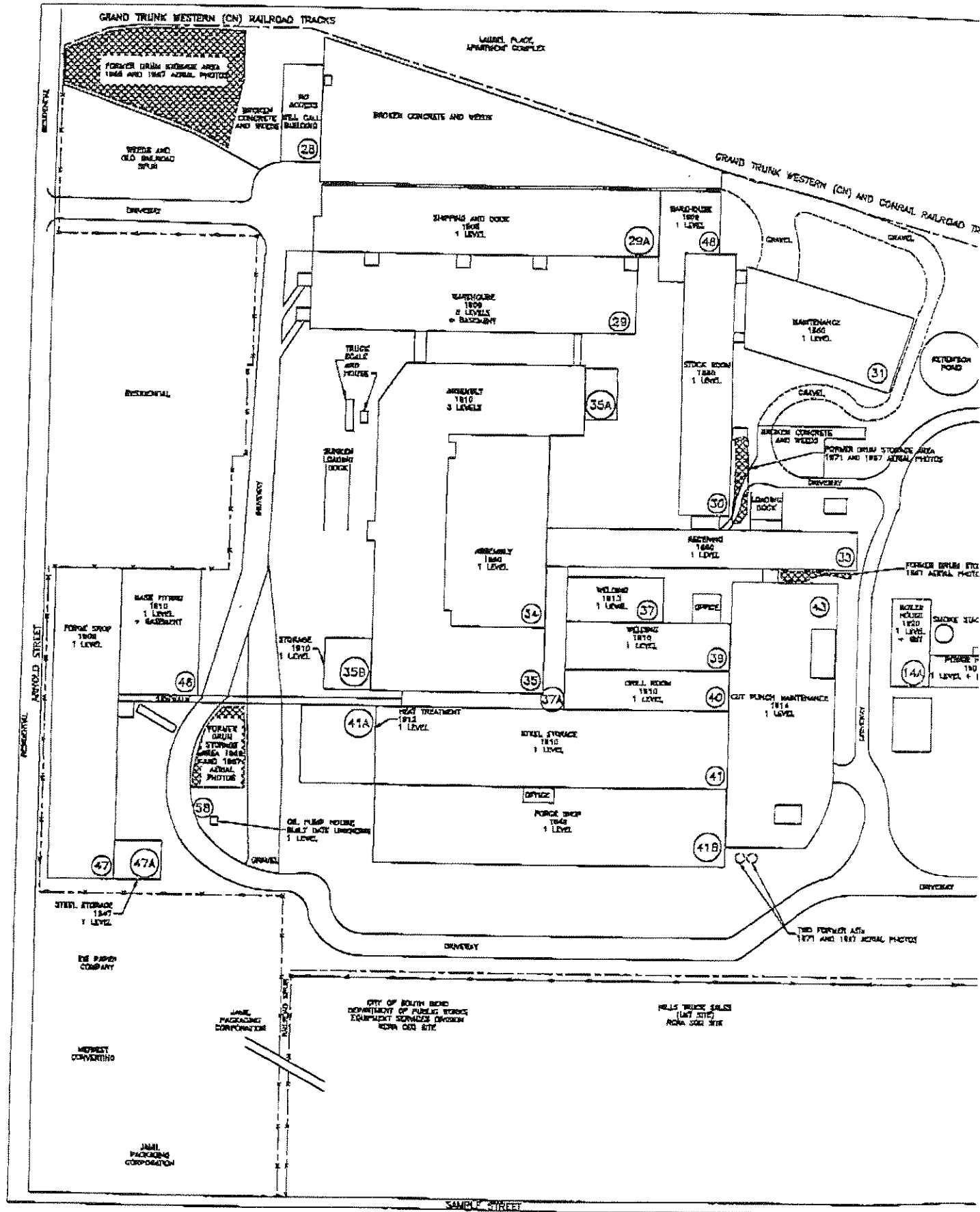

8-3 (23-25 FEET)
 CE = 0.010
 IC = 0.029
 CADMIUM = 0.56
 MAGNESIUM = 12,500

SB-4 (21-23 FEET)
 XYLENE = 0.12
 ETHYLBENZENE = 0.026
 TOLUENE = 0.025
 BENZENE = 0.007
 PCE = 0.008
 TCE = 0.008
 ACETONE = 0.11
 MC = 0.012
 NAPHTHALENE = 10
 2-NETHYL-NAPHTHALENE = 14

HA-1 (0.75 FEET)
 MC = 0.025
 PHENANTHRENE = 1.0
 FLUORANTHRENE = 1.3
 PYRENE = 3.8
 TPH = 6,450
 CADMIUM = 3.1

HA-2 (1.0 FEET)
 MC = 0.049
 CADMIUM = 2.0
 MERCURY = 0.65
 MAGNESIUM = 6,190
 MANGANESE = 3,400

HA-3 (0.75 FEET)
 TPH = 45.2

HA-4 (1.5 FEET)
 TPH = 168
 AROCLOR-1260 = 150

HA-5 (1.5 FEET)
 MC = 0.069
 PCE = 0.01

HA-6 (1.3 FEET)
 MC = 0.041
 ACETONE = 0.037
 2-BUTANONE = 0.01
 1,1,1-TCA = 0.027
 PCE = 0.012
 TOLUENE = 0.008
 AROCLOR-1260 = 0.040

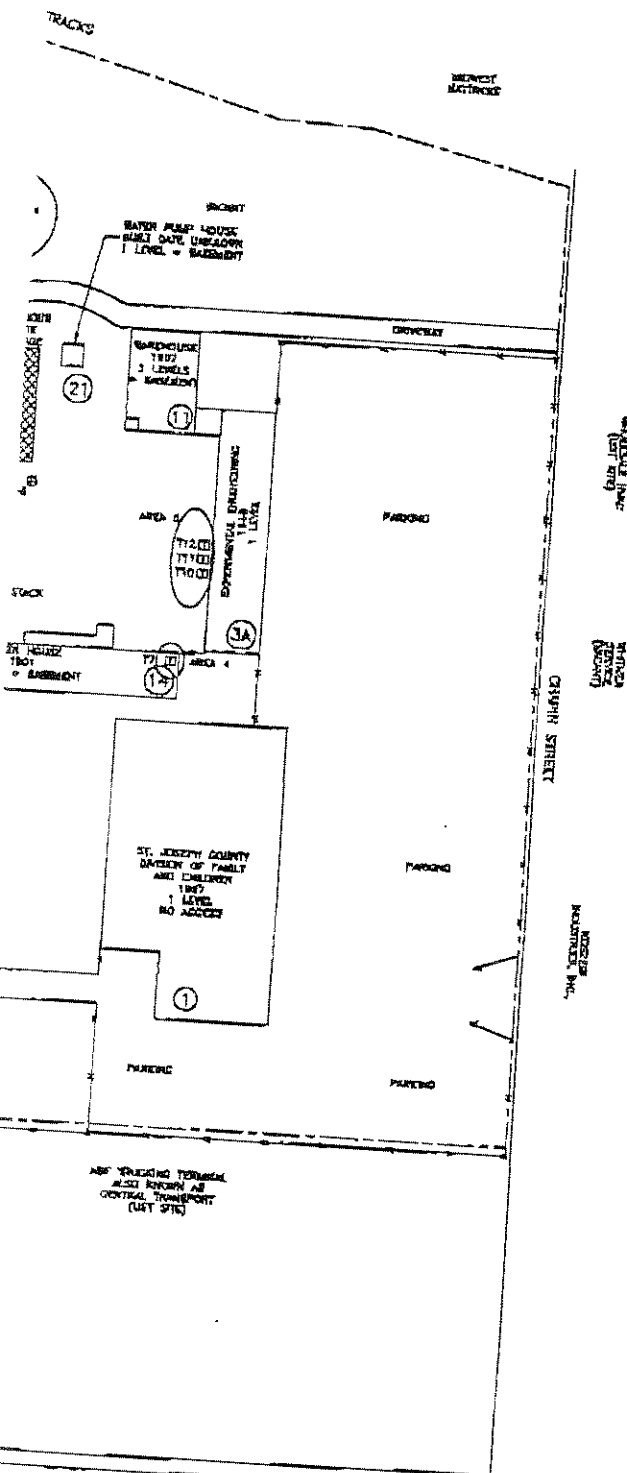

- LEGEND
- SUBJECT PROPERTY BOUNDARY
 - FENCE
 - (21) BUILDING IDENTIFICATION NUMBER
 - [Hatched Box] FORMER DRUM STORAGE AREA
 - ⊙ HOLLOW STEM AUGER DRILL RIG SOIL BORING (DEEP)
 - ⊙ HAND AUGER SOIL BORING (SHALLOW)
 - ⊙ TRANSFORMERS AND EXCAVATED AREA

ENVIROCORP
 ENVIRONMENTAL SERVICES & TECHNOLOGY, INC.
 HOUSTON, TX
 SOUTH BEND, IN.
 BATON ROUGE, LA.

FIGURE 5
OLIVER PLOW WORKS (VACANT)
 533 SOUTH CHAPIN STREET
 SOUTH BEND, INDIANA
 PREVIOUS INVESTIGATION INFORMATION

DATE: 10/13/97 | CHECKED BY: EPH | JOB NO: 8024411
 DRAWN BY: EPH | APPROVED BY: [Signature] | DWG. NO:

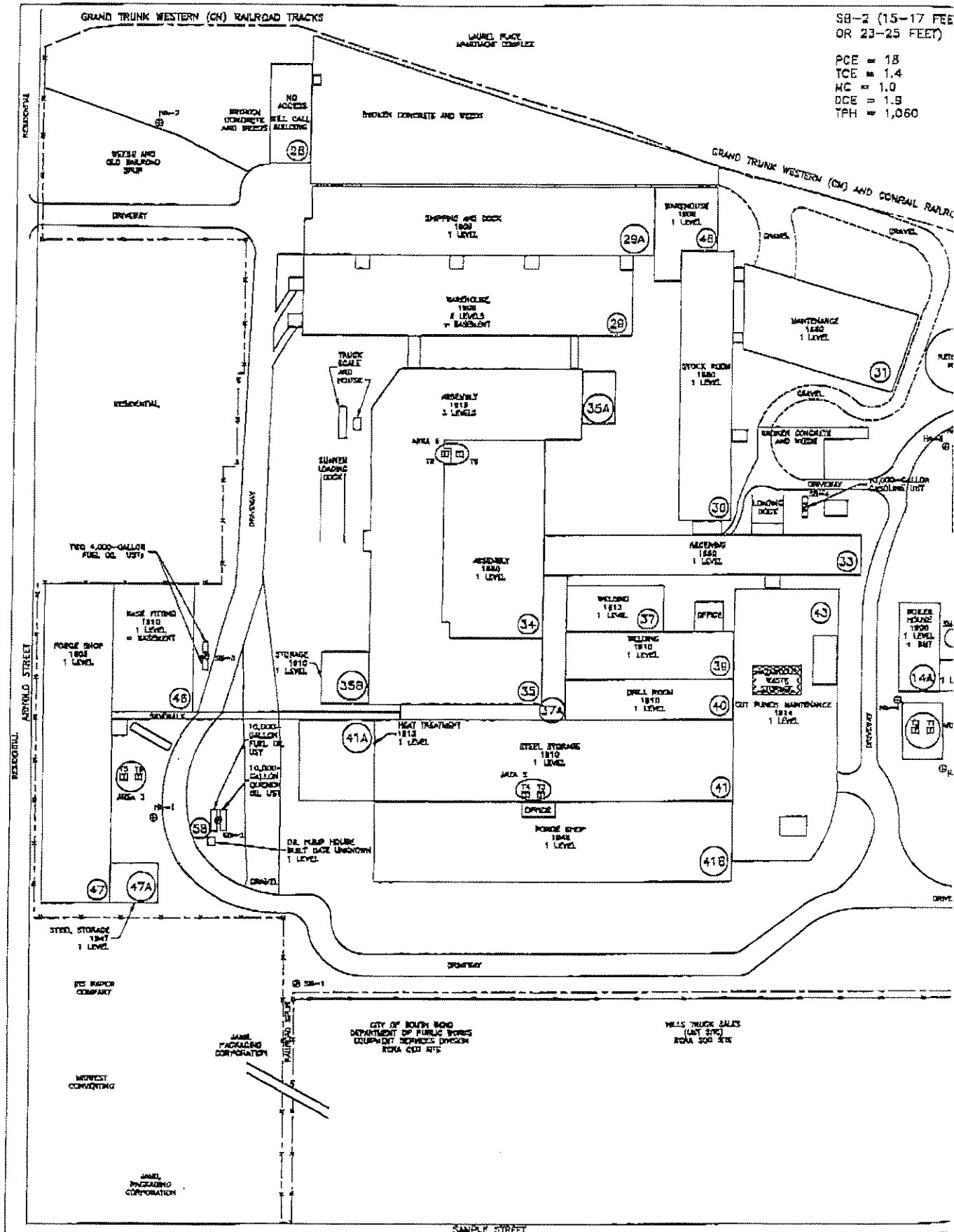

SB-2 (15-17 FEET
OR 23-25 FEET)

PCE = 18
TCE = 1.4
HC = 1.0
DCE = 1.9
TPH = 1,060

J. D. BLUMER CITY NAME

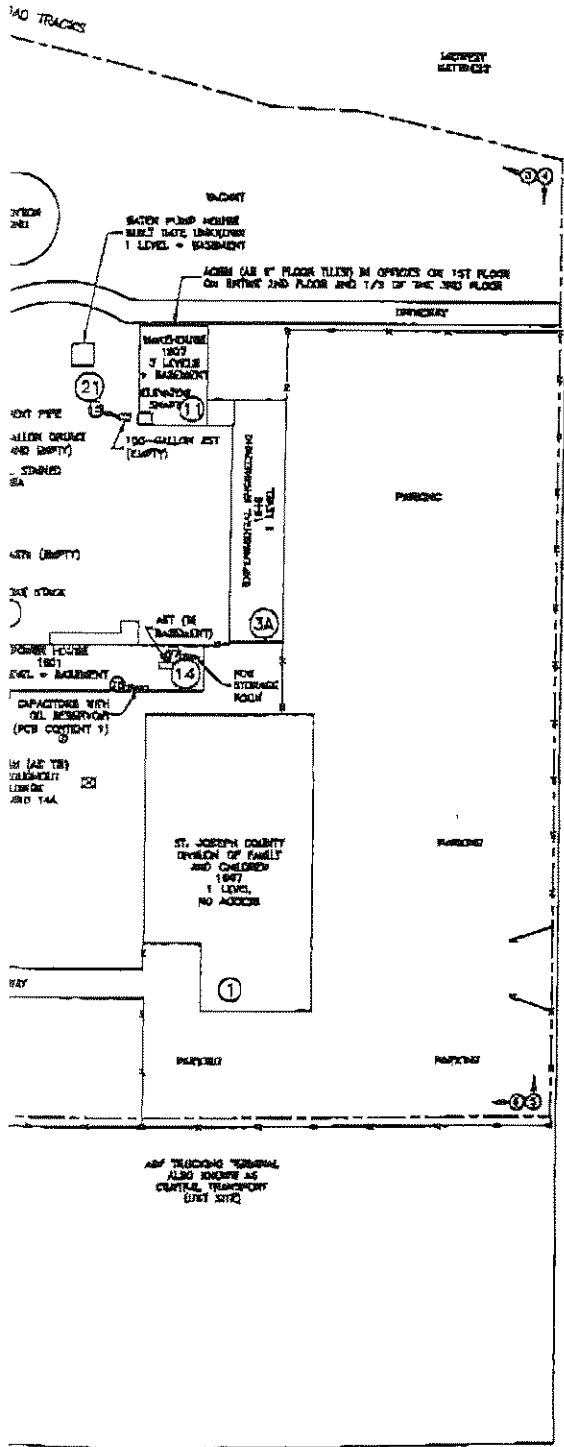

LEGEND

- SUBJECT PROPERTY BOUNDARY
- FENCE
- (21) BUILDING IDENTIFICATION NUMBER
- ⊙ PHOTO LOCATION
- ⊙ POLE MOUNTED TRANSFORMER
- ⊞ PAD MOUNTED TRANSFORMER
- ☒ DUMPSTER
- ||||| FLOOR DRAIN

ENVIROCORP
ENVIROTECH SERVICES & TECHNOLOGY, INC.

HOUSTON, TX.
 SOUTH BEND, IN.
 BATON ROUGE, LA.

FIGURE 6
OLIVER PLOW WORKS (VACANT)
 533 SOUTH CHAPIN STREET
 SOUTH BEND, INDIANA
 SITE WALKOVER INFORMATION

DATE: 10/13/97	CHECKED BY: <i>EPH</i>	JOB NO: B024411
DRAWN BY: EPH	APPROVED BY: <i>EPH</i>	DWG. NO:

