

Note:
 All sample locations are approximate

- ⊕ - Sample BLDG 85-SW
- ⊙ - Sample BLDG 85-SE
- ☆ - Sample BLDG 85-NE
- ⊗ - Sample BLDG 85-NW

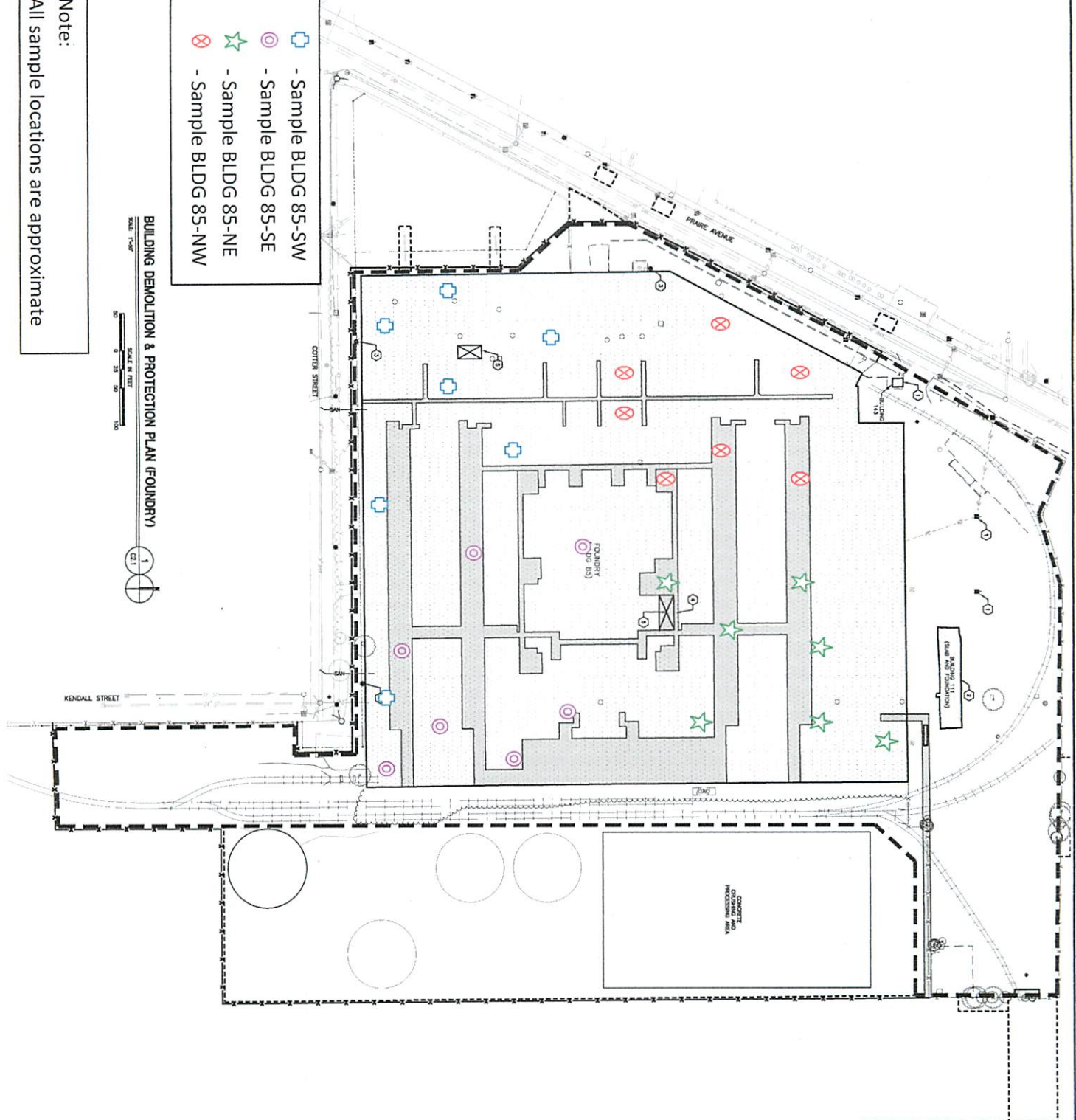

MATCHLINE - REFER TO DRAWING C2.0 FOR CONTINUATION

GENERAL NOTES

1. THE OWNER HAS BEEN ADVISED BY THE CONTRACTOR'S GENERAL CONTRACTOR TO TAKE THE NECESSARY PRELIMINARY STEPS TO OBTAIN THE NECESSARY PERMITS AND APPROVALS FOR THE DEMOLITION OF THE BUILDING. THE CONTRACTOR SHALL BE RESPONSIBLE FOR OBTAINING ALL NECESSARY PERMITS AND APPROVALS FROM THE LOCAL, STATE, AND FEDERAL AGENCIES. THE CONTRACTOR SHALL BE RESPONSIBLE FOR OBTAINING ALL NECESSARY PERMITS AND APPROVALS FROM THE LOCAL, STATE, AND FEDERAL AGENCIES. THE CONTRACTOR SHALL BE RESPONSIBLE FOR OBTAINING ALL NECESSARY PERMITS AND APPROVALS FROM THE LOCAL, STATE, AND FEDERAL AGENCIES.
2. REFER TO SECTION C FOR A LIST OF OWNER REQUIRED STANDARDS.
3. REFER TO SECTION C FOR ALL DEMOLITION, ABANDONMENT, RESTORATION, AND PROTECTION REQUIREMENTS.
4. REFER TO SECTION C FOR ALL DEMOLITION, ABANDONMENT, RESTORATION, AND PROTECTION REQUIREMENTS.
5. REFER TO SECTION C FOR ALL DEMOLITION, ABANDONMENT, RESTORATION, AND PROTECTION REQUIREMENTS.
6. REFER TO SECTION C FOR ALL DEMOLITION, ABANDONMENT, RESTORATION, AND PROTECTION REQUIREMENTS.
7. REFER TO SECTION C FOR ALL DEMOLITION, ABANDONMENT, RESTORATION, AND PROTECTION REQUIREMENTS.
8. REFER TO SECTION C FOR ALL DEMOLITION, ABANDONMENT, RESTORATION, AND PROTECTION REQUIREMENTS.
9. REFER TO SECTION C FOR ALL DEMOLITION, ABANDONMENT, RESTORATION, AND PROTECTION REQUIREMENTS.
10. REFER TO SECTION C FOR ALL DEMOLITION, ABANDONMENT, RESTORATION, AND PROTECTION REQUIREMENTS.
11. REFER TO SECTION C FOR ALL DEMOLITION, ABANDONMENT, RESTORATION, AND PROTECTION REQUIREMENTS.

KEY NOTES

1. REFER TO SECTION C FOR ALL DEMOLITION, ABANDONMENT, RESTORATION, AND PROTECTION REQUIREMENTS.
2. REFER TO SECTION C FOR ALL DEMOLITION, ABANDONMENT, RESTORATION, AND PROTECTION REQUIREMENTS.
3. REFER TO SECTION C FOR ALL DEMOLITION, ABANDONMENT, RESTORATION, AND PROTECTION REQUIREMENTS.
4. REFER TO SECTION C FOR ALL DEMOLITION, ABANDONMENT, RESTORATION, AND PROTECTION REQUIREMENTS.
5. REFER TO SECTION C FOR ALL DEMOLITION, ABANDONMENT, RESTORATION, AND PROTECTION REQUIREMENTS.
6. REFER TO SECTION C FOR ALL DEMOLITION, ABANDONMENT, RESTORATION, AND PROTECTION REQUIREMENTS.
7. REFER TO SECTION C FOR ALL DEMOLITION, ABANDONMENT, RESTORATION, AND PROTECTION REQUIREMENTS.
8. REFER TO SECTION C FOR ALL DEMOLITION, ABANDONMENT, RESTORATION, AND PROTECTION REQUIREMENTS.
9. REFER TO SECTION C FOR ALL DEMOLITION, ABANDONMENT, RESTORATION, AND PROTECTION REQUIREMENTS.
10. REFER TO SECTION C FOR ALL DEMOLITION, ABANDONMENT, RESTORATION, AND PROTECTION REQUIREMENTS.
11. REFER TO SECTION C FOR ALL DEMOLITION, ABANDONMENT, RESTORATION, AND PROTECTION REQUIREMENTS.

LEGEND	
	OVERHEAD ELECTRIC LINE
	FIRE HYDRANT
	MANHOLE
	ELECTRIC SERVICE
	WATER SERVICE
	SANITARY SERVICE
	GAS SERVICE
	SEWER SERVICE
	STORM SEWER SERVICE
	FIRE WATER LINE
	CONTROL PANEL
	RETAINING WALL
	UNDERGROUND TANK
	ABANDONED BUILDING
	EXISTING FENCE
	PROPOSED CONSTRUCTION FENCE
	EXISTING CONSTRUCTION FENCE

**STUDBAKER AREA A
 PHASE IV - BID PACKAGE B
 FOUNDRY AND ENGINEERING BUILDING DEMOLITION**

1-800-353-3544
 1-800-453-3300

CDLZ

<p>CDLZ</p>	<p>INDIANA</p>	<p>PROJECT NUMBER 0961584070</p>	<p>DATE MAY 2010</p>	<p>REVISION</p>	<p>BY DATE</p>	<p>APPROVE'S A/C DATE PROJECT NUMBER</p>	<p>1-800-353-3544 1-800-453-3300</p>
	<p>SOUTH BEND</p>	<p>STUDBAKER AREA A PHASE IV - BID PACKAGE B FOUNDRY AND ENGINEERING BUILDING DEMOLITION</p>	<p>CIVIL - BUILDING DEMOLITION & PROTECTION PLAN (FOUNDRY)</p>	<p>11</p>	<p>11</p>	<p>11</p>	<p>11</p>

Stuebaker Engineering Building #92
First Floor

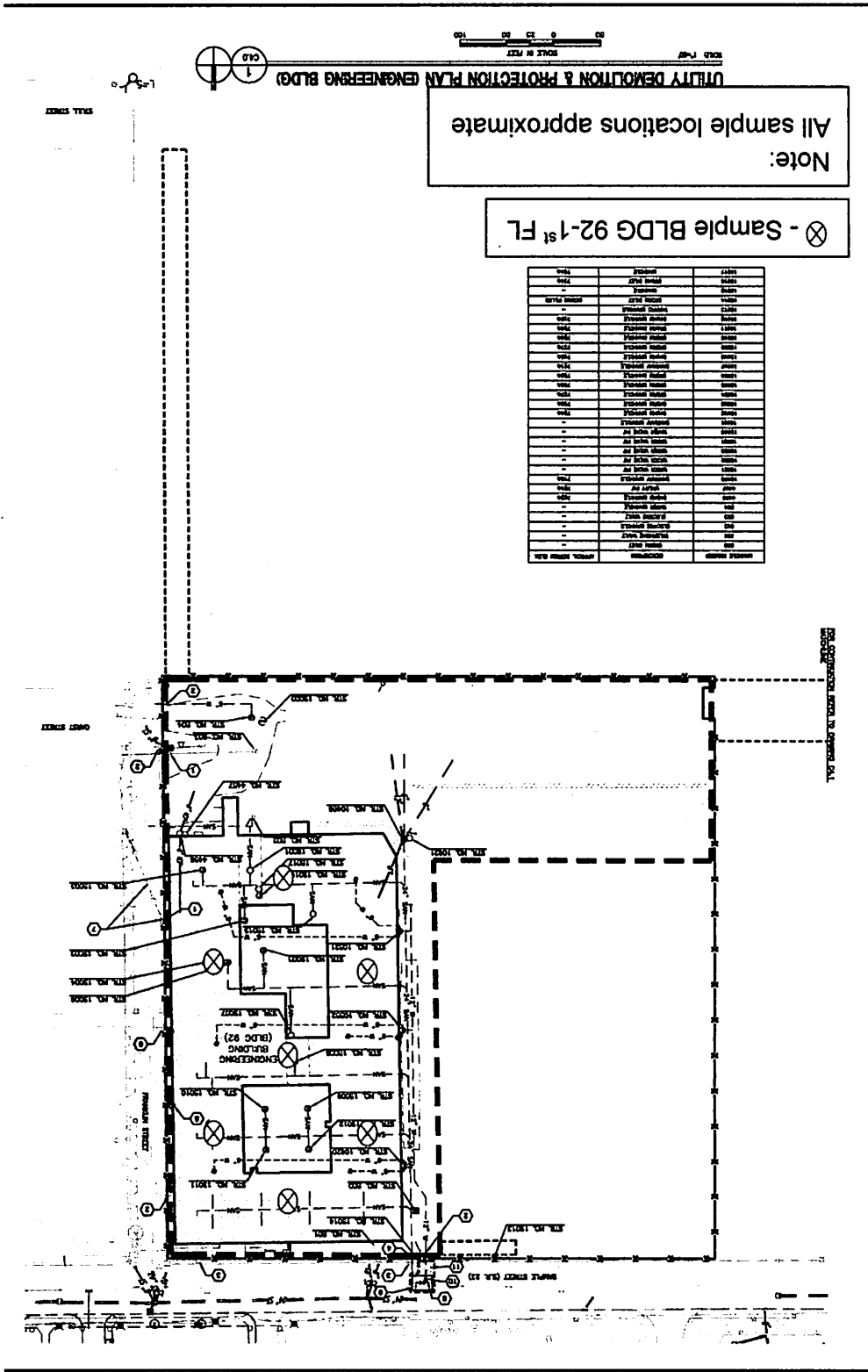

Note:
All sample locations approximate

⊗ - Sample BLDG 92-1st FL

NO.	DESCRIPTION	NO.	DESCRIPTION
1	...	1	...
2	...	2	...
3	...	3	...
4	...	4	...
5	...	5	...
6	...	6	...
7	...	7	...
8	...	8	...
9	...	9	...
10	...	10	...
11	...	11	...
12	...	12	...
13	...	13	...
14	...	14	...
15	...	15	...
16	...	16	...
17	...	17	...
18	...	18	...
19	...	19	...
20	...	20	...
21	...	21	...
22	...	22	...
23	...	23	...
24	...	24	...
25	...	25	...
26	...	26	...
27	...	27	...
28	...	28	...
29	...	29	...
30	...	30	...
31	...	31	...
32	...	32	...
33	...	33	...
34	...	34	...
35	...	35	...
36	...	36	...
37	...	37	...
38	...	38	...
39	...	39	...
40	...	40	...
41	...	41	...
42	...	42	...
43	...	43	...
44	...	44	...
45	...	45	...
46	...	46	...
47	...	47	...
48	...	48	...
49	...	49	...
50	...	50	...

Stuebaker Engineering Building #92
Second Floor

UTILITY DEMOLITION & PROTECTION PLAN (ENGINEERING BLDG)

SCALE: 1"=20'
SCALE IN FEET
0 20 40 100



Note:
All sample locations approximate

⊗ - Sample BLDG 92-2ND FL

ROOM NO.	ROOM NAME	ROOM NO.	ROOM NAME
200	RECEPTION	200	RECEPTION
201	OFFICE	201	OFFICE
202	OFFICE	202	OFFICE
203	OFFICE	203	OFFICE
204	OFFICE	204	OFFICE
205	OFFICE	205	OFFICE
206	OFFICE	206	OFFICE
207	OFFICE	207	OFFICE
208	OFFICE	208	OFFICE
209	OFFICE	209	OFFICE
210	OFFICE	210	OFFICE
211	OFFICE	211	OFFICE
212	OFFICE	212	OFFICE
213	OFFICE	213	OFFICE
214	OFFICE	214	OFFICE
215	OFFICE	215	OFFICE
216	OFFICE	216	OFFICE
217	OFFICE	217	OFFICE
218	OFFICE	218	OFFICE
219	OFFICE	219	OFFICE
220	OFFICE	220	OFFICE
221	OFFICE	221	OFFICE
222	OFFICE	222	OFFICE
223	OFFICE	223	OFFICE
224	OFFICE	224	OFFICE
225	OFFICE	225	OFFICE
226	OFFICE	226	OFFICE
227	OFFICE	227	OFFICE
228	OFFICE	228	OFFICE
229	OFFICE	229	OFFICE
230	OFFICE	230	OFFICE
231	OFFICE	231	OFFICE
232	OFFICE	232	OFFICE
233	OFFICE	233	OFFICE
234	OFFICE	234	OFFICE
235	OFFICE	235	OFFICE
236	OFFICE	236	OFFICE
237	OFFICE	237	OFFICE
238	OFFICE	238	OFFICE
239	OFFICE	239	OFFICE
240	OFFICE	240	OFFICE
241	OFFICE	241	OFFICE
242	OFFICE	242	OFFICE
243	OFFICE	243	OFFICE
244	OFFICE	244	OFFICE
245	OFFICE	245	OFFICE
246	OFFICE	246	OFFICE
247	OFFICE	247	OFFICE
248	OFFICE	248	OFFICE
249	OFFICE	249	OFFICE
250	OFFICE	250	OFFICE
251	OFFICE	251	OFFICE
252	OFFICE	252	OFFICE
253	OFFICE	253	OFFICE
254	OFFICE	254	OFFICE
255	OFFICE	255	OFFICE
256	OFFICE	256	OFFICE
257	OFFICE	257	OFFICE
258	OFFICE	258	OFFICE
259	OFFICE	259	OFFICE
260	OFFICE	260	OFFICE
261	OFFICE	261	OFFICE
262	OFFICE	262	OFFICE
263	OFFICE	263	OFFICE
264	OFFICE	264	OFFICE
265	OFFICE	265	OFFICE
266	OFFICE	266	OFFICE
267	OFFICE	267	OFFICE
268	OFFICE	268	OFFICE
269	OFFICE	269	OFFICE
270	OFFICE	270	OFFICE
271	OFFICE	271	OFFICE
272	OFFICE	272	OFFICE
273	OFFICE	273	OFFICE
274	OFFICE	274	OFFICE
275	OFFICE	275	OFFICE
276	OFFICE	276	OFFICE
277	OFFICE	277	OFFICE
278	OFFICE	278	OFFICE
279	OFFICE	279	OFFICE
280	OFFICE	280	OFFICE
281	OFFICE	281	OFFICE
282	OFFICE	282	OFFICE
283	OFFICE	283	OFFICE
284	OFFICE	284	OFFICE
285	OFFICE	285	OFFICE
286	OFFICE	286	OFFICE
287	OFFICE	287	OFFICE
288	OFFICE	288	OFFICE
289	OFFICE	289	OFFICE
290	OFFICE	290	OFFICE
291	OFFICE	291	OFFICE
292	OFFICE	292	OFFICE
293	OFFICE	293	OFFICE
294	OFFICE	294	OFFICE
295	OFFICE	295	OFFICE
296	OFFICE	296	OFFICE
297	OFFICE	297	OFFICE
298	OFFICE	298	OFFICE
299	OFFICE	299	OFFICE
300	OFFICE	300	OFFICE

