

Article 21-03: Standard Districts

Sections

Section 21-03.01: S1 Suburban Neighborhood 1	3-3
Section 21-03.02: S2 Suburban Neighborhood 2	3-9
Section 21-03.03: U1 Urban Neighborhood 1	3-15
Section 21-03.04: U2 Urban Neighborhood 2	3-21
Section 21-03.05: U3 Urban Neighborhood 3	3-27
Section 21-03.06: UF Urban Neighborhood Flex	3-33
Section 21-03.07: NC Neighborhood Center	3-39
Section 21-03.08: DT Downtown	3-45

This page intentionally left blank



Section 21-03.01: S1 Suburban Neighborhood 1

(a) Intent

The S1 Suburban District is established to provide for and maintain suburban neighborhoods in outlying areas of the City.

The following are typical characteristics of the S1 District:

- Primarily single unit residential development of detached houses. Up to two units per lot may be allowed to provide added value and more effective use of a lot
- Buildings with relatively deep setbacks on larger lots
- Attached garages accessed by a driveway from the street
- Larger city blocks that have a more informal character and plantings

(b) Building Types

The following building types are permitted in the S1 District:

- Carriage House
- Duplex
- Detached House

The names of the building types are not intended to limit or expand uses allowed within the building. See [Section 21-08.02](#) for building type descriptions and regulations.

Limited public and institutional uses shall be incorporated at a scale and character compatible with the surrounding neighborhood.

Uses

(c) Principal Uses	Use Definition & Standards
Agricultural	
Community Garden	■ * 21-06.01(e)(2)
Civic & Institutional	
Assembly, Neighborhood	■ * 21-06.01(f)(1)
Cemetery	■ 21-06.01(f)(3)
College/University	■ 21-06.01(f)(4)
Library/Museum/Cultural Facility	■ * 21-06.01(f)(7)
Parks & Open Space	■ 21-06.01(f)(8)
Police/Fire Facilities	■ 21-06.01(f)(9)
Religious Institutions	■ 21-06.01(f)(10)
School, Pre-K/Primary/Secondary	■ 21-06.01(f)(11)
Lodging	
Bed & Breakfast	■ * 21-06.01(h)(1)
Residential	
Dwelling, Ancillary	■ * 21-06.01(j)(1)
Dwelling, 1 Unit	■ 21-06.01(j)(2)
Dwelling, 2 Units	■ 21-06.01(j)(3)
Group Residence, State Regulated	■ 21-06.01(j)(7)
Residential Care Facility	■ 21-06.01(j)(8)
Retail & Service	
Day Care Center	■ 21-06.01(k)(6)
Entertainment/Recreation Facility, Outdoor	■ 21-06.01(k)(9)
Funeral Services	■ 21-06.01(k)(10)
Transportation	
Parking Lot	■ * 21-06.01(l)(4)
Utilities	
Solar Farm	■ 21-06.01(m)(1)
Utilities, Major	■ * 21-06.01(m)(2)
Utilities, Minor	■ * 21-06.01(m)(3)
Wireless Communications	■ * 21-06.01(m)(4)

See [Section 21-06.01](#) for all principal use definitions.

See [Section 21-06.02](#) for accessory use standards.

Key ■ Allowed ■ Allowed subject to Conditions ■ Special Exception * Use Specific Standards

Building Placement

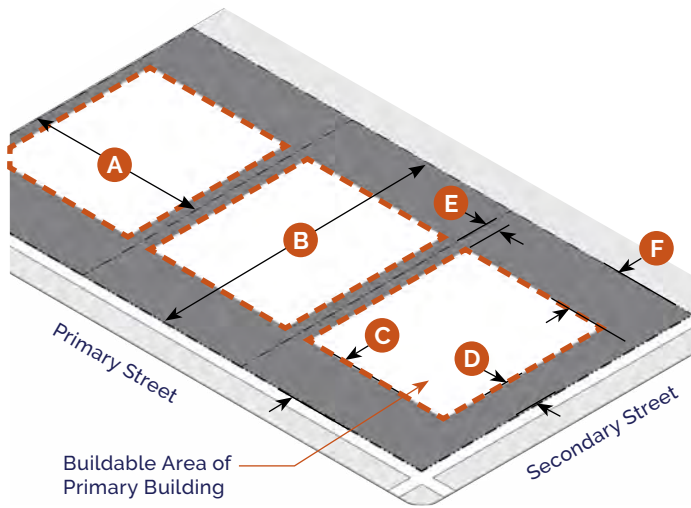

--- Minimum Setback Line

(d) Building Placement				
Lot Size				
Lot Width		40' min.		A
Lot Depth		60' min.		B
Building Setbacks	Front ¹	Corner	Side	Rear
	C	D	E	F
Residential (min.)	25'	15'	5'	25'
Non-Residential (min.)	25'	15'	20'	25'
Building Coverage				
Building Coverage	40% max.			

¹ Where existing buildings on a block face are not consistent with the required setbacks, any new building may apply the contextual setback per [Section 21-02.03\(b\)](#).

Access & Parking

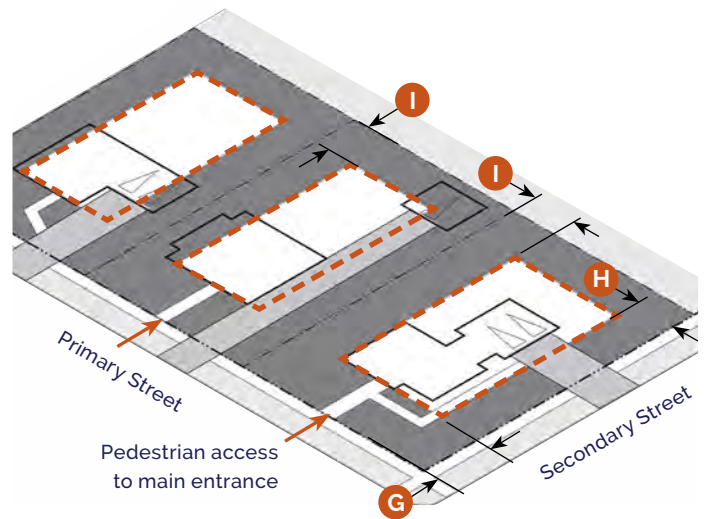

--- Minimum Parking Lot Setback

(e) Access & Parking		
Pedestrian Access		
A walkway shall connect the sidewalk or driveway to the main entrance.		
Bicycle Access		
See Section 21-07.02 for Bicycle Parking requirements.		
Parking Access		
If access is available from an alley which is open to traffic, there shall be no access allowed from the street.		
If allowed, a maximum of one street curb cut is permitted per street frontage.		
Parking Lot Location (Distance from Lot Line)		
Front Setback (min.)	25'	G
Corner Setback (min.)	15'	H
Side & Rear Setback	20'	I
Side and rear setback shall be 0' when abutting an alley.		
Required Spaces		
Off-street parking areas are not required for any use.		
Any off-street parking areas provided, even though not required, shall be developed in compliance with the standards set forth in Section 21-07.03 .		
See Section 21-07 for full access and parking requirements.		

Building Form

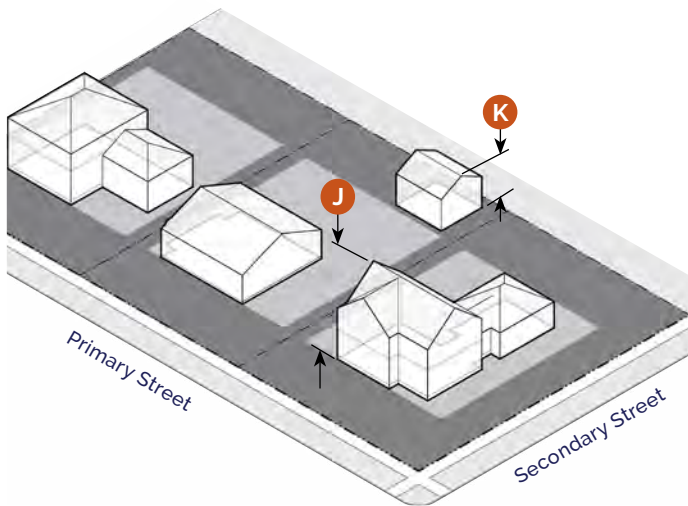

(f) Building Form

Building Height

Primary Building (max.) 35' and 2.5 stories **J**

Accessory Building (max.)¹ 18' **K**

Accessory buildings, except for ancillary dwelling units, shall not be taller than the primary building on a lot.

Building Orientation

Primary facades shall be oriented to a front lot line or open space.

¹ Ancillary dwelling units may be built to a maximum height of 26' if located at least 5' from the rear lot line of a lot with a rear alley or at least 20' from the rear lot line of a lot without a rear alley.

Building Components

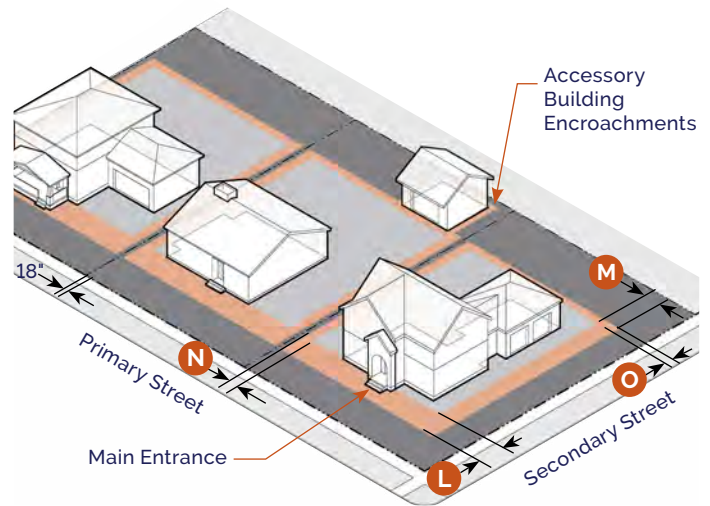

Encroachment Zone

(g) Building Components

Allowed Building Frontage Types

Porch [21-08.03\(c\)](#)

Stoop [21-08.03\(d\)](#)

Gallery [21-08.03\(e\)](#)

Building Entrance

The main entrance shall be located on the front facade, on the corner facade, or on the side facade within 20' of the front facade.

Allowed Encroachments (max.)	Front L	Corner M	Side N	Rear O
------------------------------	----------------	-----------------	---------------	---------------

Architectural Features	3'	3'	3'	3'
------------------------	----	----	----	----

Building Frontage Type	10'	5'	<input type="checkbox"/>	<input type="checkbox"/>
------------------------	-----	----	--------------------------	--------------------------

Balcony	5'	5'	<input type="checkbox"/>	5'
---------	----	----	--------------------------	----

Bay Window (< 10' wide)	3'	3'	3'	3'
-------------------------	----	----	----	----

Patio & Decks (under 30")	8'	8'	<input checked="" type="checkbox"/>	<input checked="" type="checkbox"/>
---------------------------	----	----	-------------------------------------	-------------------------------------

Building components shall be at least 18" from any lot line.

See [Section 21-08.01\(g\)](#) for building component definitions and additional requirements.

Key Allowed Not Allowed

Building Standards

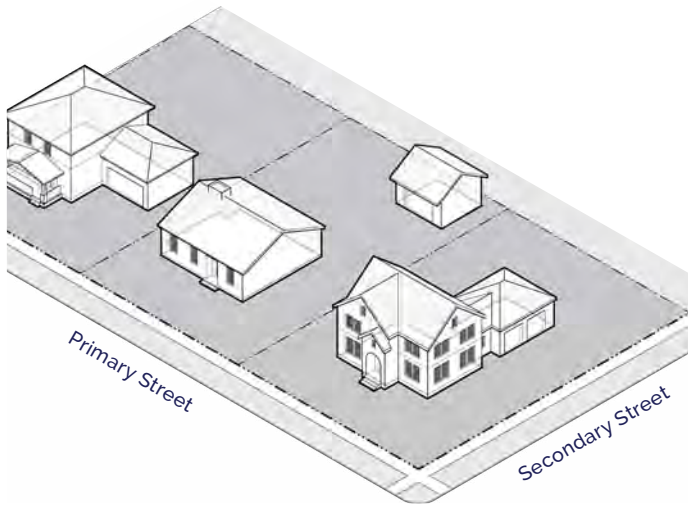

Site Development

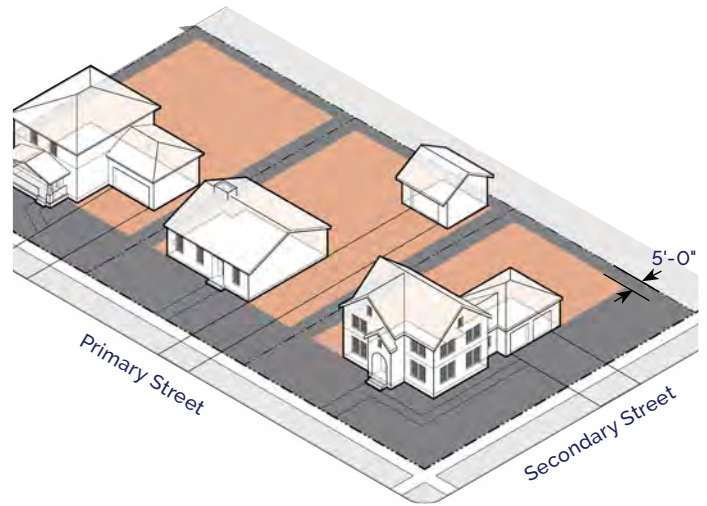

Accessory Structures Allowed

(h) Building Standards **(i) Site Development**

Façade Transparency (min.)	
Ground Floor - Front Façade	10%
Ground Floor - Corner Façade	5%
Upper Floor - Front Façade	10%
Upper Floor - Corner Façade	5%

Building Materials
 There are no restrictions on building materials for residential buildings within the S1 district.
 See [Section 21-08.01\(e\)](#) for building material restrictions that shall apply to any non-residential building.
 See [Section 21-08](#) for full building standards.

Accessory Structures/Uses	
Accessory Structures	21-06.02(f)(1)
Mechanical/HVAC	21-06.02(f)(14)
Satellite Dish Antennas	21-06.02(f)(22)
Swimming Pool/Hot Tubs	21-06.02(f)(26)

Allowed Location in Established Yards
 Accessory structures shall not be located in any established front or corner yard.
 Accessory structures shall comply with all required setbacks but may encroach into a required rear setback up to 5' of the lot line.
 See [Section 21-06.02](#) for full accessory use regulations.

Fence/Freestanding Walls	Front	Corner	Side	Rear
Height (max.)	3'	3'	6'	6'

A fence up to 4' is allowed in an established front or corner yard if fence is greater than 50% open.
 See [Section 21-09](#) for full site development requirements.

Landscape

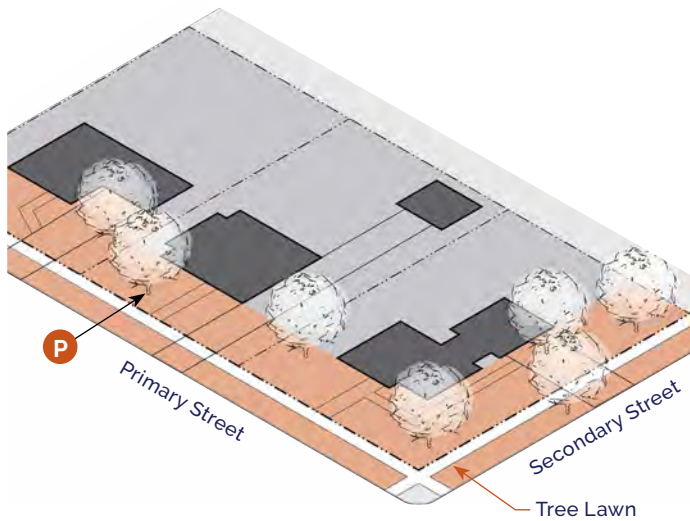

Streetscape Trees Allowed

(j) Landscape

Streetscape Trees Required

Shade Tree ¹	1 tree min. per each full 30' of street frontage	P
Location	Front yard, corner yard, or tree lawn	

Foundation Landscape Required ²

Front & Corner Facades Over 35' Wide	1 shrub per 5' of facade min.
Location	Directly adjacent to facade

Parking Lot Screening (of 4 or more spaces)

Parking that is visible from a street/open space, other than an alley, shall be screened by a Type 1 buffer.

Parking that is visible from a side/rear lot line abutting a S1, U1, or U2 district shall be screened by a Type 1 or 2 buffer.

Buffers shall comply with [Section 21-09.01\(o\)](#).

See [Section 21-09.01](#) for full landscape requirements.

¹ An existing tree of at least 1.75" caliper may fulfill this requirement.

² Residential buildings with 4 or fewer units are exempt from foundation landscape requirements.

Signs

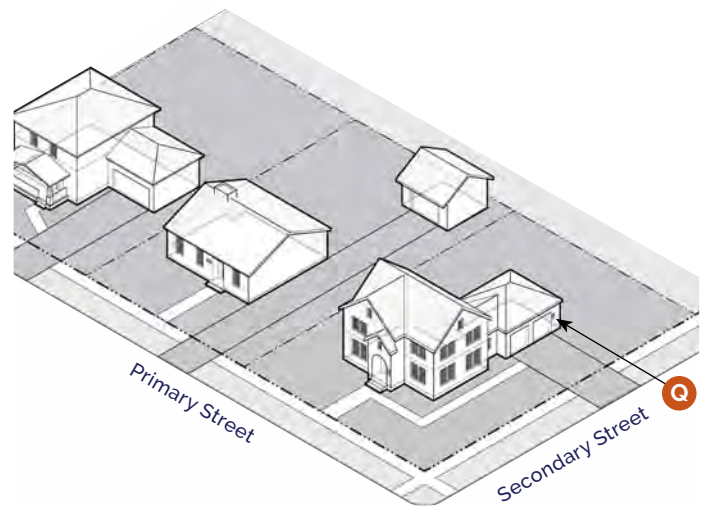

(k) Signs

Total Signs Allowed

Residential		
Building or Freestanding Sign	1 per street frontage; up to 2 square feet and 4 feet in height	Q
Non-Residential Use		
Building Sign	Up to 5% of the total area of the building facade	
Freestanding Sign	1 per street frontage; up to 32 square feet and 6 feet in height	

Freestanding signs may be located in a required setback, provided they are at least 5' from a lot line.

See [Section 21-10](#) for full sign requirements including changeable copy signs, temporary signs, exempt signs, off-premise, and use-specific signs.



Section 21-03.02: S2 Suburban Neighborhood 2

(a) Intent

The S2 District is established to provide for, maintain, and enhance suburban neighborhoods consisting primarily of apartment complexes or houses grouped together outside of the City's core.

The following are typical characteristics of the S2 District:

- A full range of residential development including single unit, two unit, multi-unit, and ancillary dwelling units that maximize amenities nearby while providing a variety of housing choice
- Larger size buildings with relatively deep setbacks on larger lots
- Attached garages accessed by a driveway from the street or shared parking areas located in the rear or interior of the lot
- Larger city blocks that have a more informal character and plantings

(b) Building Types

The following building types are permitted in the S2 District:

- | | |
|------------------|-------------------|
| ■ Carriage House | ■ Townhouse |
| ■ Detached House | ■ Apartment House |
| ■ Cottage Court | ■ Stacked Flats |
| ■ Duplex | |

The names of the building types are not intended to limit or expand uses allowed within the building. See [Section 21-08.02](#) for building type descriptions and regulations.

Limited public and institutional uses shall be incorporated at a scale and character compatible with the surrounding neighborhood

Uses

(c) Principal Uses	Use Definition & Standards
Agricultural	
Community Garden	■ * 21-06.01(e)(2)
Civic & Institutional	
Assembly, Neighborhood	■ * 21-06.01(f)(1)
Cemetery	■ 21-06.01(f)(3)
College/University	■ 21-06.01(f)(4)
Library/Museum/Cultural Facility	■ * 21-06.01(f)(7)
Parks & Open Space	■ 21-06.01(f)(8)
Police/Fire Facilities	■ 21-06.01(f)(9)
Religious Institutions	■ 21-06.01(f)(10)
School, Pre-K/Primary/Secondary	■ 21-06.01(f)(11)
Lodging	
Bed & Breakfast	■ * 21-06.01(h)(1)
Residential	
Dwelling, Ancillary	■ * 21-06.01(j)(1)
Dwelling, 1 Unit	■ 21-06.01(j)(2)
Dwelling, 2 Units	■ 21-06.01(j)(3)
Dwelling, Multi-Unit	■ * 21-06.01(j)(5)
Dwelling, Mobile Home	■ 21-06.01(j)(6)
Group Residence, State Regulated	■ 21-06.01(j)(7)
Residential Care Facility	■ 21-06.01(j)(8)
Retail & Service	
Day Care Center	■ 21-06.01(k)(6)
Entertainment/Recreation Facility, Outdoor	■ 21-06.01(k)(9)
Funeral Services	■ 21-06.01(k)(10)
Transportation	
Parking Lot	■ * 21-06.01(l)(4)
Utilities	
Solar Farm	■ 21-06.01(m)(1)
Utilities, Major	■ * 21-06.01(m)(2)
Utilities, Minor	■ * 21-06.01(m)(3)
Wireless Communications	■ * 21-06.01(m)(4)

See [Section 21-06.01](#) for all principal use definitions.

See [Section 21-06.02](#) for accessory use standards.

Key ■ Allowed ■ Allowed subject to Conditions ■ Special Exception * Use Specific Standards

Building Placement

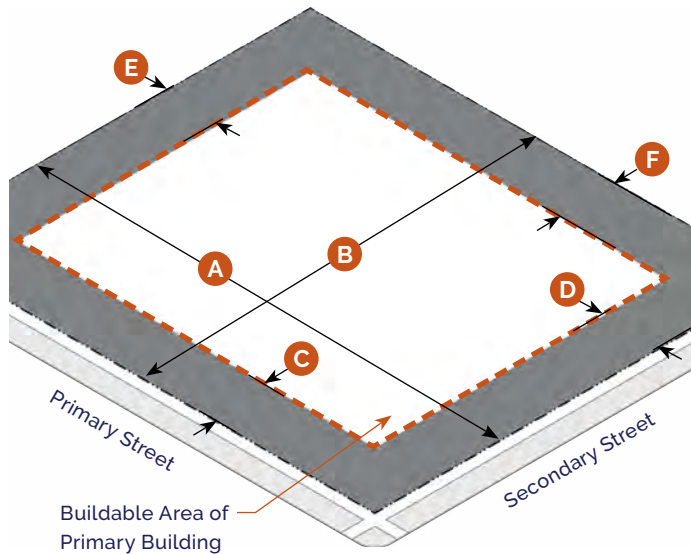

--- Minimum Setback Line

(d) Building Placement				
Lot Size				
Lot Width	20' min.			A
Lot Depth	60' min.			B
Building Setbacks	Front¹	Corner	Side²	Rear
	C	D	E	F
All Uses (min.)	25'	25'	25'	25'
Building Coverage				
Building Coverage	50% max.			

¹ Where existing buildings on a block face are not consistent with the required setbacks, any new building may apply the contextual setback per [Section 21-02.03\(b\)](#).

² Side setback not required between attached dwellings and may be reduced to 10 feet min. for buildings with 4 or fewer dwellings.

Access & Parking

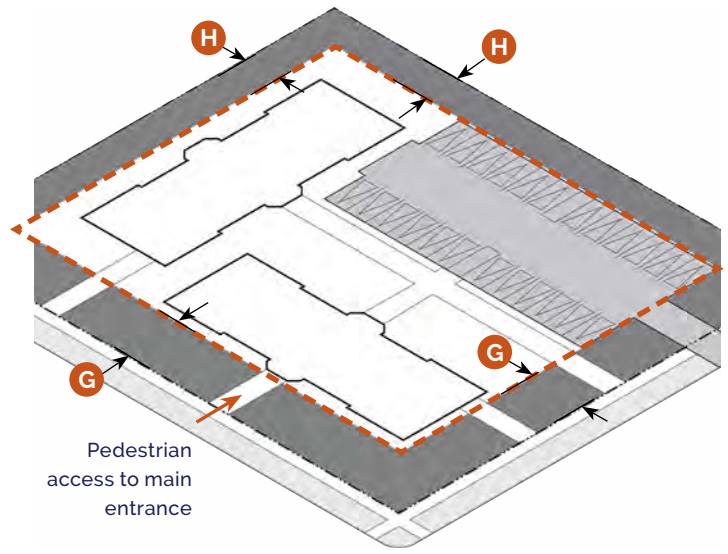

--- Minimum Parking Lot Setback

(e) Access & Parking		
Pedestrian Access		
A walkway shall connect the sidewalk or driveway to the main entrance.		
Bicycle Access		
See Section 21-07.02 for Bicycle Parking requirements.		
Parking Access		
If access is available from an alley which is open to traffic, there shall be no access allowed from the street.		
If allowed, a maximum of one street curb cut is permitted per street frontage.		
Parking Lot Location (Distance from Lot Line)		
Front & Corner Setback (min.)	25'	G
Side & Rear Setback (min.)	10'	H
Side and rear setback shall be 0' when abutting an alley.		
Required Spaces		
Off-street parking areas are not required for any use.		
Any off-street parking areas provided, even though not required, shall be developed in compliance with the standards set forth in Section 21-07.03 .		
See Section 21-07 for full access and parking requirements.		

Building Form

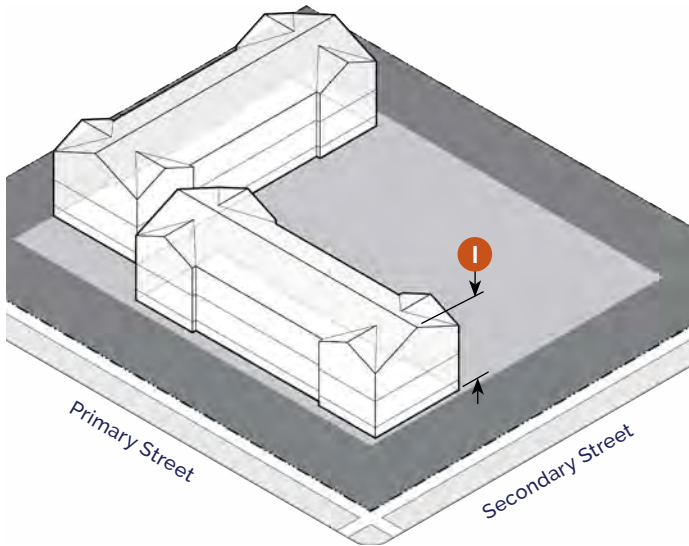

(f) Building Form

Building Height

Primary Building (max.) 40' and 3 stories **I**

Accessory Building (max.) 26'

Accessory buildings, except for ancillary dwelling units, shall not be taller than the primary building on a lot.

Building Orientation

Primary facades shall be oriented to a front lot line or open space.

Building Components

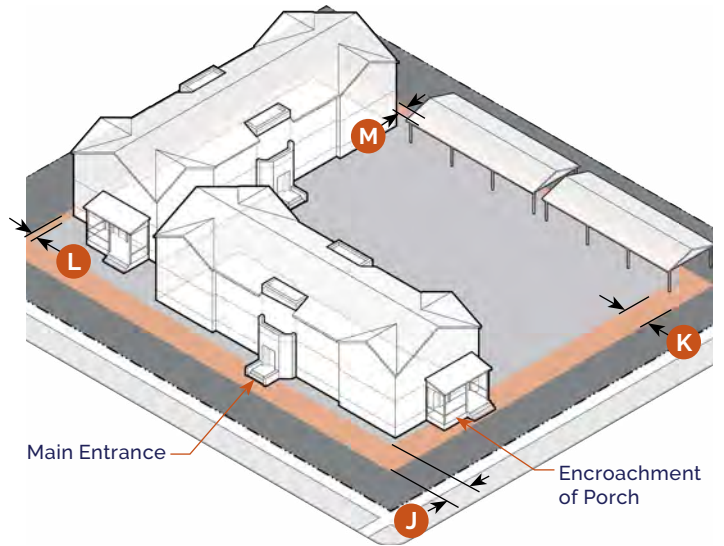

Encroachment Zone

(g) Building Components

Allowed Building Frontage Types

Porch	21-08.03(c)
Stoop	21-08.03(d)
Gallery	21-08.03(e)
Forecourt	21-08.03(f)

Building Entrance

The main entrance shall be located on the front facade, on the corner facade, or on the side facade within 20' of the front facade.

Allowed Encroachments (max.)	Front J	Corner K	Side L	Rear M
Architectural Features	3'	3'	3'	3'
Building Frontage Type	10'	10'	□	□
Balcony	5'	5'	□	5'
Bay Window (< 10' wide)	3'	3'	3'	3'
Patio & Decks (under 30")	8'	8'	■	■

See Section [21-08.01\(g\)](#) for building component definitions and additional requirements.

Key ■ Allowed □ Not Allowed

Building Standards

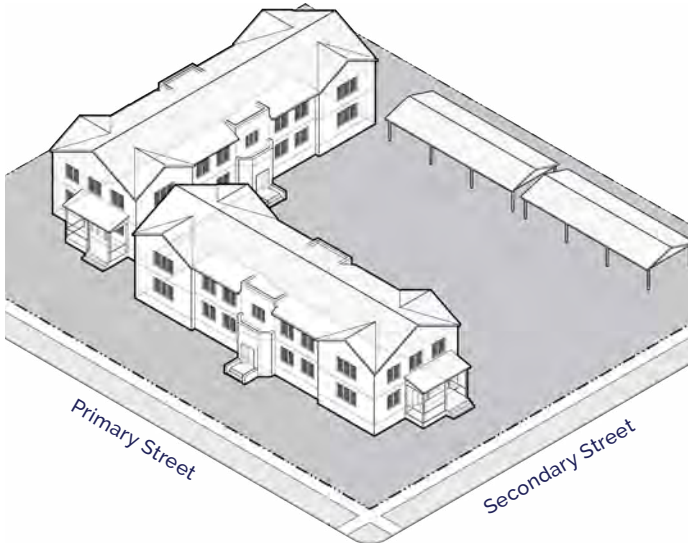

Site Development

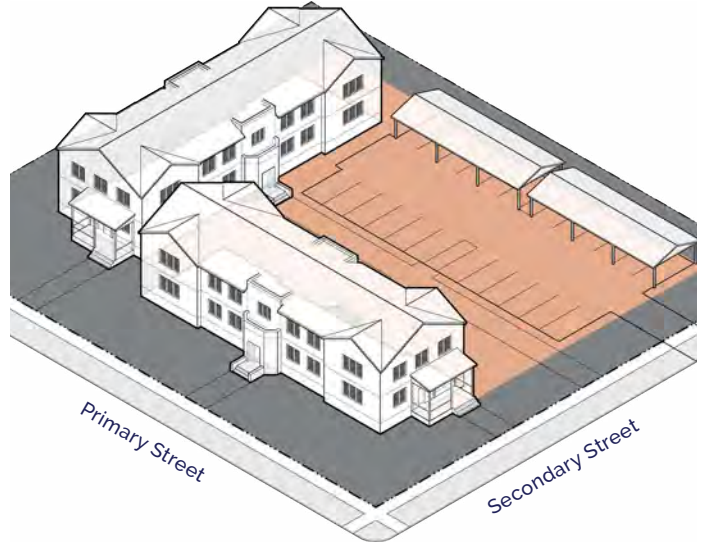

Accessory Structures Allowed

(h) Building Standards	
Façade Transparency (min.)	
Ground Floor - Front Façade	10%
Ground Floor - Corner Façade	5%
Upper Floor - Front & Corner Façade	15%
Building Materials	
Restrictions on building materials shall apply to all front and corner façades of residential buildings with 5 or more units and non-residential buildings.	
Building materials used on the front and corner façades shall extend a minimum depth of 16" along the side façade.	
E.I.F.S. is not permitted on the ground floor except as trim.	
Standard, fluted, or split face concrete masonry units above the basement level are prohibited as face material.	
Unfinished metal, plywood, unfinished precast or poured-in-place concrete are prohibited.	
Commercial-grade/scale products are prohibited on any residential building façade.	
Windows and doors on a ground floor front/corner façade shall have clear, transparent glass that has a min. VLT of 50% and a max. VLR of 25%.	
See Section 21-08 for full building standards.	

(i) Site Development	
Accessory Structures/Uses	
Accessory Structures	21-06.02(f)(1)
Mechanical/HVAC	21-06.02(f)(14)
Satellite Dish Antennas	21-06.02(f)(22)
Swimming Pool/Hot Tubs	21-06.02(f)(26)
Trash/Recycling Container	21-06.02(f)(27)
Allowed Location in Established Yards	
Accessory structures shall not be located in any established front or corner yard.	
Accessory structures shall comply with all required setbacks but may encroach into a required rear setback up to 5' of the lot line.	
See Section 21-06.02 for full accessory use regulations.	
Fence/Freestanding Walls	Front Corner Side Rear
Height (max.)	3' 3' 6' 6'
A fence up to 4' is allowed in an established front or corner yard if fence is greater than 50% open.	
See Section 21-09 for full site development requirements.	

Key ■ Allowed □ Not Allowed

Landscape

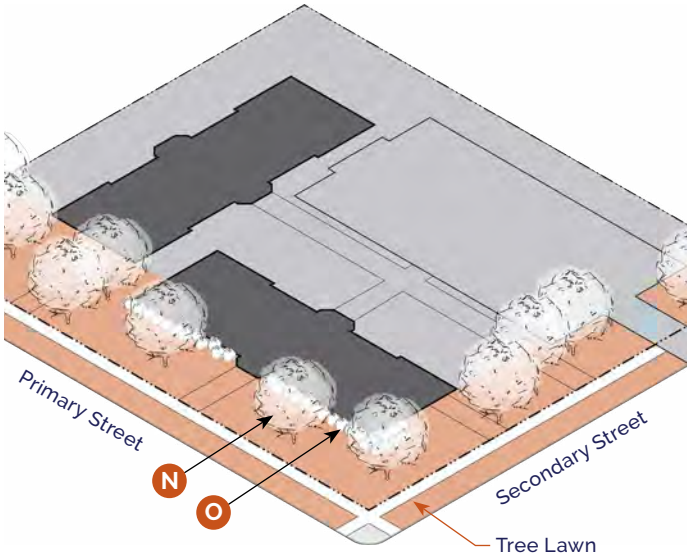

Streetscape Trees Allowed

(j) Landscape

Streetscape Trees Required

Shade Tree ¹	1 tree min. per each full 30' of street frontage	N
Location	Front yard, corner yard, or tree lawn	

Foundation Landscape Required ²

Front & Corner Facades Over 35' Wide	1 shrub per 5' of facade min.	O
Location	Directly adjacent to facade	

Buffer Landscape Required ²

Adjacent to S1, U1, or U2 Type 3 buffer

Parking Lot Screening (of 4 or more spaces)

Parking that is visible from a street/open space, other than an alley, shall be screened by a Type 1 buffer. Buffers shall comply with [Section 21-09.01\(o\)](#).

See [Section 21-09.01](#) for full landscape requirements.

¹ An existing tree of at least 1.75" caliper may fulfill this requirement.

² Residential buildings with 4 or fewer units are exempt from foundation and buffer landscape requirements.

Signs

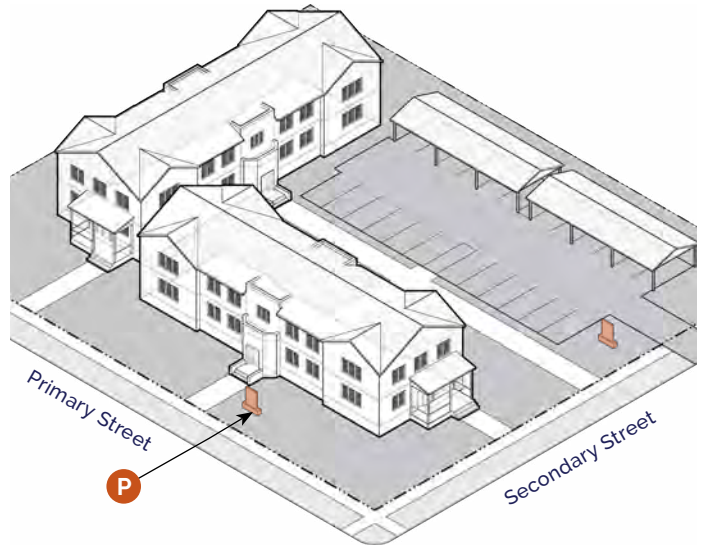

(k) Signs

Total Signs Allowed

Residential: 4 or fewer dwellings		
Building or Freestanding Sign	1 per street frontage; up to 2 square feet and 4 feet in height	

Residential: 5+ dwelling units

Building or Freestanding Sign	1 per street frontage; up to 32 square feet and 6 feet in height	P
-------------------------------	--	----------

Non-Residential Use

Building Sign	Up to 5% of the total area of the building facade	
Freestanding Sign	1 per street frontage; up to 32 square feet and 6 feet in height	

Freestanding signs may be located in a required setback, provided they are at least 5' from a lot line.

See [Section 21-10](#) for full sign requirements including changeable copy signs, temporary signs, exempt signs, off-premise, and use-specific signs.



Section 21-03.03: U1 Urban Neighborhood 1

(a) Intent

The U1 District is established to provide for, promote, and maintain urban neighborhoods located in both the core and outlying areas of the City.

The following are typical characteristics of the U1 District:

- Primarily single and two unit residential development in the form of detached houses, allowing the addition of ancillary dwelling units to give additional value
- Buildings with modest setbacks and inviting building frontages, primarily of stoops and porches, that create a consistent block face along smaller city blocks
- Detached garages located at the rear of the lot, often accessed from an alley
- Pedestrian-oriented scale with sidewalks and regularly spaced street trees

(b) Building Types

The following building types are permitted in the U1 District:

- Carriage House
- Duplex
- Detached House

The names of the building types are not intended to limit or expand uses allowed within the building. See [Section 21-08.02](#) for building type descriptions and regulations.

Limited public and institutional uses shall be incorporated at a scale and character compatible with the surrounding neighborhood.

Uses

(c) Principal Uses	Use Definition & Standards
Agricultural	
Community Garden	■ * 21-06.01(e)(2)
Civic & Institutional	
Assembly, Neighborhood	■ * 21-06.01(f)(1)
Cemetery	■ 21-06.01(f)(3)
College/University	■ 21-06.01(f)(4)
Library/Museum/Cultural Facility	■ * 21-06.01(f)(7)
Parks & Open Space	■ 21-06.01(f)(8)
Police/Fire Facilities	■ 21-06.01(f)(9)
Religious Institutions	■ 21-06.01(f)(10)
School, Pre-K/Primary/Secondary	■ 21-06.01(f)(11)
Lodging	
Bed & Breakfast	■ * 21-06.01(h)(1)
Residential	
Dwelling, Ancillary	▣ * 21-06.01(j)(1)
Dwelling, 1 Unit	■ 21-06.01(j)(2)
Dwelling, 2 Units	■ 21-06.01(j)(3)
Group Residence, State Regulated	■ 21-06.01(j)(7)
Residential Care Facility	■ 21-06.01(j)(8)
Retail & Service	
Day Care Center	■ 21-06.01(k)(6)
Entertainment/Recreation Facility, Outdoor	■ 21-06.01(k)(9)
Funeral Services	■ 21-06.01(k)(10)
Transportation	
Parking Lot	■ * 21-06.01(l)(4)
Utilities	
Solar Farm	■ 21-06.01(m)(1)
Utilities, Major	■ * 21-06.01(m)(2)
Utilities, Minor	■ * 21-06.01(m)(3)
Wireless Communications	■ * 21-06.01(m)(4)
See Section 21-06.02 for accessory use standards.	

Key ■ Allowed ▣ Allowed subject to Conditions ■ Special Exception * Use Specific Standards

Building Placement

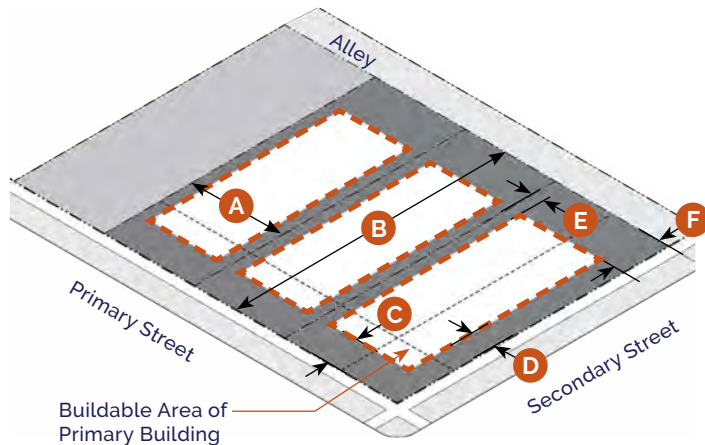

- Minimum Setback Line
- Maximum Setback Line

(d) Building Placement

Lot Size				
Lot Width ¹	30' min.			A
Lot Depth	60' min.			B
Building Setbacks	Front ²	Corner	Side ³	Rear
Residential (min.)	15'	10'	5'	20'
Residential (max.)	25'	25'	-	-
Non-Residential (min.)	15'	10'	20'	20'
Facade within Setback Zone				
Front (min.)	65%			
Corner (min.)	50%			
Building Coverage				
Building Coverage	50% max.			

¹ Lot width may be reduced to 20' for attached dwellings.
² Where existing buildings on a block face are not consistent with the required setbacks, any new building may apply the contextual setback per [Section 21-02.03\(b\)](#).
³ Side setback not required between attached dwellings.

Access & Parking

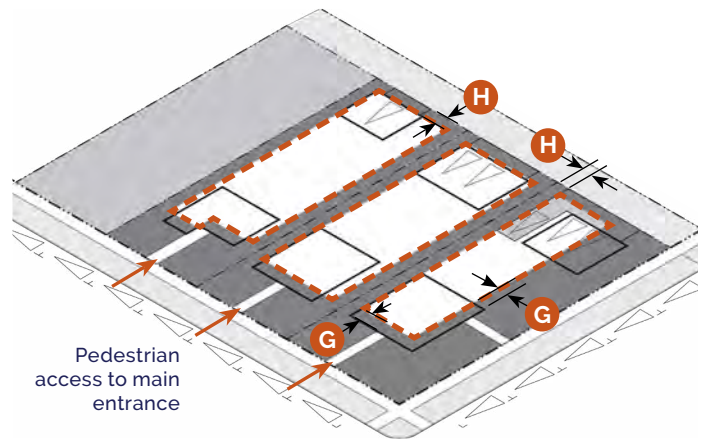

- Minimum Parking Lot Setback

(e) Access & Parking

Pedestrian Access		
A walkway shall connect the sidewalk or driveway to the main entrance.		
Bicycle Access		
See Section 21-07.02 for Bicycle Parking requirements.		
Parking Access		
If access is available from an alley which is open to traffic, there shall be no access allowed from the street. If allowed, a maximum of one curb cut is permitted per street frontage.		
A garage facing a street shall be set back not less than 18'.		
A garage facing an alley shall be set back 5' from rear lot line or not less than 18'.		
Parking Lot Location (Distance from Lot Line)		
Front & Corner Setback (min.)	5' behind facade, or 12' if no building	G
Side & Rear Setback (min.)	5'	H
Side and rear setback shall be 0' when abutting an alley.		
Required Spaces		
Off-street parking areas are not required for any use. Any off-street parking areas provided, even though not required, shall be developed in compliance with the standards set forth in Section 21-07.03 .		
See Section 21-07 for full access and parking requirements.		

Building Form

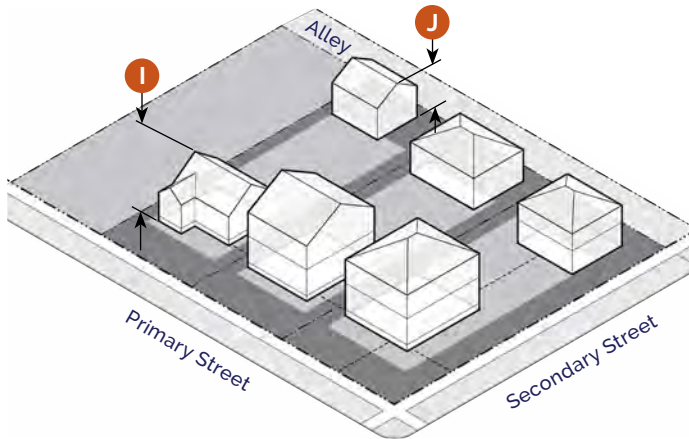

(f) Building Form

Building Height

Primary Building (max.)	35' and 2.5 stories	I
Accessory Building (max.) ¹	18'	J

Accessory buildings, except for ancillary dwelling units, shall not be taller than the primary building on a lot.

Building Orientation

Primary facades shall be oriented to a front lot line or open space.

¹ Ancillary dwelling units may be built to a maximum height of 26' if located at least 5' from the rear lot line of a lot with a rear alley or at least 20' from the rear lot line of a lot without a rear alley.

Building Components

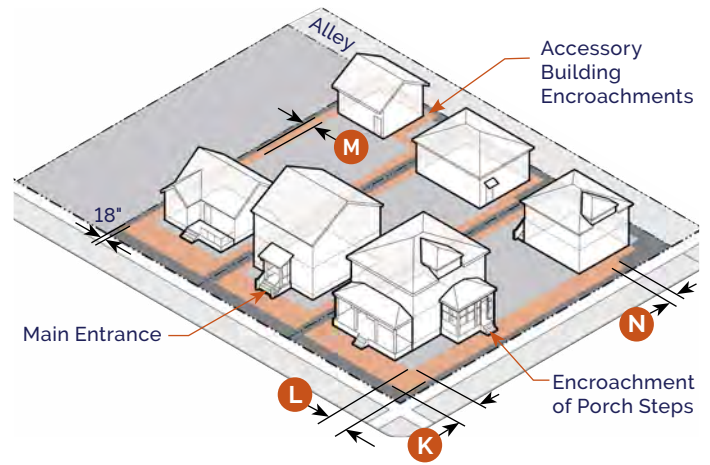

Encroachment Zone

(g) Building Components

Allowed Building Frontage Types

Porch	21-08.03(c)
Stoop	21-08.03(d)
Gallery	21-08.03(e)

Building Entrance

The main entrance shall be located on the front facade, on the corner facade, or on the side facade within 20' of the front facade.

Allowed Encroachments (max.)	Front K	Corner L	Side M	Rear N
Architectural Features	3'	3'	3'	3'
Building Frontage Type	5'	5'	<input type="checkbox"/>	<input type="checkbox"/>
Balcony	5'	5'	<input type="checkbox"/>	5'
Bay Window (< 10' wide)	3'	3'	3'	3'
Patio & Decks (under 30")	8'	8'	<input checked="" type="checkbox"/>	<input checked="" type="checkbox"/>

Building components shall be at least 18" from any lot line.

See [Section 21-08.01\(g\)](#) for building component definitions and additional requirements.

Key Allowed Not Allowed

Building Standards

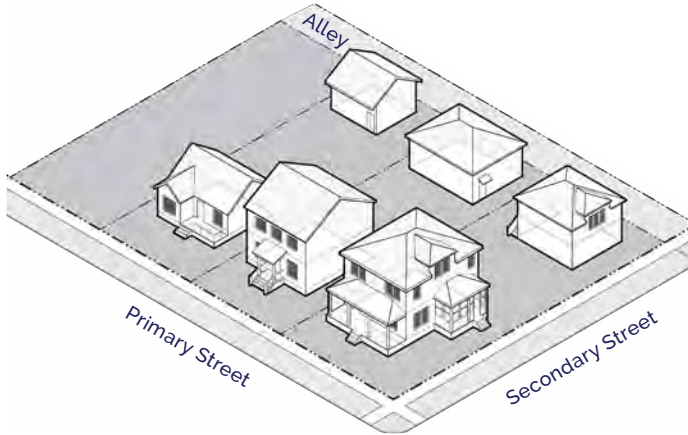

Site Development

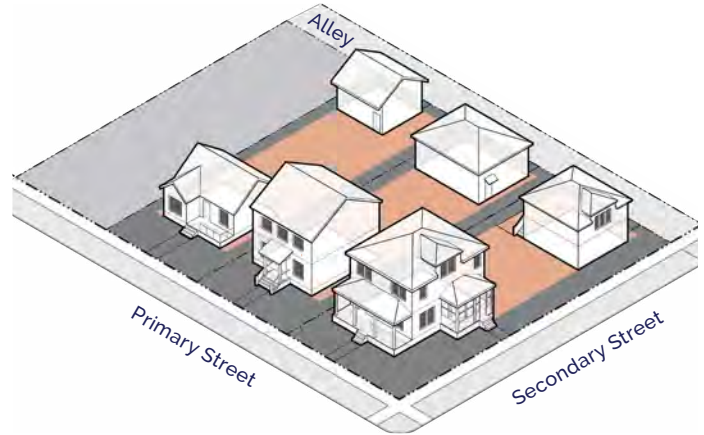

 Accessory Structures Allowed

(h) Building Standards

Facade Transparency (min.)

Ground Floor - Front & Corner Facade	15%
Upper Floor - Front & Corner Facade	15%

Building Materials

There are no restrictions on building materials for residential buildings within the U1 district.

See [Section 21-08.01\(e\)](#) for building material restrictions that shall apply to any non-residential building.

See [Section 21-08](#) for full building standards.

(i) Site Development

Accessory Structures/Uses

Accessory Structures	21-06.02(f)(1)
Mechanical/HVAC	21-06.02(f)(14)
Satellite Dish Antennas	21-06.02(f)(22)
Swimming Pool/Hot Tubs	21-06.02(f)(26)

Allowed Location in Established Yards

Accessory structures shall not be located in any established front or corner yard.

Accessory structures shall comply with all required setbacks but may encroach into a required rear setback up to 5' of the lot line.

See [Section 21-06.02](#) for full accessory use regulations.

Fence/Freestanding Walls	Front	Corner	Side	Rear
Height (max.)	3'	3'	6'	6'

A fence up to 4' is allowed in an established front or corner yard if fence is greater than 50% open.

See [Section 21-09](#) for full site development requirements.

Landscape

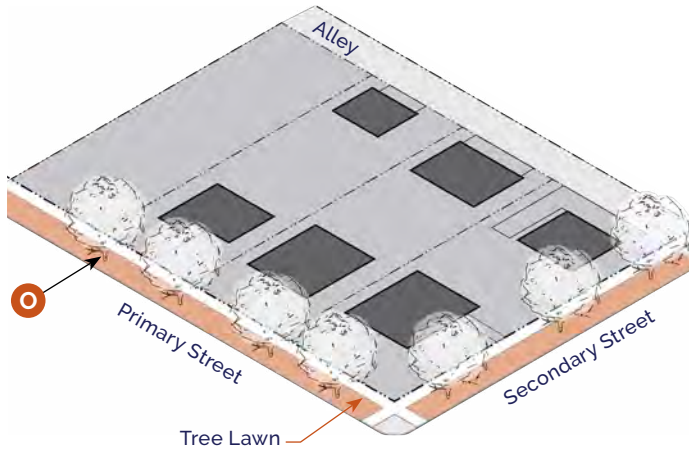

Street Trees Allowed

(j) Landscape

Streetscape Trees Required

Shade Tree ¹	1 tree min. per each full 30' of street frontage	O
Location ²	Tree Lawn	
Spacing	Evenly spaced to extent possible	

Foundation Landscape Required ³

Front & Corner Facades Over 35' Wide	1 shrub per 5' of facade min.
Location	Directly adjacent to facade

Parking Lot Screening (of 4 or more spaces)

Parking that is visible from a street/open space, other than an alley, shall be screened by a Type 1 buffer.

Parking that is visible from a side/rear lot line abutting a S1, U1, or U2 district shall be screened by a Type 1 or 2 buffer.

Buffers shall comply with [Section 21-09.01\(o\)](#).

See [Section 21-09.01](#) for full landscape requirements.

¹ An existing tree of at least 1.75" caliper may fulfill this requirement.

² If a tree cannot be placed in a tree lawn, then required trees may be located in a front or corner established yard.

³ Residential buildings with 4 or fewer units are exempt from foundation landscape requirements.

Signs

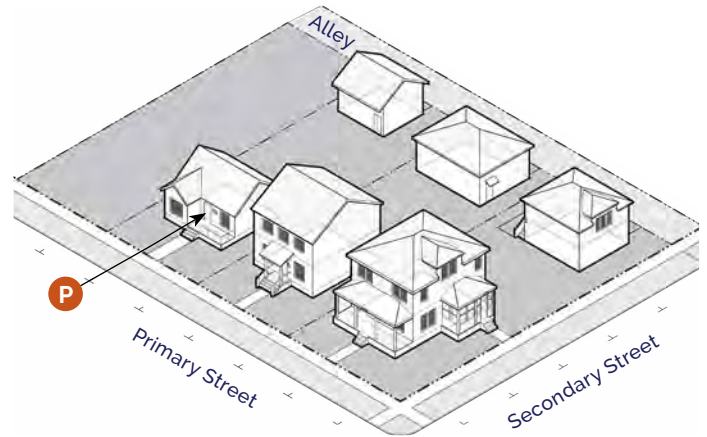

(k) Signs

Total Signs Allowed

Residential		P
Building or Freestanding Sign	1 per street frontage; up to 2 square feet and 4 feet in height	
Non-Residential Use		
Building Sign	Up to 5% of the total area of the building facade	
Freestanding Sign	1 per street frontage; up to 32 square feet and 6 feet in height	

Freestanding signs may be located in a required setback, provided they are at least 5' from a lot line.

See [Section 21-10](#) for full sign requirements including changeable copy signs, temporary signs, exempt signs, off-premise, and use-specific signs.



Section 21-03.04: U2 Urban Neighborhood 2

(a) Intent

The U2 District is established to provide for, promote, and maintain the development of diverse housing types in urban neighborhoods located near neighborhood centers in both core and outlying areas of the City.

The following are typical characteristics of the U2 District:

- Primarily for single and two unit residential development, allowing up to four units and the addition of ancillary dwelling units to help meet the demand for affordable, urban living
- Buildings with modest setbacks and inviting building frontages, primarily of stoops and porches, that create a consistent block face along smaller city blocks
- Detached garages accessed from an alley
- Pedestrian-oriented scale with sidewalks and regularly spaced street trees

(b) Building Types

The following building types are permitted in the U2 District:

- | | |
|------------------|-------------------|
| ■ Carriage House | ■ Duplex |
| ■ Detached House | ■ Townhouse |
| ■ Cottage Court | ■ Apartment House |

The names of the building types are not intended to limit or expand uses allowed within the building. See [Section 21-08.02](#) for building type descriptions and regulations.

Limited public and institutional uses shall be incorporated at a scale and character compatible with the surrounding neighborhood.

Uses

(c) Principal Uses	Use Definition & Standards
Agricultural	
Community Garden	■ * 21-06.01(e)(2)
Civic & Institutional	
Assembly, Neighborhood	■ * 21-06.01(f)(1)
Cemetery	■ 21-06.01(f)(3)
College/University	■ 21-06.01(f)(4)
Library/Museum/Cultural Facility	■ * 21-06.01(f)(7)
Parks & Open Space	■ 21-06.01(f)(8)
Police/Fire Facilities	■ 21-06.01(f)(9)
Religious Institutions	■ 21-06.01(f)(10)
School, Pre-K/Primary/Secondary	■ 21-06.01(f)(11)
Lodging	
Bed & Breakfast	■ * 21-06.01(h)(1)
Residential	
Dwelling, Ancillary	■ * 21-06.01(j)(1)
Dwelling, 1 Unit	■ 21-06.01(j)(2)
Dwelling, 2 Units	■ 21-06.01(j)(3)
Dwelling, Multi-Unit	■ * 21-06.01(j)(5)
Group Residence, State Regulated	■ 21-06.01(j)(7)
Residential Care Facility	■ 21-06.01(j)(8)
Retail & Service	
Day Care Center	■ 21-06.01(k)(6)
Entertainment/Recreation Facility, Outdoor	■ 21-06.01(k)(9)
Funeral Services	■ 21-06.01(k)(10)
Transportation	
Parking Lot	■ * 21-06.01(l)(4)
Utilities	
Solar Farm	■ 21-06.01(m)(1)
Utilities, Major	■ * 21-06.01(m)(2)
Utilities, Minor	■ * 21-06.01(m)(3)
Wireless Communications	■ * 21-06.01(m)(4)

See [Section 21-06.02](#) for accessory use standards.

Key ■ Allowed ■ Allowed subject to Conditions ■ Special Exception * Use Specific Standards

Building Placement

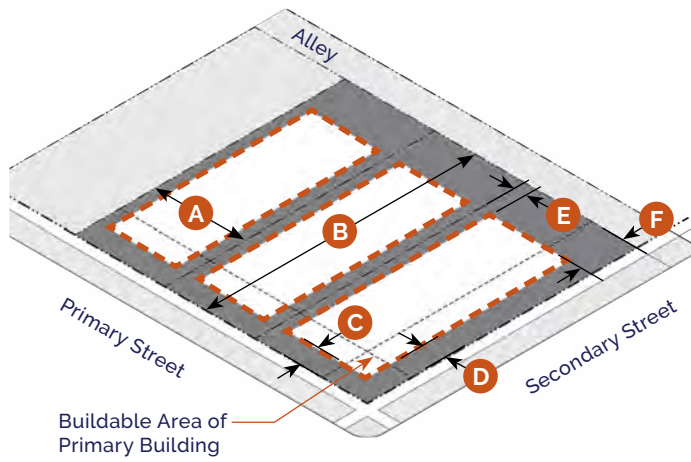

- Minimum Setback Line
- Maximum Setback Line

(d) Building Placement				
Lot Size				
Lot Width	15' min.			A
Lot Depth	60' min.			B
Building Setbacks	Front¹	Corner	Side²	Rear
	C	D	E	F
Residential (min.)	15'	10'	5'	20'
Residential (max.)	25'	25'	-	-
Non-Residential (min.)	15'	10'	20'	20'
Facade within Setback Zone				
Front (min.)	65%			
Corner (min.)	50%			
Building Coverage				
Building Coverage	60% max.			

¹ Where existing buildings on a block face are not consistent with the required setbacks, any new building may apply the contextual setback per Section 21-02.03(b).

² Side setback not required between attached dwellings.

Access & Parking

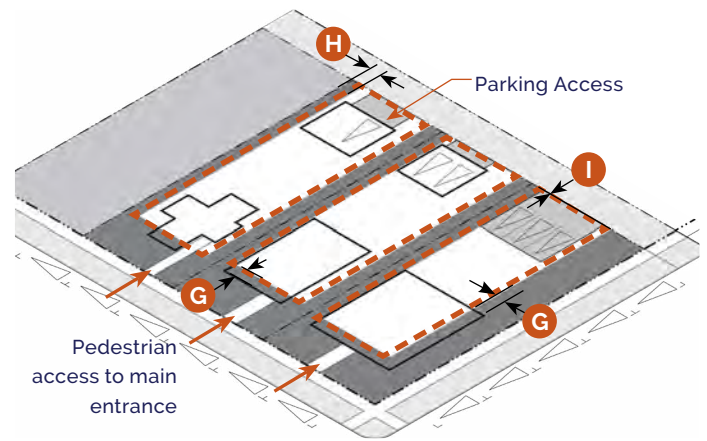

- Minimum Parking Lot Setback

(e) Access & Parking		
Pedestrian Access		
A walkway shall connect the sidewalk or driveway to the main entrance.		
Bicycle Access		
See Section 21-07.02 for Bicycle Parking requirements.		
Parking Access		
If access is available from an alley which is open to traffic, there shall be no access allowed from the street. If allowed, a maximum of one curb cut is permitted per street frontage.		
A garage facing a street shall be set back not less than 18'.		
A garage facing an alley shall be set back 5' from rear lot line or not less than 18'.		
Parking Lot Location (Distance from Lot Line)		
Front & Corner Setback (min.)	5' behind facade, or 12' if no building	G
Side & Rear Setback (min.)	5'	H
Side and rear setback shall be 0' when abutting an alley.		I
Required Spaces		
Off-street parking areas are not required for any use.		
Any off-street parking areas provided, even though not required, shall be developed in compliance with the standards set forth in Section 21-07.03.		
See Section 21-07 for full access and parking requirements.		

Building Form

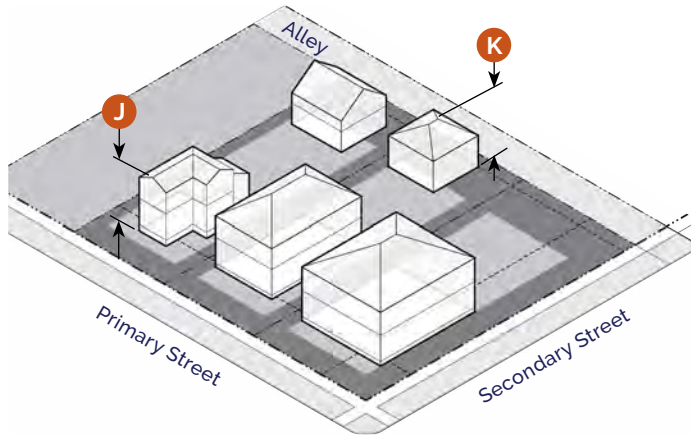

(f) Building Form

Building Height

Primary Building (max.)	35' and 2.5 stories ¹	J
Accessory Building (max.) ²	18'	K

Accessory buildings, except for ancillary dwelling units, shall not be taller than the primary building on a lot.

Building Orientation

Primary facades shall be oriented to a front lot line or open space.

¹ Apartment Houses may be built to a maximum height of 3 stories if building width is 30' or less.

² Ancillary dwelling units may be built to a maximum height of 26' if located at least 5' from the rear lot line of a lot with a rear alley or at least 20' from the rear lot line of a lot without a rear alley.

Building Components

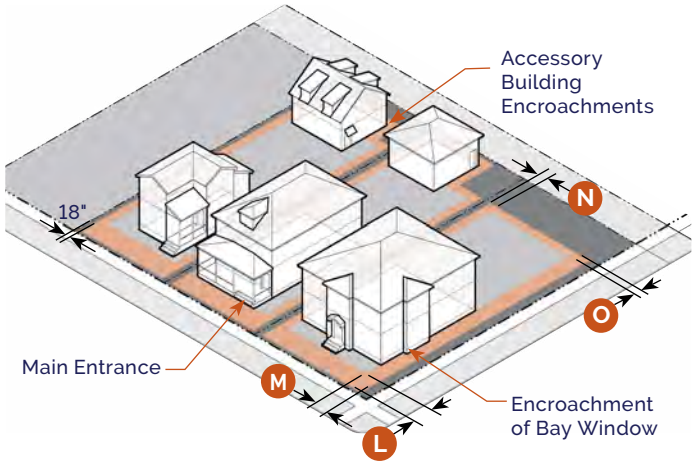

Encroachment Zone

(g) Building Components

Allowed Building Frontage Types

Porch	21-08.03(c)
Stoop	21-08.03(d)
Gallery	21-08.03(e)

Building Entrance

The main entrance shall be located on the front facade, on the corner facade, or on the side facade within 20' of the front facade.

Allowed Encroachments (max.)	Front L	Corner M	Side N	Rear O
Architectural Features	3'	3'	3'	3'
Building Frontage Type	5'	5'	<input type="checkbox"/>	<input type="checkbox"/>
Balcony	5'	5'	<input type="checkbox"/>	5'
Bay Window (< 10' wide)	3'	3'	3'	3'
Patio & Decks (under 30")	8'	8'	<input checked="" type="checkbox"/>	<input checked="" type="checkbox"/>

Building components shall be at least 18" from any lot line.

See [Section 21-08.01\(g\)](#) for building component definitions and additional requirements.

Key Allowed Not Allowed

Building Standards

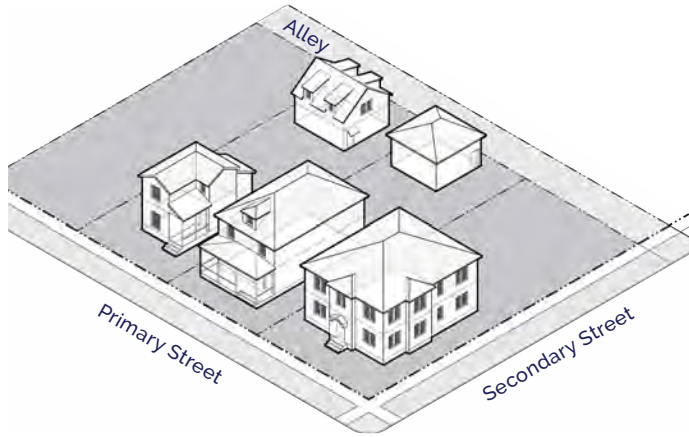

Site Development

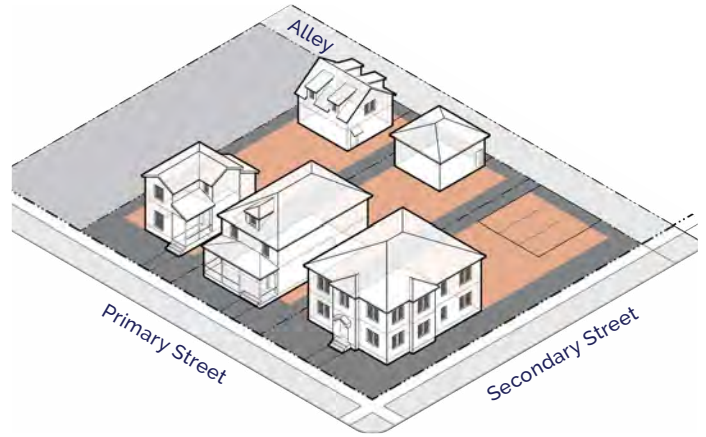

(h) Building Standards

Facade Transparency (min.)	
Ground Floor - Front & Corner Facade	15%
Upper Floor - Front & Corner Facade	15%

Building Materials

There are no restrictions on building materials for residential buildings within the U2 district.

See [Section 21-08.01\(e\)](#) for building material restrictions that shall apply to any non-residential building.

See [Section 21-08](#) for full building standards.

(i) Site Development

Accessory Structures/Uses	
Accessory Structures	21-06.02(f)(1)
Mechanical/HVAC	21-06.02(f)(14)
Satellite Dish Antennas	21-06.02(f)(22)
Swimming Pool/Hot Tubs	21-06.02(f)(26)

Allowed Location in Established Yards

Accessory structures shall not be located in any established front or corner yard.

Accessory structures shall comply with all required setbacks but may encroach into a required rear setback up to 5' of the lot line.

See [Section 21-06.02](#) for full accessory use regulations.

Fence/Freestanding Walls	Front	Corner	Side	Rear
Height (max.)	3'	3'	6'	6'

A fence up to 4' is allowed in an established front or corner yard if fence is greater than 50% open.

See [Section 21-09](#) for full site development requirements.

Landscape

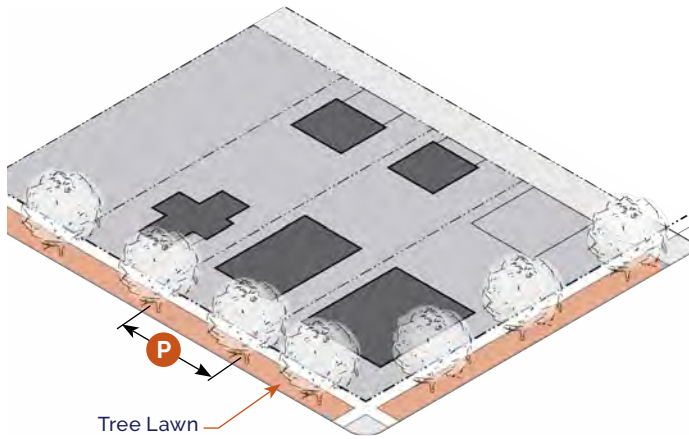

Street Trees Allowed

(j) Landscape

Streetscape Trees Required

Shade Tree ¹	1 tree min. per each full 30' of street frontage	P
Location ²	Tree Lawn	
Spacing	Evenly spaced to extent possible	

Foundation Landscape Required ³

Front & Corner Facades Over 35' Wide	1 shrub per 5' of facade min.
Location	Directly adjacent to facade

Parking Lot Screening (of 4 or more spaces)

Parking that is visible from a street/open space, other than an alley, shall be screened by a Type 1 buffer.

Parking that is visible from a side/rear lot line abutting a S1, U1, or U2 district shall be screened by a Type 1 or 2 buffer.

Buffers shall comply with [Section 21-09.01\(o\)](#).

See [Section 21-09.01](#) for full landscape requirements.

¹ An existing tree of at least 1.75" caliper may fulfill this requirement.

² If a tree cannot be placed in a tree lawn, then required trees may be located in a front or corner established yard.

³ Residential buildings with 4 or fewer units are exempt from foundation landscape requirements.

Signs

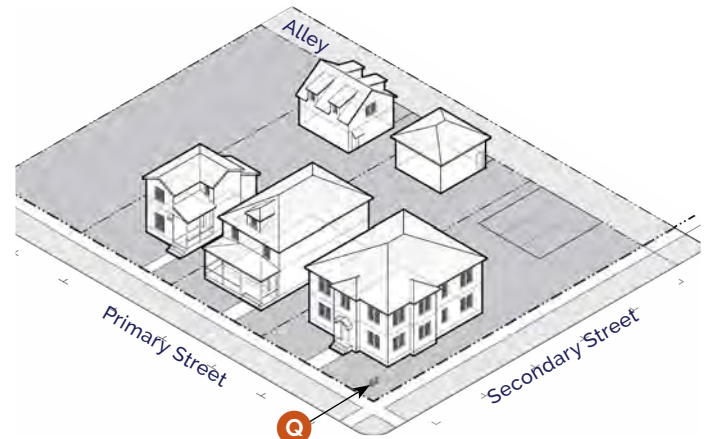

(k) Signs

Total Signs Allowed

Residential		Q
Building or Freestanding Sign	1 per street frontage; up to 2 square feet and 4 feet in height	

Non-Residential Use

Building Sign	Up to 5% of the total area of the building facade
Freestanding Sign	1 per street frontage; up to 32 square feet and 6 feet in height

Freestanding signs may be located in a required setback, provided they are at least 5' from a lot line.

See [Section 21-10](#) for full sign requirements including changeable copy signs, temporary signs, exempt signs, off-premise, and use-specific signs.



Section 21-03.05: U3 Urban Neighborhood 3

(a) Intent

The U3 District is established to provide for, promote, and maintain the development of a full range of housing types located near neighborhood centers and along major streets in urban neighborhoods in core and outlying areas of the City.

The following are typical characteristics of the U3 District:

- Single unit, two unit, and multi-unit residential development, together with ancillary dwelling units, that provides a diversity of housing choices with a range of unit size and affordability
- Buildings with modest setbacks and inviting building frontages, primarily of stoops and porches, that create a consistent block face along smaller city blocks
- Detached garages or shared parking areas accessed from an alley
- Pedestrian-oriented scale with sidewalks and regularly spaced street trees

(b) Building Types

The following building types are permitted in the U3 District:

- | | |
|------------------|-------------------|
| ■ Carriage House | ■ Townhouse |
| ■ Detached House | ■ Apartment House |
| ■ Cottage Court | ■ Stacked Flats |
| ■ Duplex | |

The names of the building types are not intended to limit or expand uses allowed within the building. See [Section 21-08.02](#) for building type descriptions and regulations.

Limited public and institutional uses shall be incorporated at a scale and character compatible with the surrounding neighborhood.

Uses

(c) Principal Uses	Use Definition & Standards
Agricultural	
Community Garden	■ * 21-06.01(e)(2)
Civic & Institutional	
Assembly, Neighborhood	■ * 21-06.01(f)(1)
Cemetery	■ 21-06.01(f)(3)
College/University	■ 21-06.01(f)(4)
Library/Museum/Cultural Facility	■ * 21-06.01(f)(7)
Parks & Open Space	■ 21-06.01(f)(8)
Police/Fire Facilities	■ 21-06.01(f)(9)
Religious Institutions	■ 21-06.01(f)(10)
School, Pre-K/Primary/Secondary	■ 21-06.01(f)(11)
Lodging	
Bed & Breakfast	■ * 21-06.01(h)(1)
Residential	
Dwelling, Ancillary	■ * 21-06.01(j)(1)
Dwelling, 1 Unit	■ 21-06.01(j)(2)
Dwelling, 2 Units	■ 21-06.01(j)(3)
Dwelling, Multi-Unit	■ 21-06.01(j)(5)
Group Residence	■ 21-06.01(j)(6)
Group Residence, State Regulated	■ 21-06.01(j)(7)
Residential Care Facility	■ 21-06.01(j)(8)
Shared Housing	■ 21-06.01(j)(9)
Retail & Service	
Day Care Center	■ 21-06.01(k)(6)
Entertainment/Recreation Facility, Outdoor	■ 21-06.01(k)(9)
Funeral Services	■ 21-06.01(k)(10)

(c) Principal Uses (continued)	Use Definition & Standards
Transportation	
Parking Lot	■ * 21-06.01(l)(4)
Utilities	
Solar Farm	■ 21-06.01(m)(1)
Utilities, Major	■ * 21-06.01(m)(2)
Utilities, Minor	■ * 21-06.01(m)(3)
Wireless Communications	■ * 21-06.01(m)(4)
See Section 21-06.02 for accessory use standards.	

Key ■ Allowed ■ Allowed subject to Conditions ■ Special Exception * Use Specific Standards

Building Placement

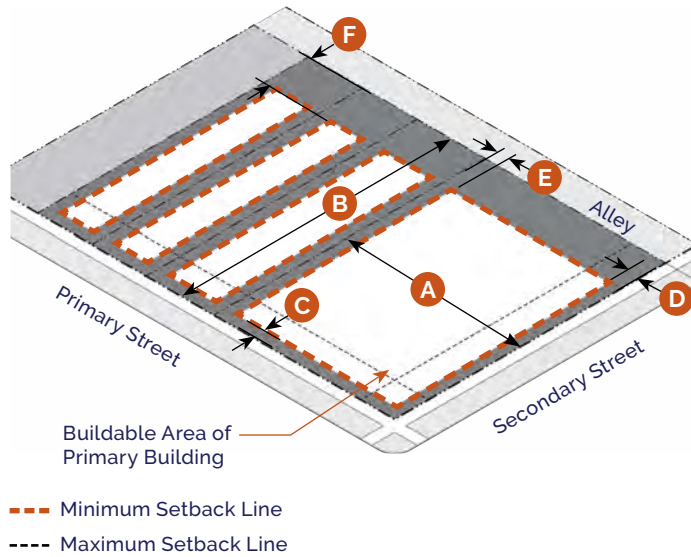

(d) Building Placement

Lot Size				
Lot Width		15' min.		A
Lot Depth		60' min.		B
Building Setbacks	Front ¹	Corner	Side ²	Rear
	C	D	E	F
Residential (min.)	5'	5'	5'	20'
Residential (max.)	15'	15'	-	-
Non-Residential (min.)	5'	5'	20'	20'
Facade within Setback Zone				
Front (min.) ³		65%		
Corner (min.)		50%		
Building Coverage				
Building Coverage		60% max.		

¹ Where existing buildings on a block face are not consistent with the required setbacks, any new building may apply the contextual setback per [Section 21-02.03\(b\)](#).

² Side setback not required between attached dwellings.

³ A forecourt per [Section 21-08.03\(f\)](#) may be exempt from this requirement with approval by the Zoning Administrator.

Access & Parking

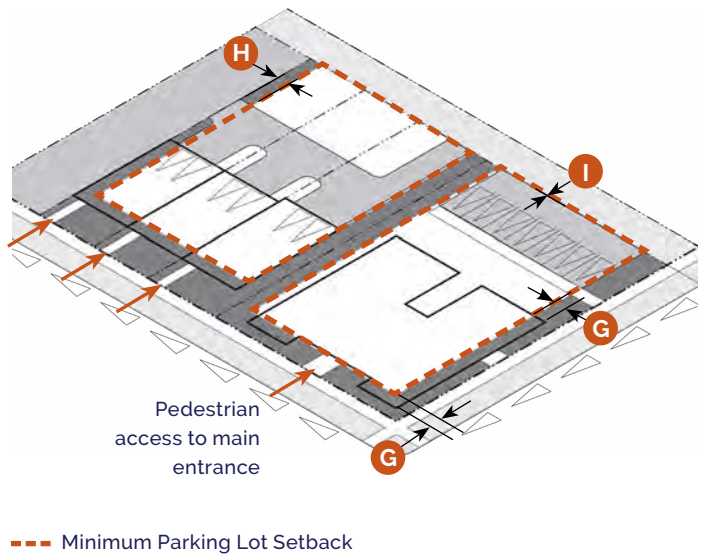

(e) Access & Parking

Pedestrian Access	
A walkway shall connect the sidewalk to the main entrance.	
Bicycle Access	
See Section 21-07.02 for Bicycle Parking requirements.	
Parking Access	
If access is available from an alley which is open to traffic, there shall be no access allowed from the street.	
If allowed, a maximum of one street curb cut is permitted per street frontage.	
Parking Lot Location (Distance from Lot Line)	
Front & Corner Setback (min.)	5' behind facade, G or 12' if no building
Side & Rear Setback (min.)	5' H
Side and rear setback shall be 0' when abutting an alley.	I
Required Spaces	
Off-street parking areas are not required for any use.	
Any off-street parking areas provided, even though not required, shall be developed in compliance with the standards set forth in Section 21-07.03 .	
See Section 21-07 for full access and parking requirements.	

Building Form

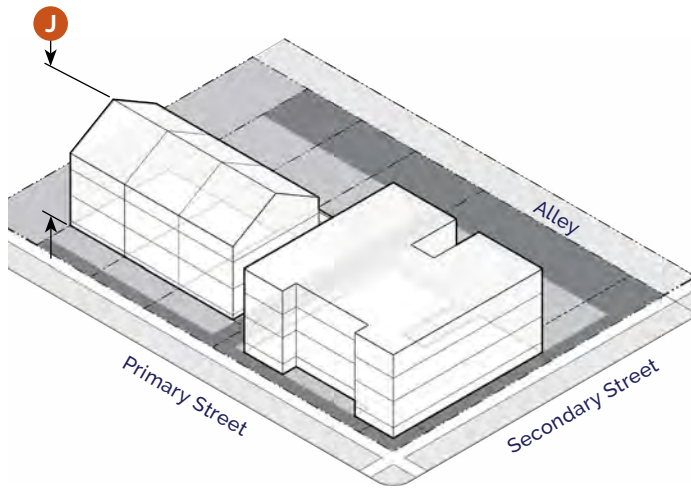

Required Setback

(f) Building Form

Building Height

Primary Building (max.) ¹	55' and 4 stories	J
Accessory Building (max.)	26'	

Accessory buildings, except for ancillary dwelling units, shall not be taller than the primary building on a lot.

Building Orientation

Primary facades shall be oriented to a front lot line or open space.

¹ Portions of a primary building in excess of 40' or 3 stories shall be located at least 40' from a S1, U1, or U2 District.

Building Components

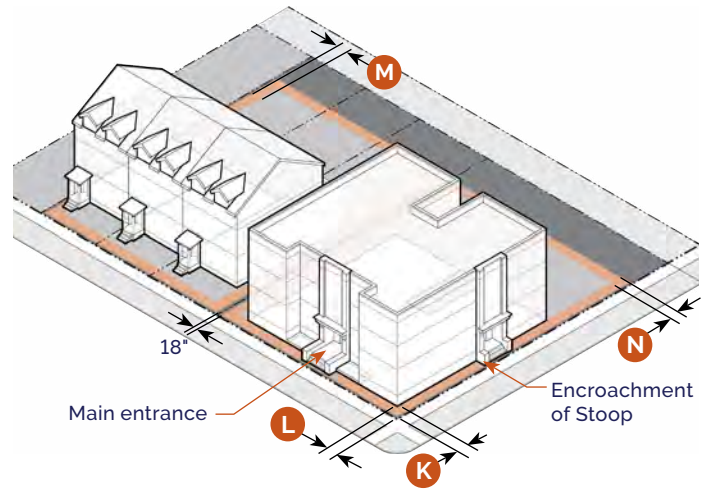

Encroachment Zone

(g) Building Components

Allowed Building Frontage Types

Porch	21-08.03(c)
Stoop	21-08.03(d)
Gallery	21-08.03(e)
Forecourt	21-08.03(f)

Building Entrance

Main entrances shall be prominently located and visible from the primary street or open space.

Allowed Encroachments (max.)	Front K	Corner L	Side M	Rear N
Architectural Features	3'	3'	3'	3'
Building Frontage Type	3'	3'	<input type="checkbox"/>	<input type="checkbox"/>
Balcony	3'	3'	<input type="checkbox"/>	3'
Bay Window (< 10' wide)	3'	3'	3'	3'
Patio & Decks (under 30")	3'	3'	<input checked="" type="checkbox"/>	<input checked="" type="checkbox"/>

Building components shall be at least 18" from any lot line.

See Section [21-08.01\(g\)](#) for building component definitions and additional requirements.

Key Allowed Not Allowed

Building Standards

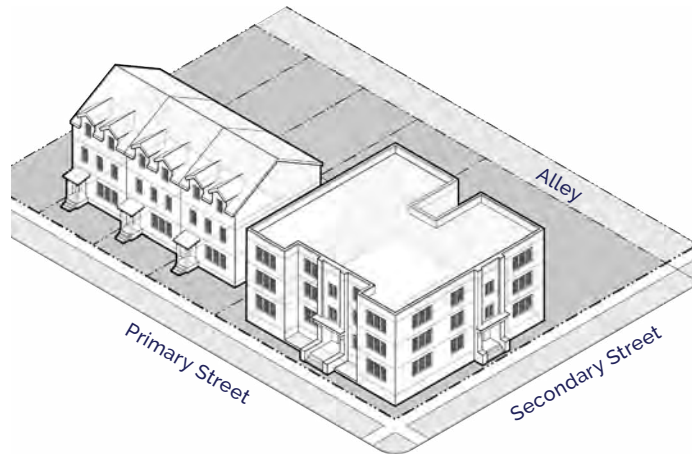

Site Development

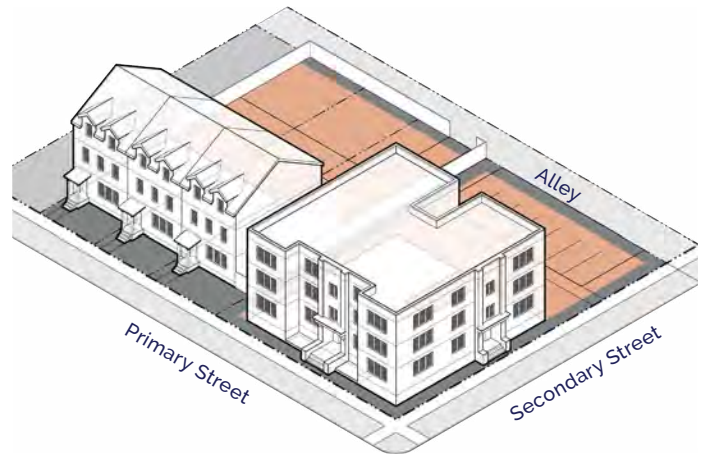

 Accessory Structures Allowed

(h) Building Standards		(i) Site Development				
Facade Transparency (min.)		Accessory Structures/Uses				
Ground Floor - Front & Corner Facade	15%	Accessory Structures	21-06.02(f)(1)			
Upper Floor - Front & Corner Facade	15%	Mechanical/HVAC	21-06.02(f)(14)			
Building Materials		Satellite Dish Antennas	21-06.02(f)(22)			
Restrictions on building materials shall apply to all front and corner facades of residential buildings with 5 or more units and non-residential buildings.		Swimming Pool/Hot Tubs	21-06.02(f)(26)			
Building materials used on the front and corner facades shall extend a minimum depth of 16" along the side facade.		Trash/Recycling Container	21-06.02(f)(27)			
E.I.F.S. is not permitted on the ground floor except as trim.		Allowed Location in Established Yards				
Standard, fluted, or split face concrete masonry units above the basement level are prohibited as face material.		Accessory structures shall not be located in any established front or corner yard.				
Unfinished metal, plywood, unfinished precast or poured-in-place concrete are prohibited.		Accessory structures shall comply with all required setbacks but may encroach into a required rear setback up to 5' of the lot line.				
Commercial-grade/scale products are prohibited on any residential building facade.		See Section 21-06.02 for full accessory use regulations.				
Windows and doors on a ground floor front/corner facade shall have clear, transparent glass that has a min. VLT of 50% and a max. VLR of 25%.		Fence/Freestanding Walls	Front	Corner	Side	Rear
See Section 21-08 for full building standards.		Height (max.)	3'	3'	6'	6'
		A fence up to 4' is allowed in an established front or corner yard if fence is greater than 50% open.				
		See Section 21-09 for full site development requirements.				

Landscape

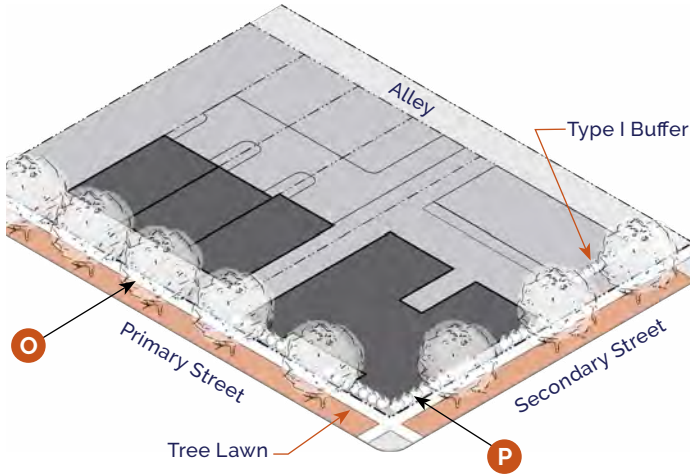

Street Trees Allowed

(j) Landscape

Streetscape Trees Required

Shade Tree ¹	1 tree min. per each full 30' of street frontage	O
Location ²	Tree Lawn	
Spacing	Evenly spaced to extent possible	

Foundation Landscape Required ³

Front & Corner Facades Over 35' Wide	1 shrub per 5' of facade min.	P
Location	Directly adjacent to facade	

Parking Lot Screening (of 4 or more spaces)

Parking that is visible from a street/open space, other than an alley, shall be screened by a Type 1 buffer.

Parking that is visible from a side/rear lot line abutting a S1, U1, or U2 district shall be screened by a Type 1 or 2 buffer.

Buffers shall comply with [Section 21-09.01\(o\)](#).

See [Section 21-09.01](#) for full landscape requirements.

¹ An existing tree of at least 1.75" caliper may fulfill this requirement.

² If a tree cannot be placed in a tree lawn, then required trees may be located in a front or corner established yard.

³ Residential buildings with 4 or fewer units are exempt from foundation landscape requirements.

Signs

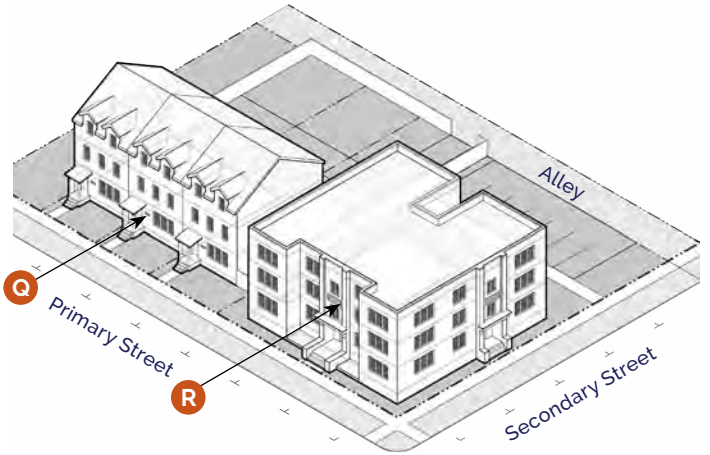

(k) Signs

Total Signs Allowed

Residential: 4 or fewer dwellings		
Building or Freestanding Sign	1 per street frontage; up to 2 square feet and 4 feet in height	Q
Residential: 5+ dwelling units		
Building or Freestanding Sign	1 per street frontage; up to 32 square feet and 6 feet in height	R

Non-Residential Use

Building Sign	Up to 5% of the total area of the building facade	
Freestanding Sign	1 per street frontage; up to 32 square feet and 6 feet in height	

Freestanding signs may be located in a required setback, provided they are at least 5' from a lot line.

See [Section 21-10](#) for full sign requirements including changeable copy signs, temporary signs, exempt signs, off-premise, and use-specific signs.



Section 21-03.06: UF Urban Neighborhood Flex

(a) Intent

The UF District is established to enhance and support a full range of housing types and small-scale commercial uses, found outside neighborhood centers in both core and outlying areas of the City.

The following are typical characteristics of the UF District:

- A mixture of residential development, including single unit, two unit, multi-unit, and ancillary dwelling units that maintains neighborhood stability.
- Integrates limited small-scale office, commercial, and institutional uses that are compatible with the scale and character of the neighborhood
- Buildings with smaller setbacks create a consistent block face along smaller city blocks
- Detached garages or shared parking areas accessed from an alley
- Pedestrian-oriented scale with sidewalks and regularly spaced street trees

(b) Building Types

The following building types are permitted in the UF District:

- | | |
|------------------|-------------------|
| ■ Carriage House | ■ Townhouse |
| ■ Detached House | ■ Apartment House |
| ■ Cottage Court | ■ Stacked Flats |
| ■ Duplex | ■ Shop |

The names of the building types are not intended to limit or expand uses allowed within the building. See [Section 21-08.02](#) for building type descriptions and regulations.

Limited public and institutional uses shall be incorporated at a scale and character compatible with the surrounding neighborhood.

Uses

(c) Principal Uses	Use Definition & Standards
Agricultural	
Community Garden	■ * 21-06.01(e)(2)
Civic & Institutional	
Assembly, Neighborhood	■ * 21-06.01(f)(1)
Cemetery	■ 21-06.01(f)(3)
College/University	■ 21-06.01(f)(4)
Library/Museum/Cultural Facility	■ * 21-06.01(f)(7)
Parks & Open Space	■ 21-06.01(f)(8)
Police/Fire Facilities	■ 21-06.01(f)(9)
Religious Institutions	■ 21-06.01(f)(10)
School, Pre-K/Primary/Secondary	■ 21-06.01(f)(11)
Lodging	
Bed & Breakfast	■ * 21-06.01(h)(1)
Hotel	■ * 21-06.01(h)(2)
Office	
Professional Offices	■ 21-06.01(i)(1)
Residential	
Dwelling, Ancillary	■ * 21-06.01(j)(1)
Dwelling, 1 Unit	■ 21-06.01(j)(2)
Dwelling, 2 Units	■ 21-06.01(j)(3)
Dwelling, Multi-Unit	■ 21-06.01(j)(5)
Group Residence	■ 21-06.01(j)(6)
Group Residence, State Regulated	■ 21-06.01(j)(7)
Residential Care Facility	■ 21-06.01(j)(8)
Shared Housing	■ 21-06.01(j)(9)

(c) Principal Uses (continued)	Use Definition & Standards
Retail & Service	
Animal Care Establishment	■ * 21-06.01(k)(2)
Bar/Tavern	■ 21-06.01(k)(3)
Day Care Center	■ 21-06.01(k)(6)
Entertainment/Recreation Facility, Outdoor	■ 21-06.01(k)(9)
Funeral Services	■ 21-06.01(k)(10)
Medical/Dental Clinic	■ 21-06.01(k)(12)
Personal Care & Services	■ 21-06.01(k)(13)
Private Club/Lodge	■ 21-06.01(k)(14)
Restaurant	■ 21-06.01(k)(15)
Retail & Service, General	■ 21-06.01(k)(16)
Transportation	
Parking Lot	■ * 21-06.01(l)(4)
Utilities	
Solar Farm	■ 21-06.01(m)(1)
Utilities, Major	■ * 21-06.01(m)(2)
Utilities, Minor	■ * 21-06.01(m)(3)
Wireless Communications	■ * 21-06.01(m)(4)
See Section 21-06.02 for accessory use standards.	

Key ■ Allowed ■ Allowed subject to Conditions ■ Special Exception * Use Specific Standards

Building Placement

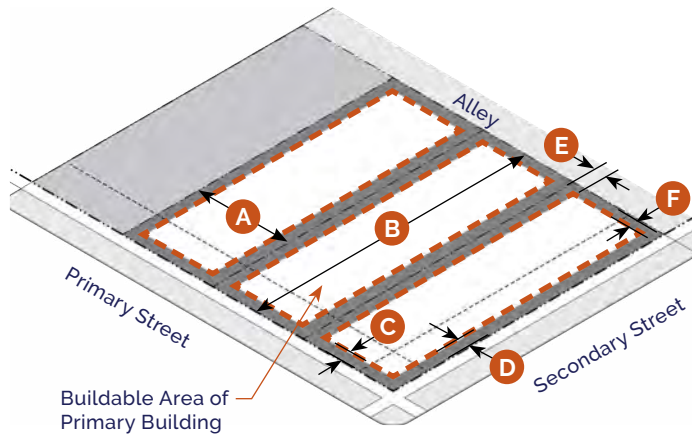

- Minimum Setback Line
- Maximum Setback Line

(d) Building Placement				
Lot Size				
Lot Width	15' min.			A
Lot Depth	60' min.			B
Building Setbacks	Front	Corner	Side¹	Rear²
	C	D	E	F
All Uses (min.)	5'	5'	5'	5'
All Uses (max.)	15'	15'	-	-
Facade within Setback Zone				
Front (min.) ³	65%			
Corner (min.)	50%			
Building Coverage				
Building Coverage	100% max.			

¹ Side setback not required between attached dwellings.
² Primary buildings on a lot without a rear alley shall have a minimum rear setback of 20' when adjacent to a lot with a ground floor residential use.
³ A forecourt per [Section 21-08.03\(f\)](#) may be exempt from this requirement with approval by the Zoning Administrator.

Access & Parking

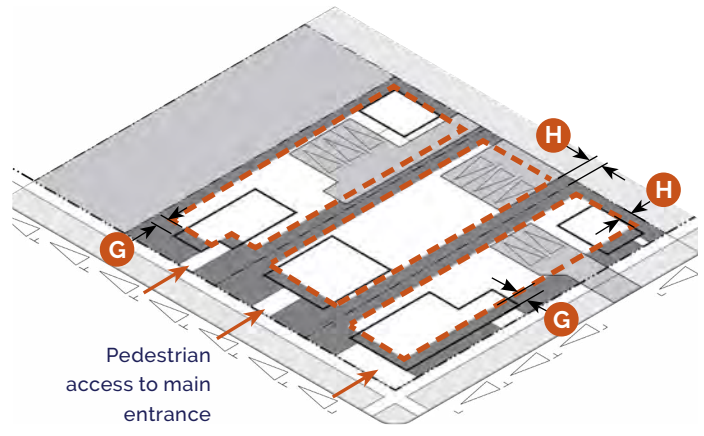

- Minimum Parking Lot Setback

(e) Access & Parking	
Pedestrian Access	
A walkway shall connect the sidewalk to the main entrance.	
Bicycle Access	
See Section 21-07.02 for Bicycle Parking requirements.	
Parking Access	
If access is available from an alley which is open to traffic, there shall be no access allowed from the street.	
If allowed, a maximum of one street curb cut is permitted per street frontage.	
Parking Lot Location (Distance from Lot Line)	
Front & Corner Setback (min.)	5' behind facade, or 12' if no building G
Side & Rear Setback	5' H
Side and rear setback shall be 0' when abutting an alley.	
Required Spaces	
Off-street parking areas are not required for any use. Any off-street parking areas provided, even though not required, shall be developed in compliance with the standards set forth in Section 21-07.03 .	
See Section 21-07 for full access and parking requirements.	

Building Form

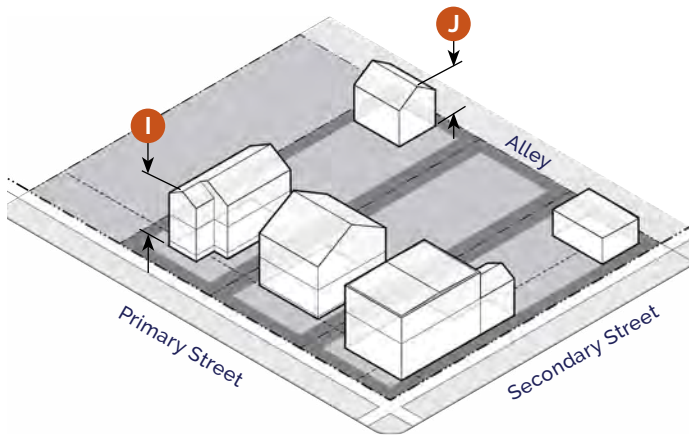

(f) Building Form

Building Height		
Primary Building (max.) ¹	55' and 4 stories	I
Accessory Building (max.)	26'	J

Building Orientation
 Primary facades shall be oriented to a front lot line or open space.

Building Design	
Total Non-Residential or Non-Civic Use (max.)	5,000 square feet

¹ Portions of a primary building in excess of 40' or 3 stories shall be located at least 40' from a S1, U1, or U2 District.

Building Components

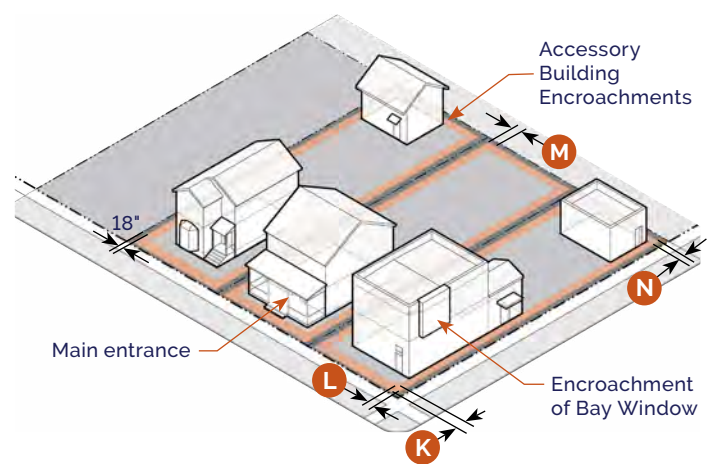

Encroachment Zone

(g) Building Components

Allowed Building Frontage Types	
Porch	21-08.03(c)
Stoop	21-08.03(d)
Gallery	21-08.03(e)
Forecourt	21-08.03(f)
Storefront	21-08.03(g)
Terrace	21-08.03(h)

Building Entrance

Main entrances shall be prominently located and visible from the primary street or open space.

Allowed Encroachments (max.)	Front	Corner	Side	Rear
	K	L	M	N
Architectural Features	3'	3'	3'	3'
Building Frontage Type	3'	3'	☐	☐
Balcony	3'	3'	☐	3'
Bay Window (< 10' wide)	3'	3'	3'	3'
Patio & Decks (under 30")	3'	3'	■	■

Building components shall be at least 18" from any lot line.

See [Section 21-08.01\(g\)](#) for building component definitions and additional requirements.

Key ■ Allowed ☐ Not Allowed

Building Standards

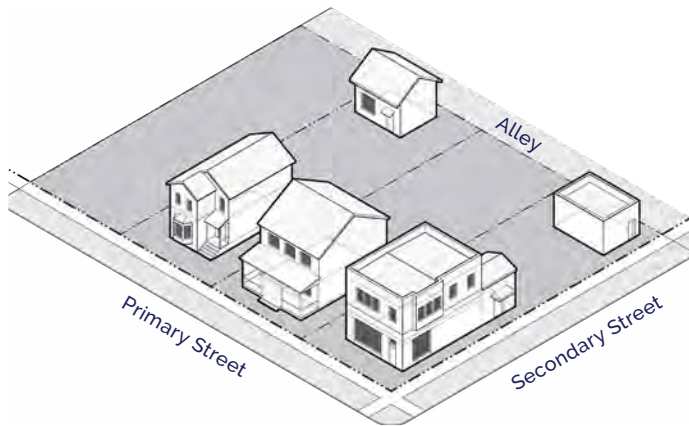

Site Development

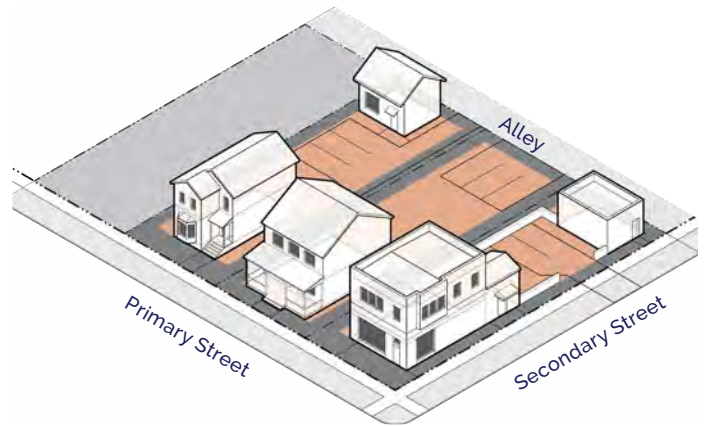

 Accessory Structures Allowed

(h) Building Standards

Facade Transparency (min.)

Ground Floor - Front & Corner Facade	15%
Upper Floor - Front & Corner Facade	15%

Building Materials

Restrictions on building materials shall apply to all front and corner facades of residential buildings with 5 or more units and non-residential buildings.

Building materials used on the front and corner facades shall extend a minimum depth of 16" along the side facade.

E.I.F.S. is not permitted on the ground floor except as trim.

Standard, fluted, or split face concrete masonry units above the basement level are prohibited as face material.

Unfinished metal, plywood, unfinished precast or poured-in-place concrete are prohibited.

Commercial-grade/scale products are prohibited on any residential building facade.

Windows and doors on a ground floor front/corner facade shall have clear, transparent glass that has a min. VLT of 50% and a max. VLR of 25%.

See [Section 21-08](#) for full building standards.

(i) Site Development

Accessory Structures/Uses

Accessory Structures	21-06.02(f)(1)
Mechanical/HVAC	21-06.02(f)(14)
Satellite Dish Antennas	21-06.02(f)(22)
Swimming Pool/Hot Tubs	21-06.02(f)(26)
Trash/Recycling Container	21-06.02(f)(27)

Allowed Location in Established Yards

Accessory structures shall not be located in any established front or corner yard and shall comply with all required setbacks.

See [Section 21-06.02](#) for full accessory use regulations.

Fence/Freestanding Walls	Front	Corner	Side	Rear
Height (max.)	3'	3'	8'	8'

A fence up to 4' is allowed in an established front or corner yard if fence is greater than 50% open.

See [Section 21-09](#) for full site development requirements.

Landscape

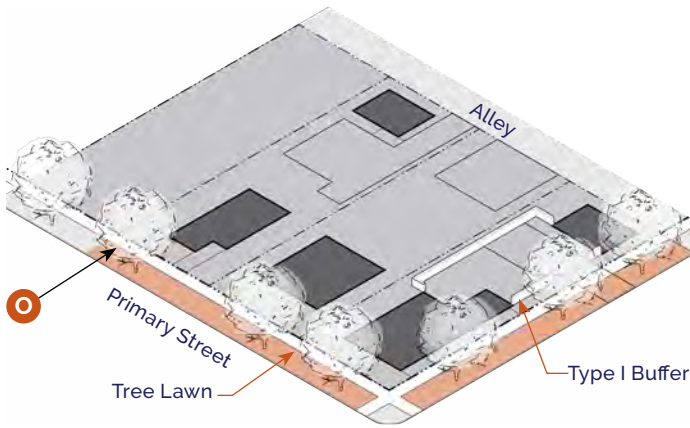

Street Trees Allowed

(j) Landscape

Streetscape Trees Required

Shade Tree ¹	1 tree min. per each full 30' of street frontage	O
Location ²	Tree lawn	
Spacing	Evenly spaced to extent possible	

Foundation Landscape Required ³

Front & Corner Facades Over 35' Wide	1 shrub per 5' of facade min.
Location	Directly adjacent to facade

Buffer Landscape Required ³

Adjacent to S1 or S2	Type 3 buffer if no street or alley
----------------------	-------------------------------------

Parking Lot Screening (of 4 or more spaces)

Parking that is visible from a street/open space, other than an alley, shall be screened by a Type 1 buffer.

Parking that is visible from a side/rear lot line abutting a S1, U1, or U2 district shall be screened by a Type 1 or 2 buffer.

Buffers shall comply with [Section 21-09.01\(o\)](#).

See [Section 21-09.01](#) for full landscape requirements.

¹ An existing tree of at least 1.75" caliper may fulfill this requirement.

² If a tree cannot be placed in a tree lawn, then required trees may be located in a front or corner established yard.

³ Residential buildings with 4 or fewer units are exempt from foundation and buffer landscape requirements.

Signs

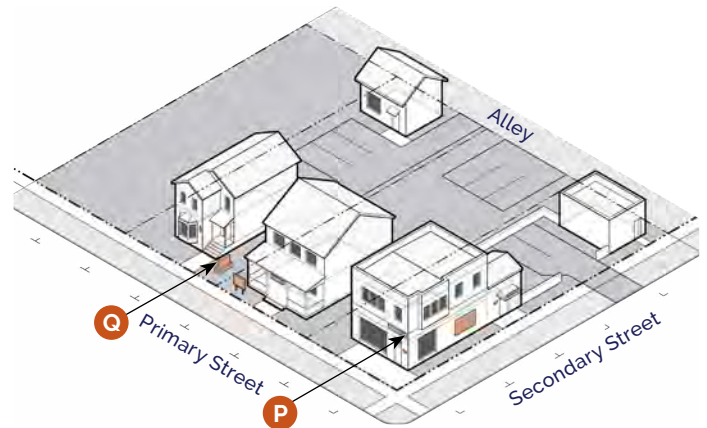

(k) Signs

Total Signs Allowed

Residential: 4 or fewer dwellings	
Building or Freestanding Sign	1 per street frontage; up to 2 square feet and 4 feet in height

Residential: 5+ dwelling units

Building or Freestanding Sign	1 per street frontage; up to 32 square feet and 6 feet in height
-------------------------------	--

Non-Residential Use

Building Sign	Up to 5% of the total area of the building facade	P
Freestanding Sign	1 per street frontage; up to 32 square feet and 8 feet in height	Q

Freestanding signs may be located in a required setback, provided they are at least 5' from a lot line.

See [Section 21-10](#) for full sign requirements including changeable copy signs, temporary signs, exempt signs, off-premise, and use-specific signs.



Section 21-03.07: NC Neighborhood Center

(a) Intent

The NC District is established to promote the development of higher intensity, urban neighborhood centers, typically located near the intersection of major streets, in core and outlying areas of the City. The NC District is well connected to surrounding residential neighborhoods.

The following are typical characteristics of the NC District:

- A mixture of storefront retail, professional offices, and dwelling units located in townhouses, apartment buildings, and in the upper stories or rear of mixed-use buildings
- Buildings with active building facades set at or close to the sidewalk
- Pedestrian-oriented scale with wide sidewalks and regularly spaced street trees that creates a walkable environment

(b) Building Types

The following building types are permitted in the NC District:

- Carriage House
- Townhouse
- Apartment House
- Stacked Flats
- Shop

The names of the building types are not intended to limit or expand uses allowed within the building. See [Section 21-08.02](#) for building type descriptions and regulations.

Uses

(c) Principal Uses	Use Definition & Standards
Agricultural	
Community Garden	■ * 21-06.01(e)(2)
Civic & Institutional	
Assembly, Neighborhood	■ * 21-06.01(f)(1)
Assembly, General	■ 21-06.01(f)(2)
College/University	■ 21-06.01(f)(4)
Hospital	■ 21-06.01(f)(6)
Library/Museum/Cultural Facility	■ 21-06.01(f)(7)
Parks & Open Space	■ 21-06.01(f)(8)
Police/Fire Facilities	■ 21-06.01(f)(9)
Religious Institutions	■ 21-06.01(f)(10)
School, Pre-K/Primary/Secondary	■ 21-06.01(f)(11)
Industrial, Manufacturing, & Processing	
Industrial, Artisan	■ * 21-06.01(g)(1)
Research/Laboratory Facility	■ 21-06.01(g)(4)
Lodging	
Bed & Breakfast	■ * 21-06.01(h)(1)
Hotel	■ * 21-06.01(h)(2)
Office	
Professional Offices	■ 21-06.01(i)(1)
Residential	
Dwelling, Ancillary	■ * 21-06.01(j)(1)
Dwelling, 1 Unit	■ * 21-06.01(j)(2)
Dwelling, 2 Units	■ * 21-06.01(j)(3)
Dwelling, Multi-Unit	■ 21-06.01(j)(5)
Group Residence	■ 21-06.01(j)(6)
Group Residence, State Regulated	■ 21-06.01(j)(7)
Residential Care Facility	■ 21-06.01(j)(8)
Shared Housing	■ 21-06.01(j)(9)

(c) Principal Uses (continued)	Use Definition & Standards
Retail & Service	
Animal Care Establishment	■ * 21-06.01(k)(2)
Bar/Tavern	■ 21-06.01(k)(3)
Beer/Wine/Liquor Sales	■ 21-06.01(k)(4)
Commercial School	■ 21-06.01(k)(5)
Day Care Center	■ 21-06.01(k)(6)
Drive-Through Facility	■ * 21-06.01(k)(7)
Entertainment/Recreation Facility, Indoor	■ 21-06.01(k)(8)
Entertainment/Recreation Facility, Outdoor	■ 21-06.01(k)(9)
Funeral Services	■ 21-06.01(k)(10)
Gas/Fuel Station	■ * 21-06.01(k)(11)
Medical/Dental Clinic	■ 21-06.01(k)(12)
Personal Care & Services	■ 21-06.01(k)(13)
Private Club/Lodge	■ 21-06.01(k)(14)
Restaurant	■ 21-06.01(k)(15)
Retail & Service, General	■ 21-06.01(k)(16)
Self-Storage Facility	■ * 21-06.01(k)(18)
Tattoo/Piercing Parlor	■ 21-06.01(k)(19)
Tobacco/Hookah/Vaping	■ 21-06.01(k)(20)
Vehicle Sales or Rental	■ * 21-06.01(k)(21)
Vehicle Service, Major	■ * 21-06.01(k)(22)
Vehicle Service, Minor	■ * 21-06.01(k)(23)
Transportation	
Parking Lot	■ * 21-06.01(l)(4)
Passenger Terminal	■ 21-06.01(l)(5)
Transit Station	■ 21-06.01(l)(6)
Utilities	
Solar Farm	■ 21-06.01(m)(1)
Utilities, Major	■ * 21-06.01(m)(2)
Utilities, Minor	■ * 21-06.01(m)(3)
Wireless Communications	■ * 21-06.01(m)(4)

See [Section 21-06.02](#) for accessory use standards.

Key ■ Allowed ■ Allowed subject to Conditions ■ Special Exception * Use Specific Standards

Building Placement

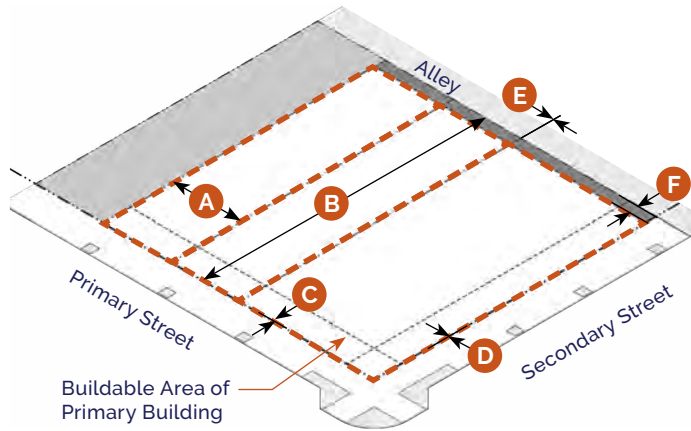

- Minimum Setback Line
- Maximum Setback Line

(d) Building Placement				
Lot Size				
Lot Width	15' min.			A
Lot Depth	60' min.			B
Building Setbacks	Front	Corner	Side¹	Rear²
	C	D	E	F
All Uses (min.)	0'	0'	0'	5'
All Uses (max.)	12'	12'	-	-
Facade within Setback Zone				
Front (min.) ³	85%			
Corner (min.)	50%			
Building Coverage				
Building Coverage	100% max.			

¹ If side setback is provided, it shall be a min. of 5'.
² Primary buildings on a lot without a rear alley shall have a minimum rear setback of 20' when adjacent to a lot with a ground floor residential use.
³ A forecourt per [Section 21-08.03\(f\)](#) may be exempt from this requirement with approval by the Zoning Administrator.

Access & Parking

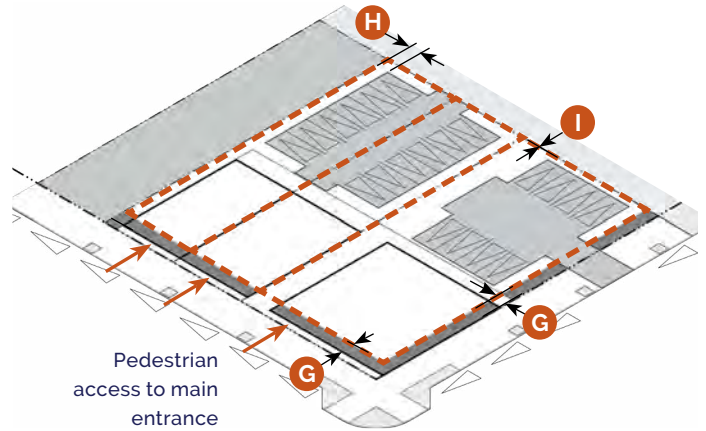

- Minimum Parking Lot Setback

(e) Access & Parking	
Pedestrian Access	
A walkway shall connect the sidewalk to the main entrance.	
Bicycle Access	
See Section 21-07.02 for Bicycle Parking requirements.	
Parking Access	
If access is available from an alley which is open to traffic, there shall be no access allowed from the street.	
If allowed, a maximum of one street curb cut is permitted per street frontage.	
Parking Lot Location (Distance from Lot Line)	
Front & Corner Setback (min.)	5' behind facade, G or 12' if no building
Side & Rear Setback	5' H
Side and rear setback shall be 0' when abutting an alley.	I
Required Spaces	
Off-street parking areas are not required for any use.	
Any off-street parking areas provided, even though not required, shall be developed in compliance with the standards set forth in Section 21-07.03 .	
See Section 21-07 for full access and parking requirements.	

Building Form

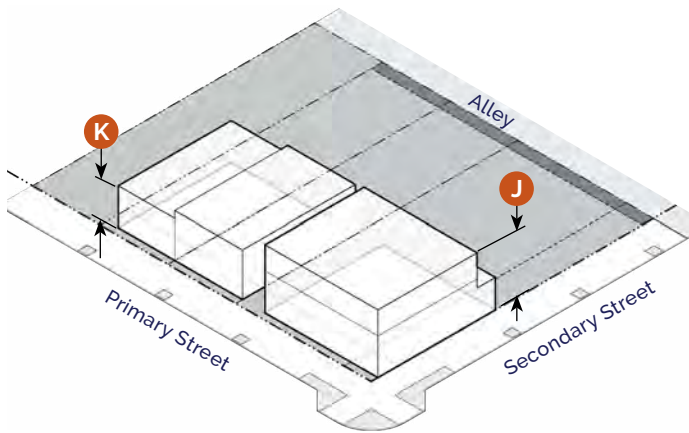

Building Components

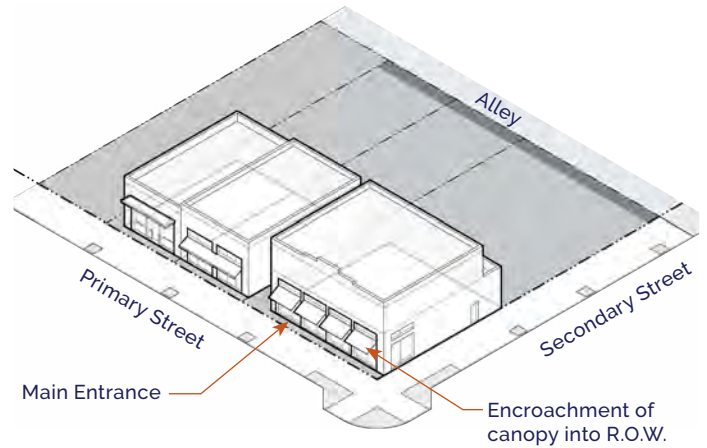

(f) Building Form		
Building Height		
Primary Building (max.) ¹	55' and 4 stories	J
Primary Front Facade (min.)	16'	K
Accessory Building (max.)	26'	
Building Orientation		
Primary facades shall be oriented to a front lot line or open space.		

¹ Portions of a primary building in excess of 40' or 3 stories shall be located at least 40' from a S1, U1, or U2 District.

(g) Building Components	
Allowed Building Frontage Types	
Porch	21-08.03(c)
Stoop	21-08.03(d)
Gallery	21-08.03(e)
Forecourt	21-08.03(f)
Storefront	21-08.03(g)
Terrace	21-08.03(h)
Building Entrance	
Distance between Entries	100' max.
Main entrances shall be prominently located and visible from the primary street or open space.	
Allowed Encroachments	
Building components may extend into a right-of-way with approval by the Board of Public Works.	

See [Section 21-08.01\(g\)](#) for building component definitions and additional requirements.

Key Allowed Not Allowed

Building Standards

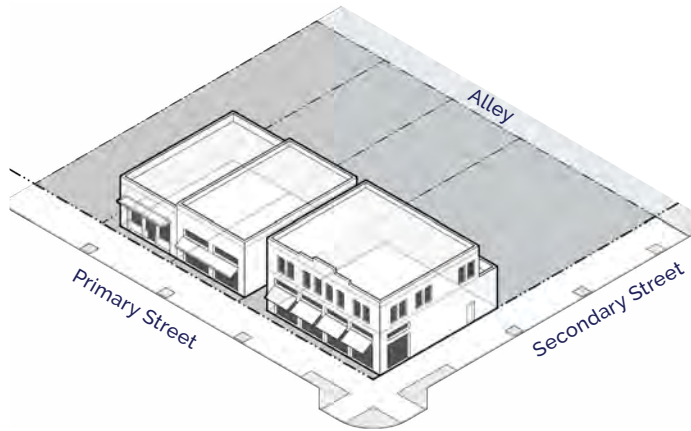

Site Development

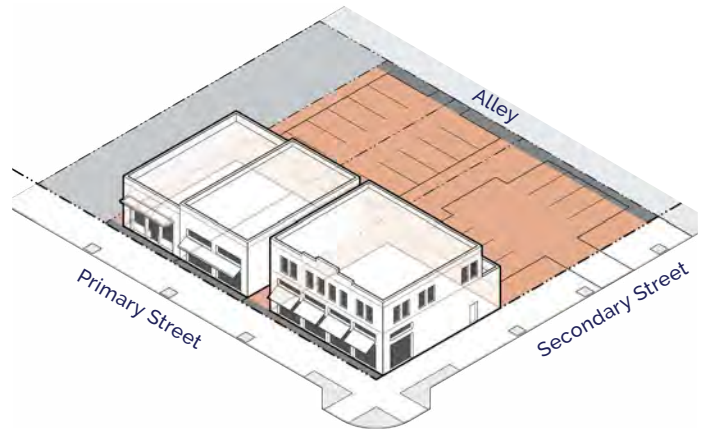

 Accessory Structures Allowed

(h) Building Standards	
Facade Transparency (min.)	
Ground Floor - Front Facade	
Non-Residential	60%
Residential	25%
Ground Floor - Corner Facade	
	20%
Upper Floor - Front & Corner Facade	
	15%
Facade Articulation	
Any building greater than 50' wide shall provide vertical articulation into segments no greater than 32' in width and horizontal articulation (base, belt courses, cornice, etc.) to distinguish the ground floor from upper stories.	
Building Materials	
A minimum of 66% of each front or corner facade shall be constructed of high quality, durable, natural materials, such as stone or brick; wood lap siding; lapped, shingled, or panel fiber cement board siding; and glass. High quality synthetic materials may be approved by the Zoning Administrator.	
Each front or corner facade shall include at least two architectural elements (e.g., quoins, pilasters, soldier courses, lintels, friezes, cornices, dentils, architraves, etc.).	
See Section 21-08.01(e) for all building material standards.	
See Section 21-08 for full building standards.	

(i) Site Development	
Accessory Structures/Uses	
Accessory Structures	21-06.02(f)(1)
Mechanical/HVAC	21-06.02(f)(14)
Satellite Dish Antennas	21-06.02(f)(22)
Trash/Recycling Container	21-06.02(f)(27)
Allowed Location in Established Yards	
Accessory structures shall not be located in any established front or corner yard and shall comply with all required setbacks.	
Mechanical equipment and HVAC shall be allowed in front or corner yard if screened per Section 21-06.02(f)(14) .	
See Section 21-06.02 for full accessory use regulations.	
Fence/Freestanding Walls	Front Corner Side Rear
Height (max.)	3' 3' 8' 8'
A fence up to 4' is allowed in an established front or corner yard if fence is greater than 50% open.	
See Section 21-09 for full site development requirements.	

Landscape

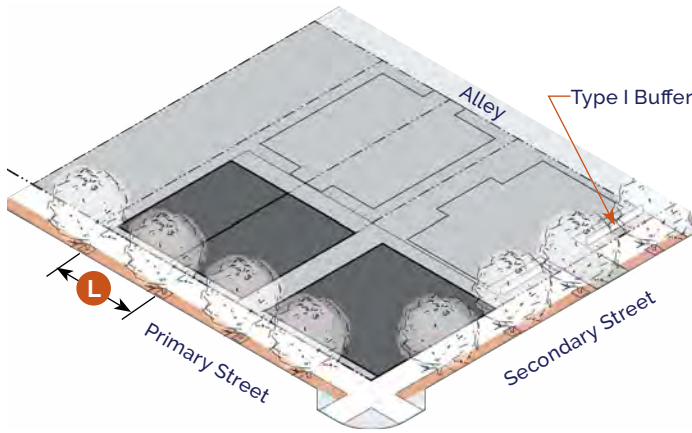

Signs

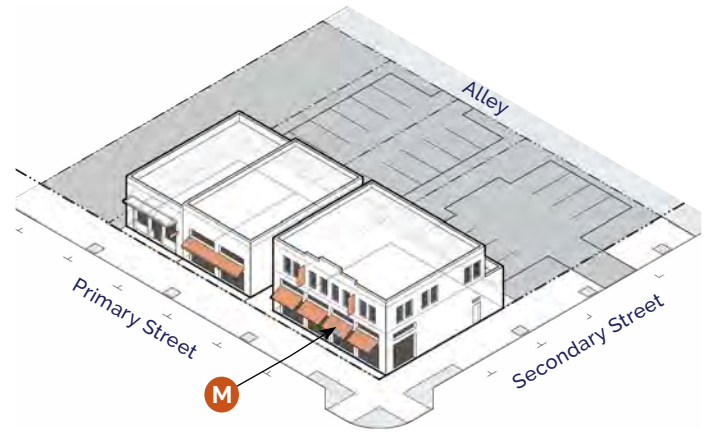

Street Trees Allowed

(j) Landscape	
Streetscape Trees Required	
Shade Tree ¹	1 tree min. per each full 30' of street frontage L
Location ²	Tree lawn or tree grates along curb line
Spacing	Evenly spaced to extent possible
Buffer Landscape Required ³	
Adjacent to S1 or S2	Type 3 buffer if no street or alley
Parking Lot Screening (of 4 or more spaces)	
Parking that is visible from a street/open space, other than an alley, shall be screened by a Type 1 buffer.	
Parking that is visible from a side/rear lot line abutting a S1, U1, or U2 district shall be screened by a Type 1 or 2 buffer.	
Buffers shall comply with Section 21-09.01(o) .	
See Section 21-09.01 for full landscape requirements.	
¹ An existing tree of at least 1.75" caliper may fulfill this requirement.	
² If a tree cannot be placed in a tree lawn, an alternate location may be approved by the Zoning Administrator.	
³ Residential buildings with 4 or fewer units are exempt from buffer landscape requirements.	

(k) Signs	
Total Signs Allowed	
Residential: 4 or fewer dwellings	
Building or Freestanding Sign	1 per street frontage; up to 2 square feet and 4 feet in height
Residential: 5+ dwelling units	
Building Sign	Up to 10% of the total area of the building facade
Freestanding Sign	1 per street frontage; up to 32 square feet and 8 feet in height
Non-Residential Use	
Building Sign	Up to 10% of the total area of the building facade M
Freestanding Sign	1 per street frontage; up to 32 square feet and 8 feet in height
See Section 21-10 for full sign requirements including changeable copy signs, temporary signs, exempt signs, off-premise, and use-specific signs.	



Section 21-03.08: DT Downtown

(a) Intent

The DT District is established to promote the development of the downtown region of the City of South Bend as a high intensity urban center for a multi-county region.

The following are typical characteristics of the DT District:

- A mixture of mid-rise and high rise mixed-use developments, including a variety of compatible building types and urban uses
- Buildings with active building frontages set at or close to the sidewalk
- Pedestrian-oriented scale with wide sidewalks, regularly spaced street trees, and amenities that create a walkable environment

(b) Building Types

The following building types are permitted in the DT District:

- Townhouse
- Apartment House
- Stacked Flats
- Shop
- Mid-Rise/Tower

The names of the building types are not intended to limit or expand uses allowed within the building. See [Section 21-08.02](#) for building type descriptions and regulations.

Uses

(c) Principal Uses	Use Definition & Standards
Agricultural	
Community Garden	■ * 21-06.01(e)(2)
Civic & Institutional	
Assembly, Neighborhood	■ * 21-06.01(f)(1)
Assembly, General	■ 21-06.01(f)(2)
College/University	■ 21-06.01(f)(4)
Hospital	■ 21-06.01(f)(6)
Library/Museum/Cultural Facility	■ 21-06.01(f)(7)
Parks & Open Space	■ 21-06.01(f)(8)
Police/Fire Facilities	■ 21-06.01(f)(9)
Religious Institutions	■ 21-06.01(f)(10)
School, Pre-K/Primary/Secondary	■ 21-06.01(f)(11)
Industrial, Manufacturing, & Processing	
Industrial, Artisan	■ * 21-06.01(g)(1)
Research/Laboratory Facility	■ 21-06.01(g)(4)
Lodging	
Bed & Breakfast	■ * 21-06.01(h)(1)
Hotel	■ * 21-06.01(h)(2)
Office	
Professional Offices	■ 21-06.01(i)(1)
Residential	
Dwelling, Ancillary	■ * 21-06.01(j)(1)
Dwelling, 1 Unit	■ * 21-06.01(j)(2)
Dwelling, 2 Units	■ * 21-06.01(j)(3)
Dwelling, Multi-Unit	■ 21-06.01(j)(5)
Group Residence	■ 21-06.01(j)(6)
Group Residence, State Regulated	■ 21-06.01(j)(7)
Residential Care Facility	■ 21-06.01(j)(8)
Shared Housing	■ 21-06.01(j)(9)

(c) Principal Uses (continued)	Use Definition & Standards
Retail & Service	
Animal Care Establishment	■ * 21-06.01(k)(2)
Bar/Tavern	■ 21-06.01(k)(3)
Beer/Wine/Liquor Sales	■ 21-06.01(k)(4)
Commercial School	■ 21-06.01(k)(5)
Day Care Center	■ 21-06.01(k)(6)
Drive-Through Facility	■ * 21-06.01(k)(7)
Entertainment/Recreation Facility, Indoor	■ 21-06.01(k)(8)
Entertainment/Recreation Facility, Outdoor	■ 21-06.01(k)(9)
Funeral Services	■ 21-06.01(k)(10)
Gas/Fuel Station	■ * 21-06.01(k)(11)
Medical/Dental Clinic	■ 21-06.01(k)(12)
Personal Care & Services	■ 21-06.01(k)(13)
Private Club/Lodge	■ 21-06.01(k)(14)
Restaurant	■ 21-06.01(k)(15)
Retail & Service, General	■ 21-06.01(k)(16)
Self-Storage Facility	■ * 21-06.01(k)(18)
Tattoo/Piercing Parlor	■ 21-06.01(k)(19)
Tobacco/Hookah/Vaping	■ 21-06.01(k)(20)
Vehicle Sales or Rental	■ * 21-06.01(k)(21)
Vehicle Service, Major	■ * 21-06.01(k)(22)
Vehicle Service, Minor	■ * 21-06.01(k)(23)
Transportation	
Heliport	■ 21-06.01(l)(3)
Parking Lot	■ * 21-06.01(l)(4)
Passenger Terminal	■ 21-06.01(l)(5)
Transit Station	■ 21-06.01(l)(6)
Utilities	
Solar Farm	■ 21-06.01(m)(1)
Utilities, Major	■ * 21-06.01(m)(2)
Utilities, Minor	■ * 21-06.01(m)(3)
Wireless Communications	■ * 21-06.01(m)(4)

See [Section 21-06.02](#) for accessory use standards.

Key ■ Allowed ■ Allowed subject to Conditions ■ Special Exception * Use Specific Standards

Building Placement

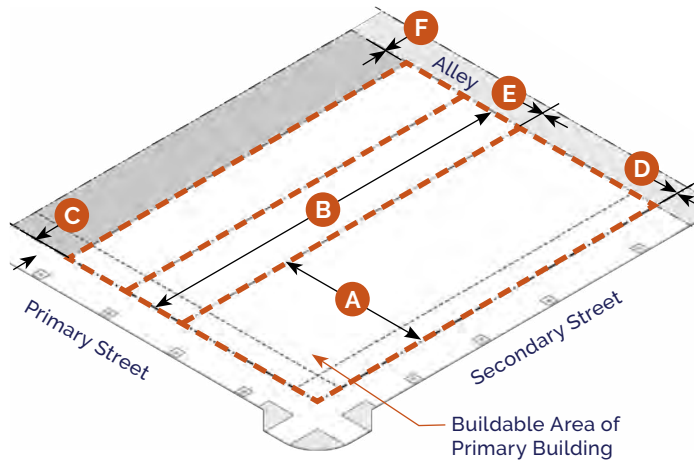

- Minimum Setback Line
- Maximum Setback Line

(d) Building Placement				
Lot Size				
Lot Width	15' min.			A
Lot Depth	60' min.			B
Building Setbacks	Front	Corner	Side¹	Rear²
	C	D	E	F
All Uses (min.)	0'	0'	0'	0'
All Uses (max.)	10'	10'	-	-
St. Joseph River/East Race	15' min.			
Facade within Setback Zone				
Front (min.) ³	85%			
Corner (min.)	50%			
Building Coverage				
Building Coverage	100% max.			

¹ If side or rear setback is provided, it shall be a min. of 5'.
² Primary buildings on a lot without a rear alley shall have a minimum rear setback of 20' when adjacent to a lot with a ground floor residential use that is not in a DT district.
³ A forecourt per Section 21-08.03(f) may be exempt from this requirement with approval by the Zoning Administrator.

Access & Parking

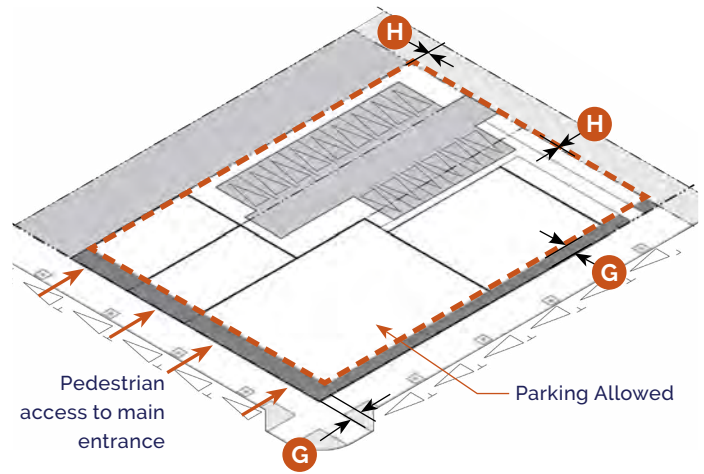

- Minimum Parking Lot Setback

(e) Access & Parking	
Pedestrian Access	
A walkway shall connect the sidewalk to the main entrance.	
Bicycle Access	
See Section 21-07.02 for Bicycle Parking requirements.	
Parking Access	
If access is available from an alley which is open to traffic, there shall be no access allowed from the street.	
If allowed, a maximum of one street curb cut is permitted per street frontage.	
Parking Lot Location (Distance from Lot Line)	
Front & Corner Setback (min.)	5' behind facade, G or 10' if no building
Side & Rear Setback	0' H
Required Spaces	
Off-street parking areas are not required for any use. Any off-street parking areas provided, even though not required, shall be developed in compliance with the standards set forth in Section 21-07.03.	
See Section 21-07 for full access and parking requirements.	

Building Form

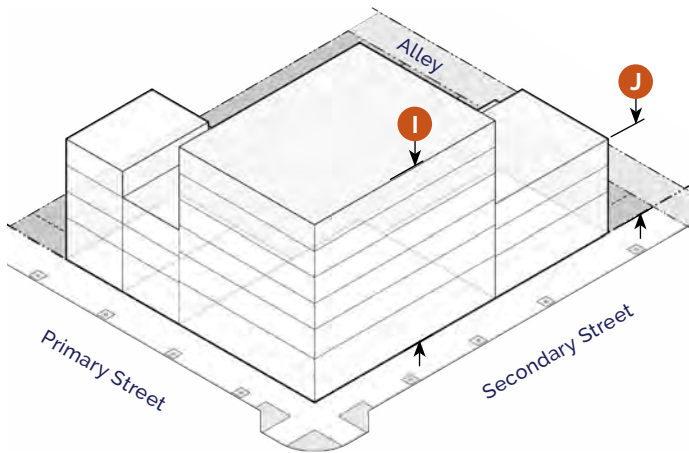

Building Components

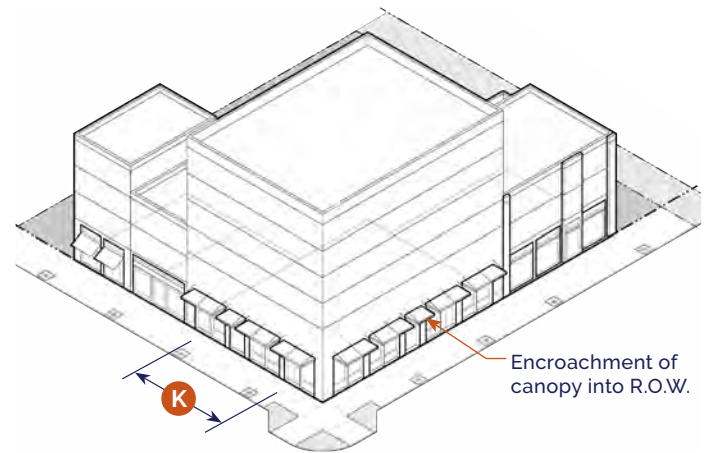

(f) Building Form		
Building Height		
Primary Building (max.)		
West of the St. Joseph River	150' and 12 stories	
Between St. Joseph River and East Race Waterway	150' and 12 stories	I
East of the East Race Waterway	60' and 5 stories	
Primary Front Facade (min.)	16'	J
Accessory Building (max.)	26'	
Building Orientation		
Primary facades shall be oriented to a front lot line or open space.		

(g) Building Components		
Allowed Building Frontage Types		
Porch	21-08.03(c)	
Stoop	21-08.03(d)	
Gallery	21-08.03(e)	
Forecourt	21-08.03(f)	
Storefront	21-08.03(g)	
Terrace	21-08.03(h)	
Building Entrance		
Distance between Entries	100' max.	K
Main entrances shall be prominently located and visible from the primary street or open space.		
Allowed Encroachments		
Building components may extend into a right-of-way with approval by the Board of Public Works.		
See Section 21-08.01(g) for building component definitions and additional requirements.		

Key Allowed Not Allowed

Building Standards

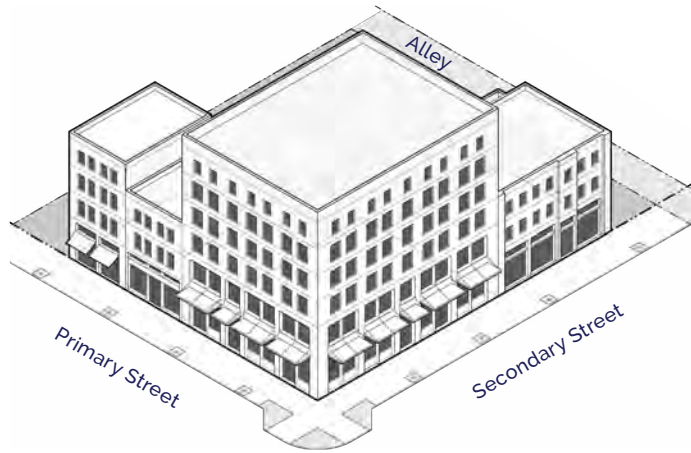

Site Development

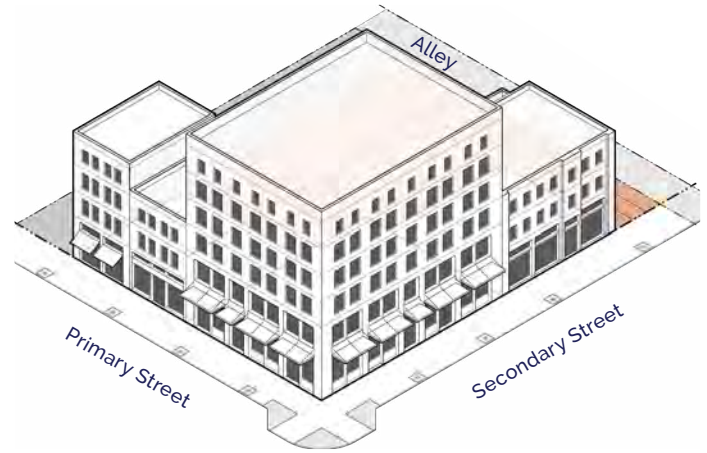

(h) Building Standards	
Facade Transparency (min.)	
Ground Floor - Front & Corner Facade	
Non-Residential	60%
Residential	25%
Upper Floor - Front & Corner Facade	
	15%
Facade Articulation	
Any building greater than 50' wide shall provide vertical articulation into segments no greater than 32' in width and horizontal articulation (base, belt courses, cornice, etc.) to distinguish the ground floor from upper stories.	
Building Materials	
A minimum of 66% of each front or corner facade shall be constructed of high quality, durable, natural materials, such as stone or brick; wood lap siding; lapped, shingled, or panel fiber cement board siding; and glass. High quality synthetic materials may be approved by the Zoning Administrator.	
Each front or corner facade shall include at least two architectural elements (e.g., quoins, pilasters, soldier courses, lintels, friezes, cornices, dentils, architraves, etc.).	
See Section 21-08.01(e) for all building material standards.	
See Section 21-08 for full building standards.	

(i) Site Development	
Accessory Structures/Uses	
Accessory Structures	21-06.02(f)(1)
Mechanical/HVAC	21-06.02(f)(14)
Satellite Dish Antennas	21-06.02(f)(22)
Trash/Recycling Container	21-06.02(f)(27)
Allowed Location in Established Yards	
Accessory structures shall not be located in any established front or corner yard and shall comply with all required setbacks.	
Mechanical equipment and HVAC shall be allowed in front or corner yard if screened per Section 21-06.02(f)(14) .	
See Section 21-06.02 for full accessory use regulations.	
Fence/Freestanding Walls	Front Corner Side Rear
Height (max.)	3' 3' 8' 8'
A fence up to 4' is allowed in an established front or corner yard if fence is greater than 50% open.	
See Section 21-09 for full site development requirements.	

 Accessory Structures Allowed

Landscape

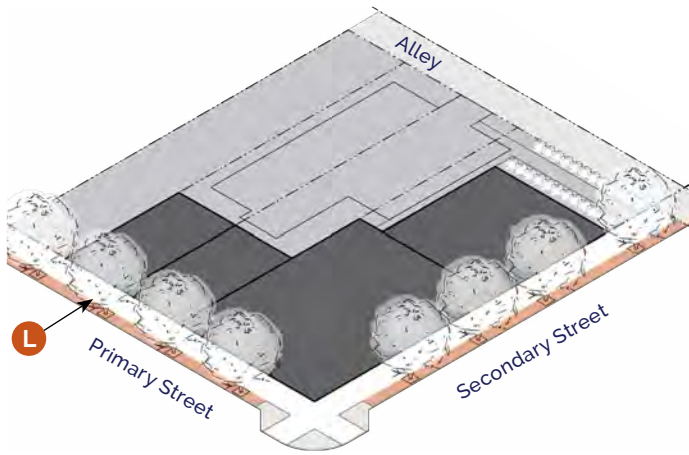

Street Trees Allowed

(j) Landscape

Streetscape Trees Required

Shade Tree ¹	1 tree min. per each full 30' of street frontage	L
Location ²	Tree lawn or tree grates along curb line	
Spacing	Evenly spaced to extent possible	

Buffer Landscape Required ³

Adjacent to S1, S2, U1, or U2	Type 3 buffer if no street or alley present
-------------------------------	---

Parking Lot Screening (of 4 or more spaces)

Parking that is visible from a street/open space, other than an alley, shall be screened by a Type 1 buffer.

Parking that is visible from a side/rear lot line abutting a S1, U1, or U2 district shall be screened by a Type 1 or 2 buffer.

Buffers shall comply with [Section 21-09.01\(o\)](#).

See [Section 21-09.01](#) for full landscape requirements.

¹ An existing tree of at least 1.75" caliper may fulfill this requirement.

² If a tree cannot be placed in a tree lawn, an alternate location may be approved by the Zoning Administrator.

³ Residential buildings with 4 or fewer units are exempt from buffer landscape requirements.

Signs

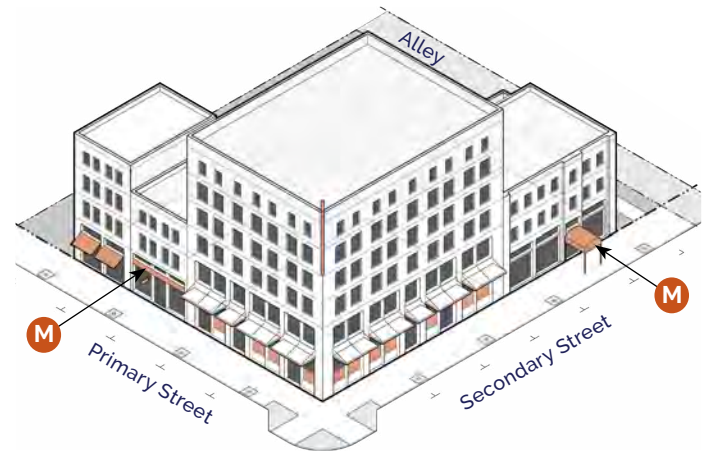

(k) Signs

Total Signs Allowed

Residential: 4 or fewer dwellings	
Building Sign	1 per street frontage; up to 2 square feet and 4 feet in height
Residential: 5+ dwelling units	
Building Sign	Up to 10% of the total area of the building facade
Non-Residential Use	
Building Sign	Up to 10% of the total area of the building facade

See [Section 21-10](#) for full sign requirements including changeable copy signs, temporary signs, exempt signs, off-premise, and use-specific signs.