

4/18/02

9320-02

## Street Vacated

- ① Schulman Dr. (Davis)<sup>formerly</sup>  
Olive to Grant
- ② Grant  
sample to I.N.R.C.



# Office of the City Clerk

Loretta J. Duda, City Clerk

JUNE 21, 2002

## MEMORANDUM

TO: Area Plan Commission  
Board of Public Works ✓  
Building Department  
Division of Engineering  
Fire Department  
Northern Indiana Public Service Company  
Police Department  
Street Department  
Bureau of Traffic & Lighting - Mark  
Community & Economic Development  
County Auditor - Melinda  
Ed Herman - Water Works - North Station

FROM: Loretta J. Duda, City Clerk

All proceedings with reference to Ordinance No. 9320-02 for the vacation of the following property:

THE FIRST STREET TO BE VACATED IS SCHULMAN DRIVE (FORMERLY DAVIS DRIVE) FROM OLIVE STREET TO GRANT STREET FOR A DISTANCE OF 1,067.6 FEET AND A WIDTH OF 60 FEET. THE SECOND STREET TO BE VACATED IS GRANT STREET FROM SAMPLE STREET TO THE NORTH LINE OF THE INDIANA NORTHERN RAILWAY COMPANY RIGHT OF WAY

are closed and this area is vacated.

cc: Larry Magliozzi  
South Bend Community School Corporation  
Northern Indiana Public Service Company

APR 18 2002  
BOPW



# Office of the City Clerk

Loretta J. Duda, City Clerk

JUNE 21, 2002

## MEMORANDUM

TO: Area Plan Commission  
Board of Public Works  
Building Department  
Division of Engineering  
Fire Department  
Northern Indiana Public Service Company  
Police Department  
Street Department  
Bureau of Traffic & Lighting - Mark  
Community & Economic Development  
County Auditor - Melinda  
Ed Herman - Water Works - North Station

FROM: Loretta J. Duda, City Clerk

All proceedings with reference to Ordinance No. 9320-02 for the vacation of the following property:

THE FIRST STREET TO BE VACATED IS SCHULMAN DRIVE (FORMERLY DAVIS DRIVE) FROM OLIVE STREET TO GRANT STREET FOR A DISTANCE OF 1,067.6 FEET AND A WIDTH OF 60 FEET. THE SECOND STREET TO BE VACATED IS GRANT STREET FROM SAMPLE STREET TO THE NORTH LINE OF THE INDIANA NORTHERN RAILWAY COMPANY RIGHT OF WAY

are closed and this area is vacated.

cc: Larry Magliozzi  
South Bend Community School Corporation  
Northern Indiana Public Service Company

Apr 11 4/18/02 BOPW

1316 COUNTY-CITY BUILDING  
227 W. JEFFERSON BOULEVARD  
SOUTH BEND, INDIANA 46601-1830



PHONE 219/235-9251  
FAX 219/235-9171  
TDD 219/235-5567

CITY OF SOUTH BEND STEPHEN J. LUECKE, MAYOR  
**DEPARTMENT OF PUBLIC WORKS**

GARY A. GILOT, P.E.  
DIRECTOR OF PUBLIC WORKS

April 18, 2002

Members of the Common Council  
Council Chambers  
County-City Building, 4th Floor  
South Bend, Indiana 46601

RE: Street Vacation

Dear Members of the Council:

In accordance with Municipal Code Section 18-53.8, a favorable recommendation is being submitted to the Common Council concerning a street vacation on the following:

The first street to be vacated is Schulman Drive (formerly Davis Drive) from Olive Street to Grant Street for a distance of 1,067.6 feet and a width of 60 feet. The second street to be vacated is Grant Street from sample Street to the north line of the Indiana Northern Railway Company right of way.

The property is being assembled for the TJX Distribution Center. Access agreements are in place to protect the interests of lease tenants who will move by Spring of 2003. In this case we are vacating the utility easements as well to make room for the Phase II building and related site development. All utilities have been notified and there have been numerous coordinating meetings. **Therefore, the Board submits to you a favorable recommendation concerning this vacation.**

Sincerely,

Gary A. Gilot, P.E.  
Director of Public Works

Attachments

c: Rosemary Mandrici, Assessor's Office  
Melinda Stopczynski, Auditor's Office

ENGINEERING  
CARL LITRELL, P.E.  
219/235-9251  
FAX 219/235-9171

ENVIRONMENTAL SERVICES  
JOHN J. DILLON, PH.D.  
219/277-8515  
FAX 219/277-8980

CENTRAL SERVICES  
MATT CHLEBOWSKI  
219/235-9316  
FAX 219/235-9007

STREETS  
SAM HENSLEY  
219/235-9244  
FAX 219/235-9272

WATER WORKS  
JOHN F. STANCATI  
219/235-9322  
FAX 219/235-9728

BPW

1316 COUNTY-CITY BUILDING  
SOUTH BEND, INDIANA 46601-1830

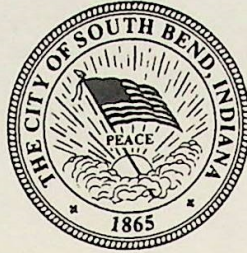

PHONE 219/235-9251  
FAX 219/235-9171  
TDD 219/235-5567

CITY OF SOUTH BEND STEPHEN J. LUECKE, MAYOR  
**BOARD OF PUBLIC WORKS**

April 18, 2002

Members of the Common Council  
Council Chambers  
County-City Building, 4th Floor  
South Bend, Indiana 46601

RE: Street Vacation

Dear Members of the Council:

In accordance with Municipal Code Section 18-53.8, an unfavorable recommendation is being submitted to the Common Council concerning an alley vacation on the following:

Schulman Drive (formerly Daves Drive) from Olive Street to Grant Street for a distance of 1,067.6 feet and a width of 60 feet. The second street to be vacated is Grant Street from sample Street to the north line of the Indiana Northern Railway Company right of way.

**Therefore, the Board submits to you a favorable recommendation concerning this vacation, subject to any utility easements that may be necessary.**

Sincerely,

*Angela N. Jacob*  
Angela N. Jacob, Clerk

Attachments

c: Rosemary Mandrici, Assessor's Office  
Melinda Stopczynski, Auditor's Office

APR 18 2002

*George H. H. H. H.*  
*Cal. P. H. H. H.*

ORDINANCE NO. \_\_\_\_\_

AN ORDINANCE TO VACATE THE FOLLOWING DESCRIBED PROPERTY:

The first street to be vacated is Schulman Drive (formerly Daves Drive) from Olive Street to Grant Street for a distance of 1,067.6 feet and a width of 60 feet. The second street to be vacated is Grant Street from Sample Street to the North line of the Indiana Northern Railway Company right of way.

STATEMENT OF PURPOSE AND INTENT

Pursuant to Indiana Code Section 36-7-3-12, the Common Council is charged with the authority to hear all petitions to vacate public ways or public places within the City.

The following Ordinance vacates the above described public property.

NOW, THEREFORE, BE IT ORDAINED BY THE COMMON COUNCIL OF THE CITY OF SOUTH BEND, INDIANA, as follows:

SECTION I. The Common Council of the City of South Bend having held a public hearing on the petition to vacate the following property:

Legal Description:

The first street to be vacated is Schulman Drive (formerly Davis Drive) from Olive Street to Grant Street for a distance of 1,067.6 feet and a width of 60 feet and being more particularly described as a part of the Northeast Quarter of Section 15, Township 37 North, Range 2 East, Portage Township, City of South Bend, Joseph County, Indiana, and described as follows:

Commencing at North Quarter Corner of Section 15, Township 37 North, Range 2 East, said point also being on the centerline of Olive Street; thence South along said centerline of Olive Street, 1,326 feet; thence East 30 feet to the East right of way line of Olive Street and the North right of way line of Schulman Drive (formerly Davis Drive), and the place of beginning; thence continuing East along said North line of Schulman Drive 1,067.6 feet to the West right of way line of Grant Street; thence South 60 feet to the South right of way line of Schulman Drive; thence West along said South line of Schulman Drive, 1,065.15 feet to the East right of way line of Olive Street; thence North 60 feet to the place of beginning.

The second street to be vacated is Grant Street from Sample Street to the North line of the Indiana Northern Railway Company right of way and being more particularly described as a part of the Northeast Quarter of Section 15, Township 37 North, Range 2 East, Portage Township, City of South Bend, Joseph County, Indiana, and described as follows:

Commencing at North Quarter Corner of Section of Section 15, Township 37 North, Range 2 East, said point also being on the centerline of Sample Street; thence East along said

centerline of Sample Street (said line also being the North line of Said Section 15), 1,090 feet; thence South 16.5 feet to the intersection of the South right of way line of Sample Street and the West right of way line of Grant Street; thence continuing South along said West line of Grant Street, 50 feet to the place of beginning; thence continuing South along the West right of way line of Grant Street, 1,259.9 feet to the North right of way line of Schulman Drive (formerly Davis Drive); thence continuing South along a curve to the left with a radius of 1729.52 feet and a length of 349.86 feet to the point of reverse curve; thence along a curve to the right with a radius of 1535.66 feet and a length of 327.44 feet to the North line of said Indiana Northern Railway Company right of way; thence East along said North line of railroad right of way, 80 feet to the East right of way line of said Grant Street; thence North along a curve to the left with a radius of 1615.66 feet and a length of 344.50 feet to a point of reverse curve to the right; thence along said curve to the right with a radius of 1649.52 feet and a length of 333.68 feet; thence continuing North along the East right of way line of Grant Street, 1,338.29 feet to the South right of way line of Sample Street; thence West 80 feet to the place of beginning.

hereby determines that it is desirable to vacate said property.

SECTION II. The City of South Bend hereby reserves the rights and easements of all utilities and the Municipal City of South Bend, Indiana, to construct and maintain any facilities, including, but not limited to, the following: electric, telephone, gas, water, sewer, surface water control structures and ditches, within the vacated right-of-way, unless such rights are released by the individual utilities.

SECTION III. The following properties may be injuriously or beneficially affected by such vacating:

ST. JOSEPH COUNTY, INDIANA PARCEL TAX KEY NUMBERS:

Parcel # 1: Tax Key No. 18-8075-2841.23  
 Parcel # 2: Tax Key No. 18-8075-2841.21  
 Parcel # 3: Tax Key No. 18-8075-2841.22  
 Parcel # 4: Tax Key No. 18-8075-2841.07  
 Parcel # 5: Tax Key No. 18-8075-2841.08  
 Parcel # 6: Tax Key No. 18-8075-2841.17  
 Parcel # 7: Tax Key No. 18-8075-2841.18  
 Parcel # 8: Tax Key No. 18-8075-2841.24  
 Parcel # 9: Tax Key No. 18-8075-2841.25  
 Parcel # 10: Tax Key No. 18-8075-2841.16  
 Parcel # 11: Tax Key No. 18-8075-2841.05  
 Parcel # 12: Tax Key No. 18-8075-2841.15  
 Parcel # 13: Tax Key No. 18-8075-2841  
 Parcel # 14: Tax Key No. 18-8075-2841.30

SECTION IV. The purpose of the vacation of the real property is to allow for the construction of a large industrial facility to be built on the reconfigured parcels of ground and vacated right-of-ways.

SECTION V. This ordinance shall be in full force and effect from and after its passage by the Common Council and approval by the Mayor.

---

Member of the Common Council

Filed in Clerk's Office  
APR 02 2002  
LORITA L. DICK  
CITY CLERK, NO. BEND, IN



PETITION TO VACATE PUBLIC RIGHTS-OF-WAY  
(STREETS/ALLEYS)

TO THE COMMON COUNCIL  
OF THE CITY OF SOUTH BEND, INDIANA

DATE: March 26, 2002

I (WE), THE UNDERSIGNED PROPERTY OWNER(S), PETITION YOU TO VACATE:

A. THE STREETS ARE DESCRIBED AS:

The first street to be vacated is Schulman Drive (formerly Daves Drive) from Olive Street to Grant Street for a distance of 1,067.6 feet and a width of 60 feet. The second street to be vacated is Grant Street from Sample Street to the North line of the Indiana Northern Railway Company right of way.

<u>NAME (signed &amp; printed)</u>	<u>ADDRESS</u>	<u>PARCEL TAX KEY NO.</u>
<u>Board of Commissioners</u>	7 <sup>th</sup> Floor County-City Bldg. South Bend, Indiana 46601	18-8075-2841.23
<u>L. &amp; H. Leasing Corp.</u>	1200 South Olive Street South Bend, Indiana 46619	18-8075-2841.21 18-8075-2841.22 18-8075-2841.07 18-8075-2841.08 18-8075-2841.17 18-8075-2841.18 18-8075-2841.24 18-8075-2841.25
<u>American Electric Power</u>	2929 Lathrop Drive South Bend, Indiana 46628	18-8075-2841.16 18-8075-2841.15
<u>Raitt Corporation</u> <i>Robert E. Dumbay V.P.</i>	815 West Sample Street South Bend, Indiana 46601	18-8075-2841 18-8075-2841.30

New Jersey, Indiana, Illinois  
Railroad Company

18-8075-2841.05  
110 Franklin Road, S.E.  
Roanoke, VA 24042

RETURN TO:  
OFFICE OF THE CITY CLERK  
LORETTA J. DUDA, CITY CLERK  
ROOM 455-COUNTY-CITY BUILDING  
SOUTH BEND, IN 46601  
574-235-9221

CONTACT PERSON (S)  
NAME:  
Michael J. Danch  
Danch, Harner & Associates, Inc.  
2422 Viridian Drive, Suite 201  
South Bend, Indiana 46628  
(574) 234-4003

Filed in Clerk's Office  
APR 0 2 2002  
LORETTA J. DUDA  
CITY CLERK, SO. BEND, IN.

PROPERTY OWNERS WITHIN 150 FEET OF VACATION PETITION PROPERTY:

1. Board of Commissioners  
7<sup>th</sup> Floor County-City Bldg.  
South Bend, Indiana 46601  
Tax Key No. 18-8075-2841.23
2. L. & H. Leasing Corporation  
1200 Olive Street  
South Bend, Indiana 46619  
Tax Key No. 18-8075-2841.25      Tax Key No. 18-8075-2841.21  
Tax Key No. 18-8075-2841.22      Tax Key No. 18-8075-2841.07  
Tax Key No. 18-8075-2841.08      Tax Key No. 18-8075-2841.17  
Tax Key No. 18-8075-2841.18      Tax Key No. 18-8075-2841.24  
Tax Key No. 18-8075-2841.25
3. American Electric Power Company  
2929 Lathrop Drive  
South Bend, Indiana 46628  
Tax Key No. 18-8075-2841.16  
Tax Key No. 18-8075-2841.15
4. Raitt Corporation  
815 West Sample Street  
South Bend, Indiana 46601  
Tax Key No. 18-8075-2841  
Tax Key No. 18-8075-2841.30
5. Betty J. Young  
2021 West Sample Street  
South Bend, Indiana 46619  
Tax Key No. 18-4004-0145
6. Martha Kruszewski  
2017 West Sample Street  
South Bend, Indiana 46619  
Tax Key No. 18-4004-0144
7. John & Leona Fleming  
2013 West Sample Street  
South Bend, Indiana 46619  
Tax Key No. 18-4004-0143
8. Robert Campbell  
2009 West Sample Street  
South Bend, Indiana 46619  
Tax Key No. 18-4004-0142

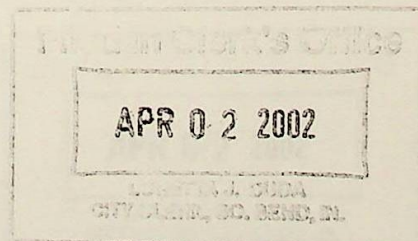

- 9. Andrew Yoder  
434-B Silverwood  
Goshen, Indiana 46526  
Tax Key No. 18-4004-0141
- 10. Jack & Joan Rader  
2001 West Sample Street  
South Bend, Indiana 46619  
Tax Key No. 18-4004-0140
- 11. Richard & Dolly Martinczak  
57177 Pine Wood Drive  
South Bend, Indiana 46619  
Tax Key No. 18-4004-0136
- 12. Barbara Summers & Szymanski  
1923 West Sample Street  
South Bend, Indiana 46619  
Tax Key No. 18-4004-0134
- 13. Christine Lehman  
1913 West Sample Street  
South Bend, Indiana 46619  
Tax Key No. 18-4004-0133
- 14. New Jersey, Indiana & Illinois Railroad Company  
110 Franklin, S.E.  
Roanoke, VA 24042  
Tax Key No. 18-8075-2841.05
- 15. Conway Central Express, Inc.  
1530 South Olive Street  
South Bend, Indiana 46619  
Tax Key No. 18-8075-2841.02
- 16. Steel Ware House, Inc.  
5100 Grant Street  
South Bend, Indiana 46624  
Tax Key No. 18-8075-2841.14
- 17. Raitt Corporation  
815 West Sample Street  
South Bend, Indiana 46601  
Tax Key No. 18-8075-2846.01
- 18. Municipal City of South Bend  
1400 County-City Building  
South Bend, Indiana 46601  
Tax Key No. 18-8075-2838

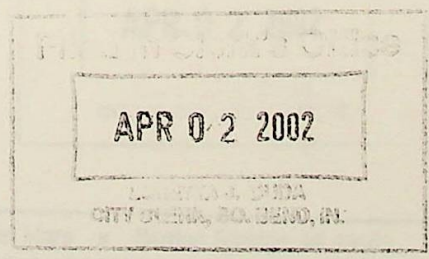



# Danch, Harner & Associates, Inc.

MICHAEL J. DANCH, L.A.  
RON HARNER, P.S.  
DANIEL W. AKIN, P.E., L.S.

Land Surveyors ■ Professional Engineers  
Landscape Architects ■ Land Planners

Honorable Members of the City of  
South Bend Common Council  
4<sup>th</sup> Floor County-City Building  
South Bend, Indiana 46601

April 2, 2002

RE: Street Vacation Petition for Riatt Corporation et. al for  
Grant Street and Schulman Drive located south of Sample Street, East of  
Olive Street and North of the Indiana Northern Railroad  
property, South Bend, Indiana:

Dear Council Members:

Our clients, Riatt Corporation et.al, are requesting the approval of the Vacation of a portion of Grant Street and Schulman Drive located South of Sample Street and East of Olive Street, South Bend, Indiana. This request is to allow for the reconfiguration of the existing parcels of ground in this area to be platted into three legal lots of record and two outlots. The largest lot will be for a proposed Distribution Center. The owners believe that the requested vacation and proposed use will be compatible with the other mixed uses in this neighborhood.

If you have any questions concerning this matter, please feel free to give me a call at 234-4003.

Sincerely,

Michael J. Danch  
President  
Danch, Harner & Associates, Inc.

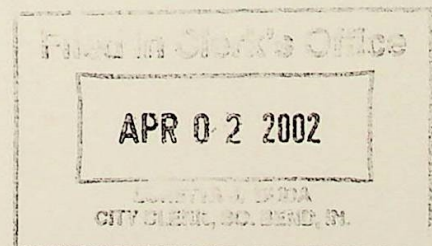



# Danch, Harner & Associates, Inc.

MICHAEL J. DANCH, L.A.  
RON HARNER, P.S.  
DANIEL W. AKIN, P.E., L.S.

Land Surveyors ■ Professional Engineers  
Landscape Architects ■ Land Planners

Honorable Members of the City of  
South Bend Common Council  
4<sup>th</sup> Floor County-City Building  
South Bend, Indiana 46601

April 2, 2002

RE: Street Vacation Petition for Riatt Corporation et. al for  
Grant Street and Schulman Drive located south of Sample Street, East of  
Olive Street and North of the Indiana Northern Railroad  
property, South Bend, Indiana:

Dear Council Members:

Our clients, Riatt Corporation et.al, are requesting the approval of the Vacation of a portion of Grant Street and Schulman Drive located South of Sample Street and East of Olive Street, South Bend, Indiana. This request is to allow for the reconfiguration of the existing parcels of ground in this area to be platted into three legal lots of record and two outlots. The largest lot will be for a proposed Distribution Center. The owners believe that the requested vacation and proposed use will be compatible with the other mixed uses in this neighborhood.

If you have any questions concerning this matter, please feel free to give me a call at 234-4003.

Sincerely,

Michael J. Danch  
President  
Danch, Harner & Associates, Inc.

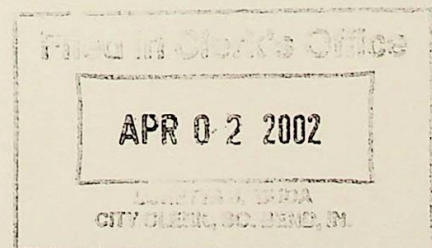

**INTER-OFFICE MEMORANDUM  
BOARD OF PUBLIC WORKS**

**TO:** -Tony Molnar, Engineering Department  
- Carl Littrell, Engineering Department  
- John Byorni, Area Plan Commission  
- Larry Magliozzi, Department of Economic Development  
- Chief Howard Buchanan, Fire Department  
- Jack Dillon, Solid Waste  
- Joe Markovich, Police Traffic Department  
- Tom Bodnar, City Attorney's Office

**FROM:** Angie Jacob, Clerk

**RE:** Alley Vacation

**DATE:** April 3, 2002

Attached for your review and recommendation is the following alley vacation:

Schulman Drive (Formerly Daves Drive ) From Olive Street to Grant Street for a distance of 1,067.6 feet and a width of 60 feet. The second street to be vacated is Grant Street from sample Street to the north line of the Indiana Northern Railway Company right of way.

I would appreciate receiving your comments and recommendation concerning this vacation no later than April 17, 2002. Thank you for your cooperation.

**COMMENTS & RECOMMENDATIONS:**

SCHULMAN DRIVE WAS FORMERLY DAVIS DRIVE

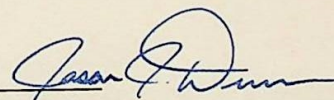

BY: \_\_\_\_\_ DATE: \_\_\_\_\_

APR - 5 2002

**INTER-OFFICE MEMORANDUM  
BOARD OF PUBLIC WORKS**

**TO:** -Tony Molnar, Engineering Department  
- Carl Littrell, Engineering Department  
- John Byorni, Area Plan Commission  
- Larry Magliozzi, Department of Economic Development  
- Chief Howard Buchanan, Fire Department  
- Jack Dillon, Solid Waste  
- Joe Markovich, Police Traffic Department  
- Tom Bodnar, City Attorney's Office

**FROM:** Angie Jacob, Clerk

**RE:** Alley Vacation

**DATE:** April 3, 2002

Attached for your review and recommendation is the following alley vacation:

Schulman Drive (Formerly Daves Drive ) From Olive Street to Grant Street for a distance of 1,067.6 feet and a width of 60 feet. The second street to be vacated is Grant Street from sample Street to the north line of the Indiana Northern Railway Company right of way.

I would appreciate receiving your comments and recommendation concerning this vacation no later than April 17, 2002. Thank you for your cooperation.

COMMENTS & RECOMMENDATIONS:

\_\_\_\_\_ *OK* \_\_\_\_\_  
\_\_\_\_\_

BY: *Jack Dillon* DATE: *4-10-02*



**INTER-OFFICE MEMORANDUM  
BOARD OF PUBLIC WORKS**

**TO:** - Tony Molnar, Engineering Department  
- Carl Littrell, Engineering Department  
- John Byorni, Area Plan Commission  
- Larry Magliozzi, Department of Economic Development  
- Chief Howard Buchanan, Fire Department  
- Jack Dillon, Solid Waste  
- Joe Markovich, Police Traffic Department  
- Tom Bodnar, City Attorney's Office

**FROM:** Angie Jacob, Clerk

**RE:** Alley Vacation

**DATE:** April 3, 2002

Attached for your review and recommendation is the following alley vacation:

Schulman Drive (Formerly Daves Drive ) From Olive Street to Grant Street for a distance of 1,067.6 feet and a width of 60 feet. The second street to be vacated is Grant Street from sample Street to the north line of the Indiana Northern Railway Company right of way.

I would appreciate receiving your comments and recommendation concerning this vacation no later than April 17, 2002. Thank you for your cooperation.

COMMENTS & RECOMMENDATIONS:

*No Objections*

BY: *Capt Markovitch*

DATE: *4-10-02*

*FAxed*

# Area Plan Commission of St. Joseph County

1140 County-City Building  
227 West Jefferson Blvd.  
South Bend, Indiana 46601

Robert W. Sante  
Executive Director

John W. Byorni  
Assistant Director

Phone 574 235-9571

Fax 574 235-9813

April 11, 2002

The Board of Public Works  
13<sup>th</sup> Floor, County-City Building  
South Bend, Indiana 46601

RE: The first street to be vacated is Schulman Drive (Formerly Daves Drive) from Olive Street to Grant Street for a distance of 1,067.6 feet and a width of 60 feet. The second street to be vacated is Grant Street from Sample street to the north line of the Indiana Northern Railway Company right-of-way.

Dear Board Members:

The staff has reviewed this petition relative to IC 36-7-3-13. It is the staff's opinion that:

- (1) The vacation would not hinder the growth or orderly development of the unit or neighborhood in which it is located or to which it is contiguous.
- (2) The vacation would not make access to the lands of the aggrieved person by means of public way difficult or inconvenient.
- (3) The vacation would not hinder the public's access to a church, school, or other public building or place.
- (4) The vacation would not hinder the use of a public way by the neighborhood in which it is located or to which it is contiguous.

The Staff recommends that if these streets are vacated that it be done so subject to the creation of any cross access or utility easements that may be necessary. The Staff would also like to note that the southern portion of Grant Street is shown differently from the legal to the drawing and also that less than half of the adjacent property owners have signed the petition.

Sincerely,

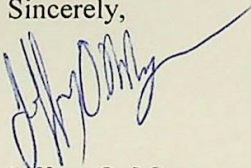

Jeffrey O. Myers  
Planner





### INTER-OFFICE MEMORANDUM BOARD OF PUBLIC WORKS

**TO:**

- Tony Molnar, Engineering Department
- Carl Littrell, Engineering Department
- John Byorni, Area Plan Commission
- Larry Magliozzi, Department of Economic Development
- Chief Howard Buchanan, Fire Department
- Jack Dillon, Solid Waste
- Joe Markovich, Police Traffic Department
- Tom Bodnar, City Attorney's Office

**FROM:** Angie Jacob, Clerk

**RE:** Alley Vacation

**DATE:** April 3, 2002

Attached for your review and recommendation is the following alley vacation:

Schulman Drive (Formerly Daves Drive ) From Olive Street to Grant Street for a distance of 1,067.6 feet and a width of 60 feet. The second street to be vacated is Grant Street from sample Street to the north line of the Indiana Northern Railway Company right of way.

I would appreciate receiving your comments and recommendation concerning this vacation no later than April 17, 2002. Thank you for your cooperation.

**COMMENTS & RECOMMENDATIONS:**

\_\_\_\_\_  
No objection Angie  
\_\_\_\_\_

BY: A/c Howard Buchanan DATE: 4/16/02

OFFICE OF THE CITY CLERK

**INTER-OFFICE MEMORANDUM  
BOARD OF PUBLIC WORKS**

**TO:** ✓ Tony Molnar, Engineering Department  
✓ Carl Littrell, Engineering Department  
✓ John Byorni, Area Plan Commission  
- Larry Magliozzi, Department of Economic Development  
✓ Chief Howard Buchanan, Fire Department  
✓ Jack Dillon, Solid Waste  
✓ Joe Markovich, Police Traffic Department  
- Tom Bodnar, City Attorney's Office

**FROM:** Angie Jacob, Clerk

**RE:** Alley Vacation

**DATE:** April 3, 2002

Attached for your review and recommendation is the following alley vacation:

Schulman Drive (Formerly Daves Drive ) From Olive Street to Grant Street for a distance of 1,067.6 feet and a width of 60 feet. The second street to be vacated is Grant Street from sample Street to the north line of the Indiana Northern Railway Company right of way.

I would appreciate receiving your comments and recommendation concerning this vacation no later than April 17, 2002. Thank you for your cooperation.

**COMMENTS & RECOMMENDATIONS:**

\_\_\_\_\_  
\_\_\_\_\_  
\_\_\_\_\_

BY: \_\_\_\_\_ DATE: \_\_\_\_\_



**LEGAL DESCRIPTION:**

The first street to be vacated is Schulman Drive (formerly Davis Drive) from Olive Street to Grant Street for a distance of 1,067.6 feet and a width of 60 feet and being more particularly described as a part of the Northeast Quarter of Section 15, Township 37 North, Range 2 East, Portage Township, City of South Bend, Joseph County, Indiana, and described as follows:

Commencing at North Quarter Corner of Section 15, Township 37 North, Range 2 East, said point also being on the centerline of Olive Street; thence South along said centerline of Olive Street, 1,326 feet; thence East 30 feet to the East right of way line of Olive Street and the North right of way line of Schulman Drive (formerly Davis Drive), and the place of beginning; thence continuing East along said North line of Schulman Drive 1,067.6 feet to the West right of way line of Grant Street; thence South 60 feet to the South right of way line of Schulman Drive; thence West along said South line of Schulman Drive, 1,065.15 feet to the East right of way line of Olive Street; thence North 60 feet to the place of beginning.

The second street to be vacated is Grant Street from Sample Street to the North line of the Indiana Northern Railway Company right of way and being more particularly described as a part of the Northeast Quarter of Section 15, Township 37 North, Range 2 East, Portage Township, City of South Bend, Joseph County, Indiana, and described as follows:

Commencing at North Quarter Corner of Section of Section 15, Township 37 North, Range 2 East, said point also being on the centerline of Sample Street; thence East along said centerline of Sample Street (said line also being the North line of Said Section 15), 1,090 feet; thence South 16.5 feet to the intersection of the South right of way line of Sample Street and the West right of way line of Grant Street; thence continuing South along said West line of Grant Street, 50 feet to the place of beginning; thence continuing South along the West right of way line of Grant Street, 1,259.9 feet to the North right of way line of Schulman Drive (formerly Davis Drive); thence continuing South along a curve to the left with a radius of 1729.52 feet and a length of 349.86 feet to the point of reverse curve; thence along a curve to the right with a radius of 1535.66 feet and a length of 327.44 feet to the North line of said Indiana Northern Railway Company right of way; thence East along said North line of railroad right of way, 80 feet to the East right of way line of said Grant Street; thence North along a curve to the left with a radius of 1615.66 feet and a length of 344.50 feet to a point of reverse curve to the right; thence along said curve to the right with a radius of 1649.52 feet and a length of 333.68 feet; thence continuing North along the East right of way line of Grant Street, 1,338.29 feet to the South right of way line of Sample Street; thence West 80 feet to the place of beginning.

NE OF  
NORTHERN  
COMPANY

APR 02 2002

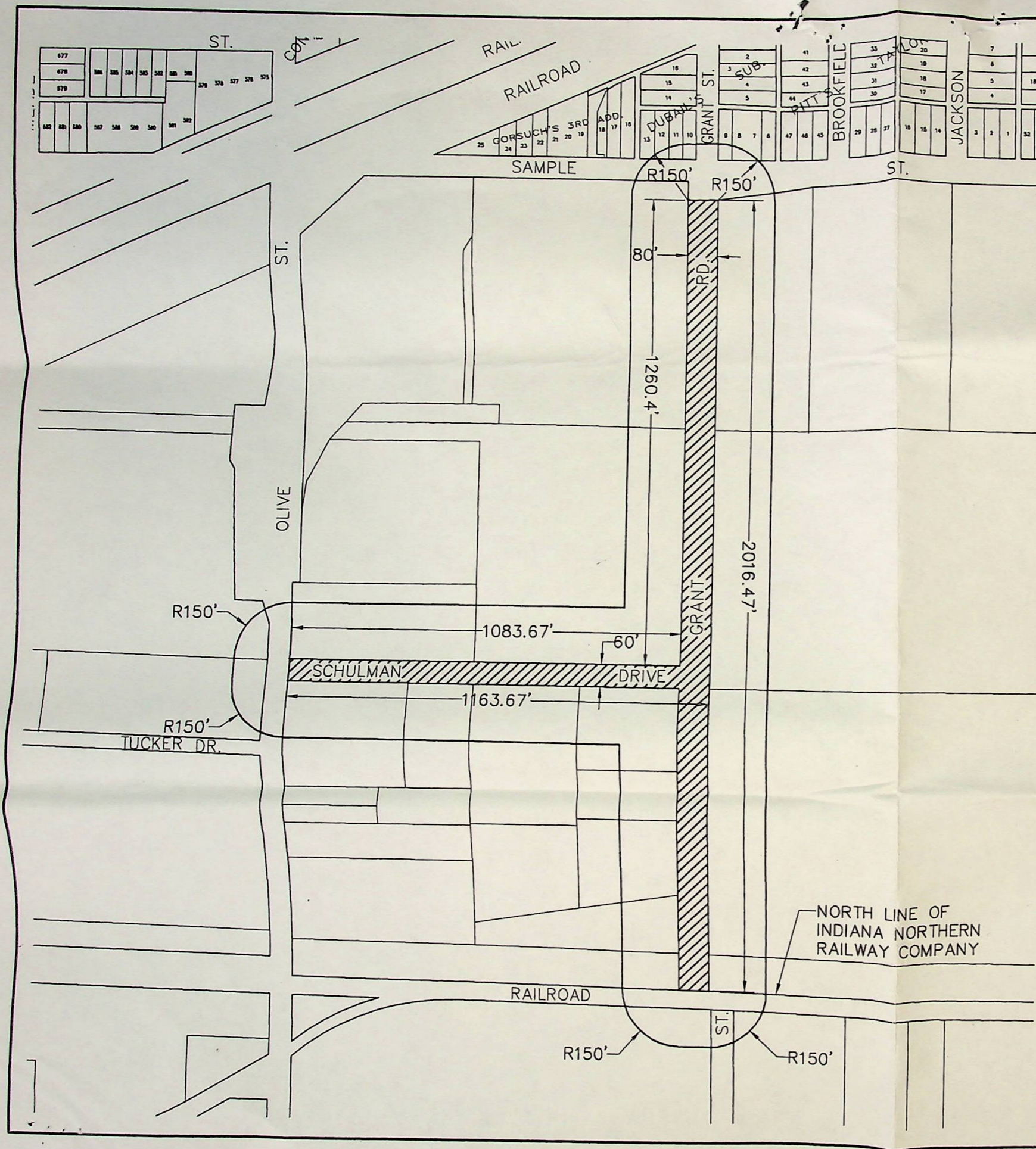

**LEGAL DESCRIPTION:**

The first street to be vacated is Schulman Drive (formerly Davis Drive) from Olive Street to Grant Street for a distance of 1,067.6 feet and a width of 60 feet and being more particularly described as a part of the Northeast Quarter of Section 15, Township 37 North, Range 2 East, Portage Township, City of South Bend, Joseph County, Indiana, and described as follows:

Commencing at North Quarter Corner of Section 15, Township 37 North, Range 2 East, said point also being on the centerline of Olive Street; thence South along said centerline of Olive Street, 1,326 feet; thence East 30 feet to the East right of way line of Olive Street and the North right of way line of Schulman Drive (formerly Davis Drive), and the place of beginning; thence continuing East along said North line of Schulman Drive 1,067.6 feet to the West right of way line of Grant Street; thence South 60 feet to the South right of way line of Schulman Drive; thence West along said South line of Schulman Drive, 1,065.15 feet to the East right of way line of Olive Street; thence North 60 feet to the place of beginning.

The second street to be vacated is Grant Street from Sample Street to the North line of the Indiana Northern Railway Company right of way and being more particularly described as a part of the Northeast Quarter of Section 15, Township 37 North, Range 2 East, Portage Township, City of South Bend, Joseph County, Indiana, and described as follows:

Commencing at North Quarter Corner of Section of Section 15, Township 37 North, Range 2 East, said point also being on the centerline of Sample Street; thence East along said centerline of Sample Street (said line also being the North line of Said Section 15), 1,090 feet; thence South 16.5 feet to the intersection of the South right of way line of Sample Street and the West right of way line of Grant Street; thence continuing South along said West line of Grant Street, 50 feet to the place of beginning; thence continuing South along the West right of way line of Grant Street, 1,259.9 feet to the North right of way line of Schulman Drive (formerly Davis Drive); thence continuing South along a curve to the left with a radius of 1729.52 feet and a length of 349.86 feet to the point of reverse curve; thence along a curve to the right with a radius of 1535.66 feet and a length of 327.44 feet to the North line of said Indiana Northern Railway Company right of way; thence East along said North line of railroad right of way, 80 feet to the East right of way line of said Grant Street; thence North along a curve to the left with a radius of 1615.66 feet and a length of 344.50 feet to a point of reverse curve to the right; thence along said curve to the right with a radius of 1649.52 feet and a length of 333.68 feet; thence continuing North along the East right of way line of Grant Street, 1,338.29 feet to the South right of way line of Sample Street; thence West 80 feet to the place of beginning.

APR 02 2002